

Regulator Outdoor series

RW3000/RW4000/RW8000-W Series

A series of outdoor specification products.

● Port size: 1/4 to 1

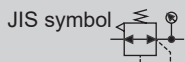

Specifications

Item	RW3000-W	RW4000-W	RW8000-W
Working fluid	Compressed air		
Max. working pressure MPa	1.0		
Proof pressure MPa	1.5		
Fluid temperature °C	-20 to 60(no freezing)		
Ambient temperature °C	-20 to 60		
Set pressure MPa	0.05 to 0.85		
Pressure relief	With relief mechanism		
Port size Rc, NPT, G	1/4, 3/8	1/4, 3/8, 1/2	3/4, 1
Weight kg	0.5	0.75	1.65

Option weight

* Add to the weight of the standard accessories. Unit: kg

Code	Knob	Attachment
	K	BW
RW3000	0.1	0.17
RW4000	0.1	0.21
RW8000	0.1	0.36

Flow characteristics

● RW3000-8-W

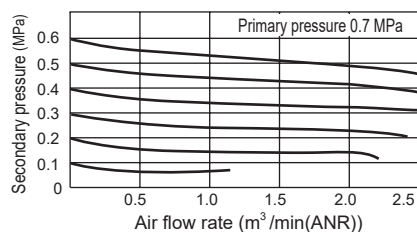

● RW3000-10-W

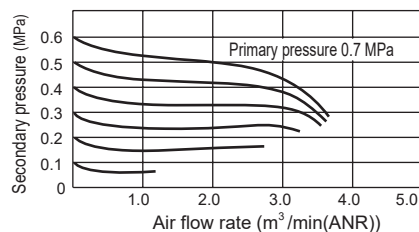

● RW4000-8-W

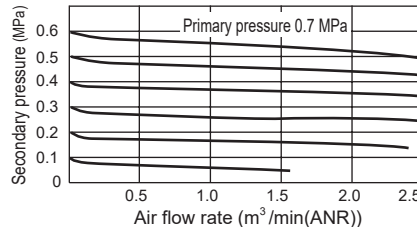

● RW4000-10-W

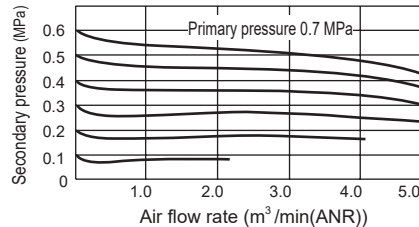

● RW4000-15-W

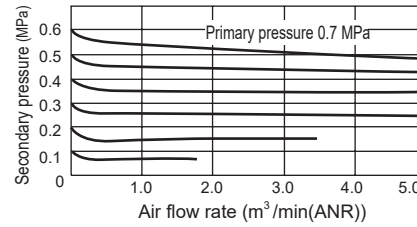

● RW8000-20-W

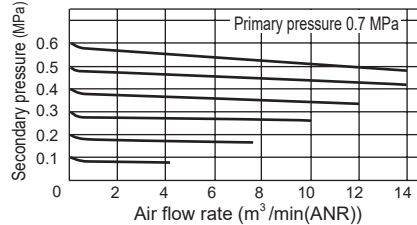

● RW8000-25-W

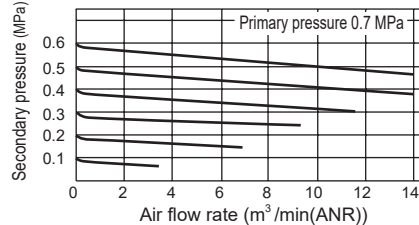

Pressure characteristics

● RW3000-W

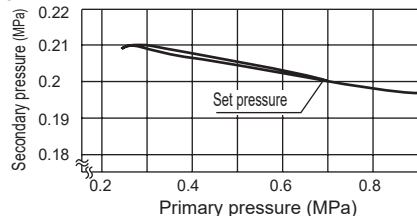

● RW4000-W

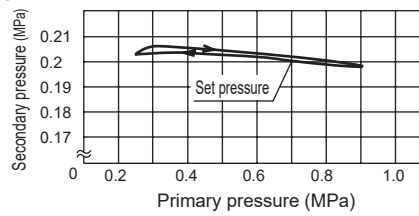

● RW8000-W

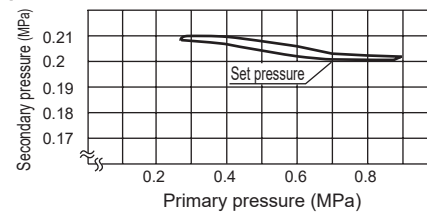

Regulator series

How to order/Internal structure diagram and parts list

How to order

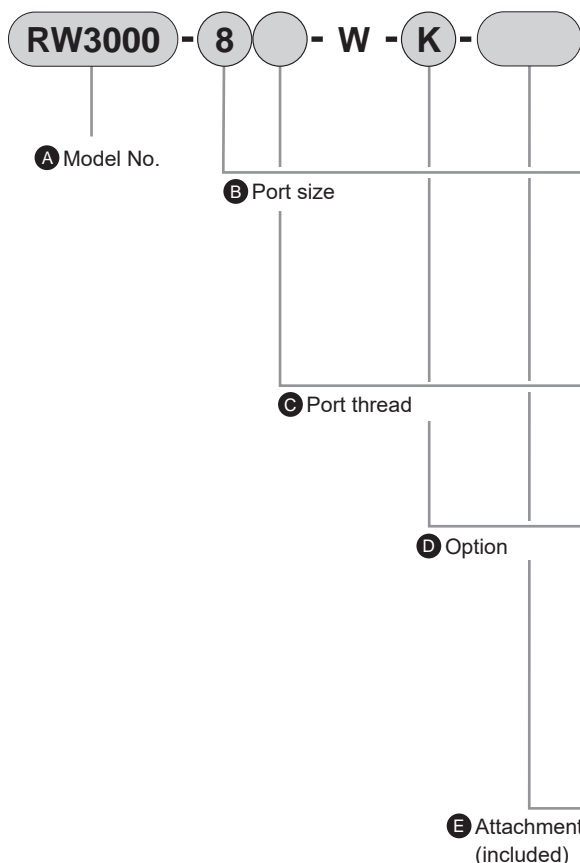

		A Model No.		
		RW3000	RW4000	RW8000
Code	Description			
B Port size				
8	1/4	●	●	
10	3/8	●	●	
15	1/2		●	
20	3/4			●
25	1			●
C Port thread				
		*1, *2		
Blank	Rc thread (pressure unit: MPa temperature display unit: °C)	●	●	●
N	NPT thread (pressure unit: psi temperature display unit: °F)	●	●	●
G	G thread (pressure unit: bar temperature display unit: °C)	●	●	●
D Option				
		*3, *4		
Knob	Blank	Without knob	●	●
	K	With knob	●	●
guarantee period	Blank	1 year after delivery	●	●
	G	3 years after delivery (with inspection certificate, inspection guidelines, traceability system diagram) *4, *5	●	●
Flow Direction	Blank	Standard flow (left → right)	●	●
	X1	Reverse flow (right → left)	●	●
E Other attachments				
Blank	Not included	●	●	●
BW	C-bracket	●	●	●
GW49P	Pressure gauge (GW49D-6-P10) *6	●	●	●

⚠ Precautions for model No. selection

- *1: G and NPT threads are available for IN, OUT and gauge ports.
- *2: In compliance with the Measurement Act, the psi display cannot be used in Japan.
- *3: Select options for the knob, warranty period and flow direction items. When selecting options for several items, list options in order from the top.
- *4: The warranty period of option G is guaranteed for a period of three years from the date of delivery or for a period of one year from the start of use, whichever comes first.
- *5: For option G, the specifications and drawings must be exchanged. Refer to page 98 for details.
- *6: The pressure gauge cannot be attached when using NPT threads or G threads. (Consult with CKD if required.)

Internal structure and parts list

● RW3000-W/RW4000-W

● RW8000-W

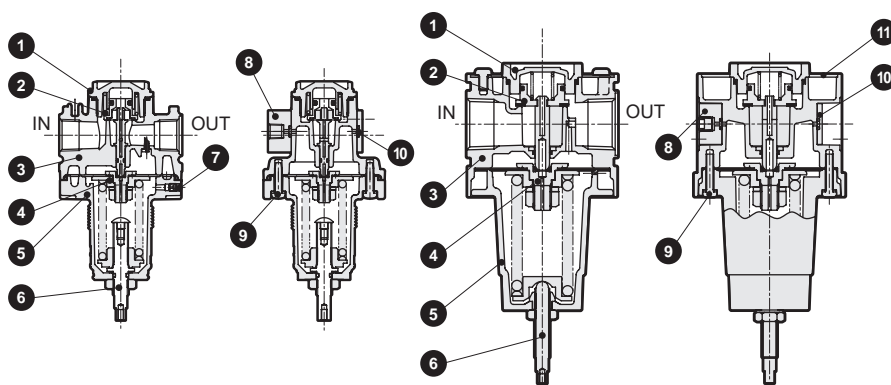

No.	Part name	Material
1	Bottom plug	Aluminum alloy die-casting
2	Valve assembly	Brass, hydrogenated nitrile rubber (polyacetal resin: RW3000 and RW4000)
3	Body	Aluminum alloy die-casting
4	Diaphragm assembly	Stainless steel, nitrile rubber, aluminum
5	Cover	Aluminum alloy die-casting
6	Adjusting screw assembly	Stainless steel (aluminum, nitrile rubber, polyacetal resin: RW3000, RW4000)
7	Plug	Stainless steel
8	Gauge plug assembly	Aluminum, nitrile rubber, stainless steel
9	Screws	Stainless steel
10	Seal plug assembly	Aluminum, nitrile rubber, stainless steel
11	Plate cover	Aluminum

Regulator Series

Dimensions

● RW3000-W

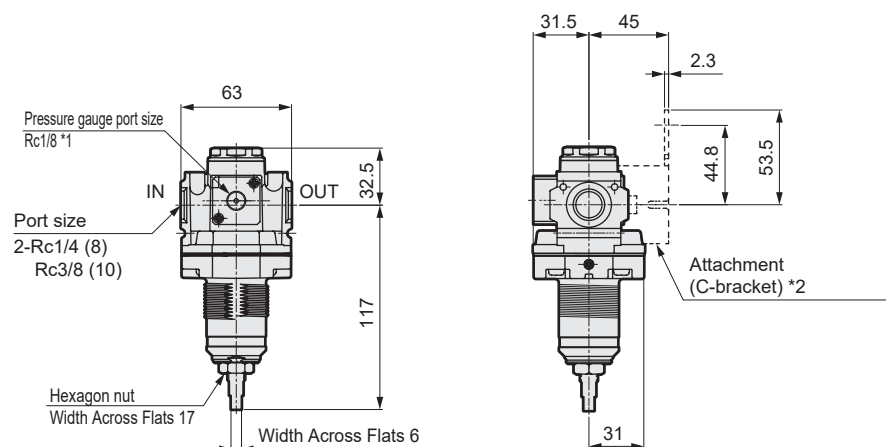

• Optional dimensions With knob (K)

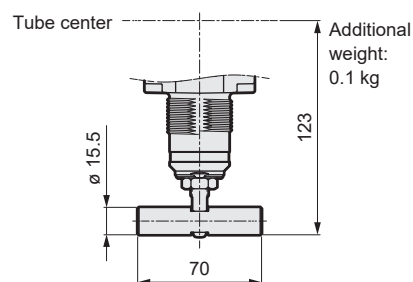

- Attachment
C-bracket (-BW)
Part model No.: B320
- Material: Steel
Zinc plated

- *1: Pressure gauge port is left open.
Use the included pipe plug when sealing.
- *2: Bracket is optionally included.
- *3: Dimensions at 0 MPa pressure setting.

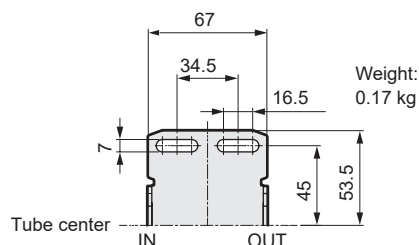

● RW4000-W

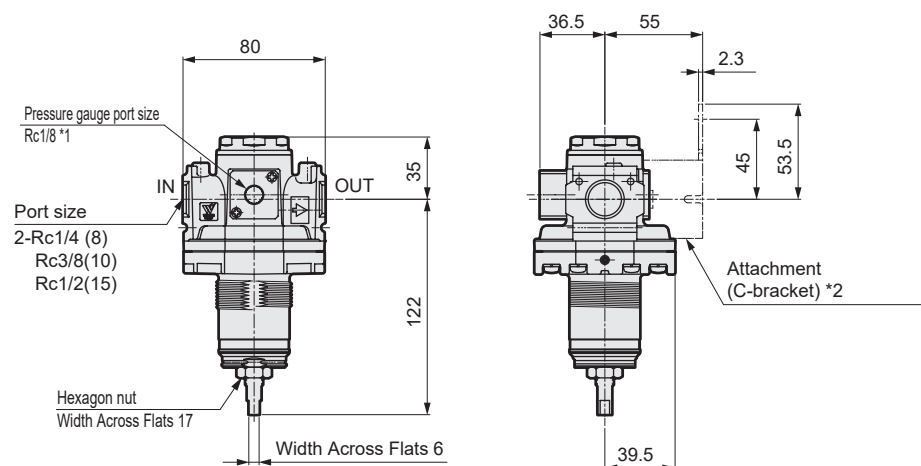

• Optional dimensions With knob (K)

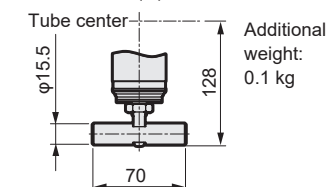

- Attachment
C-bracket (-BW)
Part model No.: B420

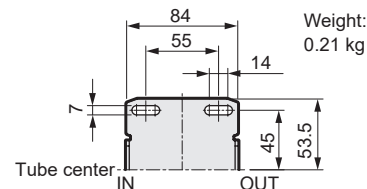

- *1: Pressure gauge port is left open.
Use the included pipe plug when sealing.
- *2: Bracket is optionally included.
- *3: Dimensions at 0 MPa pressure setting.

Dimensions

● RW8000-W

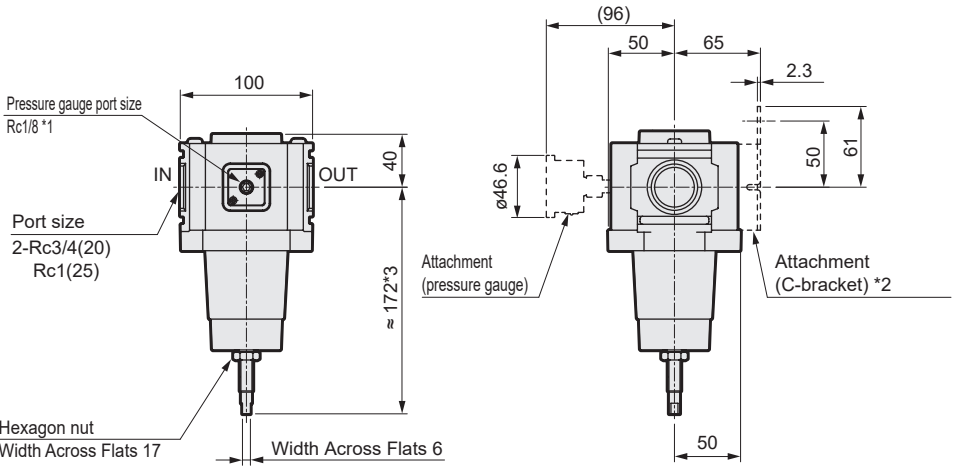

*1: The pressure gauge connection port is left open when shipped. Use the included pipe plug when sealing.
*2: Bracket is optionally included.
*3: Dimensions at 0 MPa pressure setting.

· Optional dimensions
With knob (K)

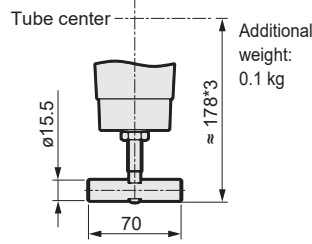

· Attachment
C-bracket (-BW)
Part model No.: B820

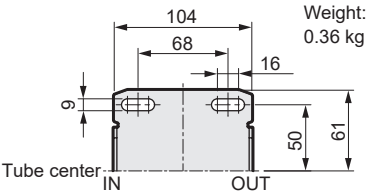

Drain separator
F.R.L. unit

Pneumatic auxiliary
components

Pneumatic
valves

Fluid control
valves

Pneumatic
cylinders

Related
products

Safety
precautions