

Compact/space saving type that aggregates multiple functions

Low pressure gas combination valve **GAV Series**

- NC (open when energized)
- City gas/natural gas/LPG
- Port size: Rp3/4, Rp1, Rp1 1/4, Rp1 1/2

Features

- Double solenoid valve and governor integrated
Improved safety and reliability due to double shut-off with a combination of solenoid valves and governor.
- Reduction of piping work-hours
Conventional discrete solenoid valve and gasSignificant reduction in piping work-hours is realized compared to the combination of banisters.

Applications

- Gas boilers
- Industrial furnaces
- Gas absorption water coolers/heaters
- Drying furnaces
- Other

Specifications

Item	GAV-20-A	GAV-25-A	GAV-32-A	GAV-40-A
Working fluid	City gas/LPG			
Working pressure kPa	0 to 5			
Secondary pressure kPa	0.5 to 1.5			
Flow rate <small>Specific gravity of city gas 0.65,△P=0.25kPa</small> m ³ /h (ANR)	10.0		28.0	
Rated voltage V	100 VAC <small>+10% -15%</small>		200 VAC <small>+10% -15%</small>	
Frequency Hz	Common to 50 and 60			
Power consumption (apparent power) VA	10 x 2		27 x 2	
Ambient temperature °C	-20 to +60 (no freezing)			
Opening time s	0.5 or less			
Closing time s	1.0 or less			
Frequency cycles/min.	30 or less			
Mounting orientation	Vertical direction with the coil up or horizontal direction with the coil horizontal			
Connection	Screw-in (Rp)			
Port size	3/4	1	1¼	1½
Weight kg	2 . 4		5.4	
Proof pressure kPa	10			
Combination	V+G+V		V+G+V	

* Flow rate is the maximum flow rate value. * V: Solenoid valve
G: Governor

How to order

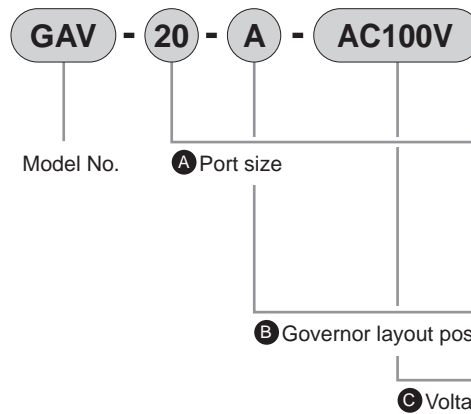

Code	Description
A Port size	
20	Rp3/4
25	Rp1
32	Rp1 1/4
40	Rp1 1/2
B Governor layout position	
A	Solenoid valve + Governor + solenoid valve
C Voltage	
AC100V	100 VAC 50/60Hz
AC200V	200 VAC 50/60 Hz

Flow characteristics (flow rate control range)

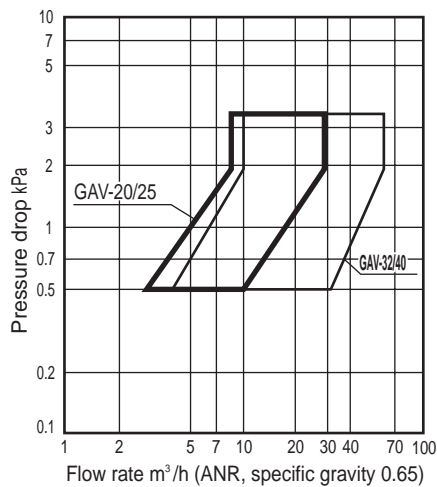

Reference: conversion factor

Converted flow rate = (flow rate in table) × (coefficient)

Gas	City gas (13A)	Propane	Butane
Specific gravity (air = 1)	0.65	1.6	2.0
Coefficient	1.0	0.63	0.57

Internal structure and parts list

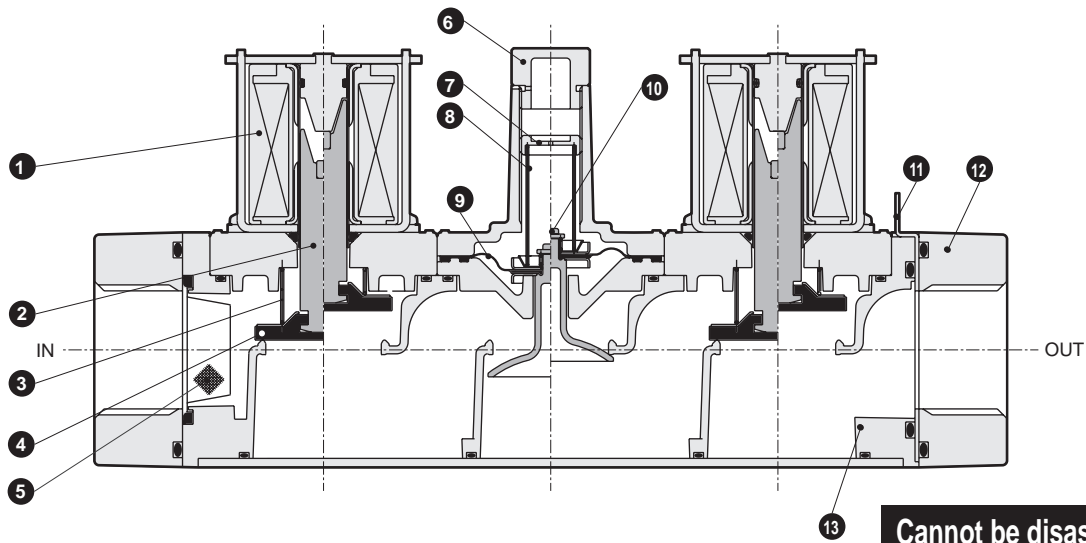

Part No.	Part name	Material	Part No.	Part name	Material
1	Coil winding	Polyester copper wire	8	Pressure adjustment bar(t)	Stainless steel wire
2	Plunger	Steel	9	Diaphragm	Nitrile rubber
3	Spring	Stainless steel wire	10	Governor valving element	Resin
4	Valve disc	Nitrile rubber	11	Orifice plate	Brass plate
5	Strainer	Stainless steel	12	Flange	Aluminum die-casting
6	Cap	Resin	13	Body	Aluminum die-casting
7	Pressure adjustment screw	Resin			

Dimensions

● GAV-20 to 40

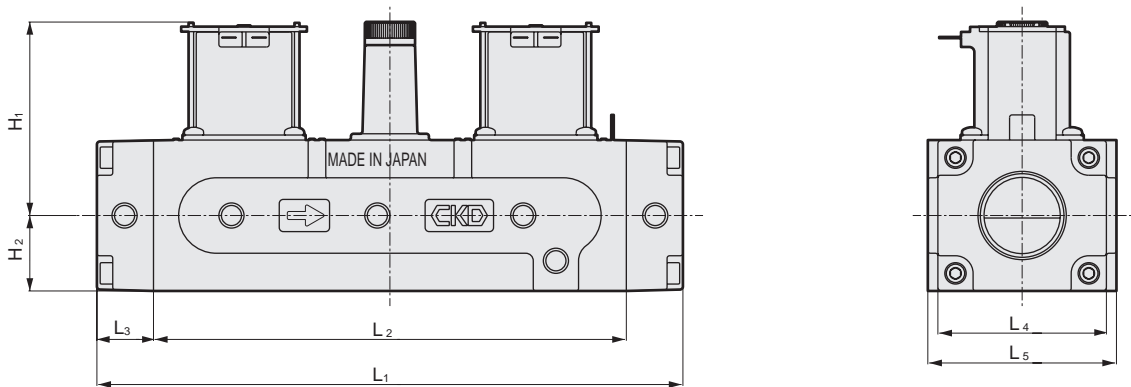

Code Model No.	Port size	H ₁	H ₂	L ₁	L ₂	L ₃	L ₄	L ₅
GAV-20-A	3/4	77	30	233	188	22.5	67	75
GAV-25-A	1	77	30	233	188	22.5	67	75
GAV-32-A	1¼	124	40	316	262	27	104	120
GAV-40-A	1½	124	40	316	262	27	104	120

EXA
FWD
HNB/G
USB/G
FAB/G
FGB/G
FVB
FWB/G
FHB
FLB
AB
AG
AP/
AD
APK/
ADK
DryAir
EX-
XPLNprf
XPLNprf
HVB/
HVL
S B/
NAB
LAD/
NAD
Water-
Rela
NP/NAP/
NVP
SNP
CHB/G
MXB/G
Other valves
SWD/
MWD
DustColl
CVE/
CVSE
CCH/
CPE/D
LifeSci
Gas-
Combus
Auto-
Water
Outdoor
SpecFld
Custom
Ending