

### How to connect terminal box

#### DIN terminal box (Pg9), DIN terminal box with lamp (Pg9)

- (1) Use the following cabtyre cable.
  - Cable O.D.:  $\varnothing 4.5$  to  $\varnothing 7$  · Nominal sectional area:  $0.75 \text{ mm}^2$
- (2) Put the crimp terminal for copper wire on the cabtyre cable's lead wire and crimp the terminal. The terminal box thread size is M3.
- (3) Tighten the screws with the following tightening torque.
  - Set screw tightening torque:  $0.5 \text{ N}\cdot\text{m}$
  - Terminal screw tightening torque:  $0.5 \text{ N}\cdot\text{m}$

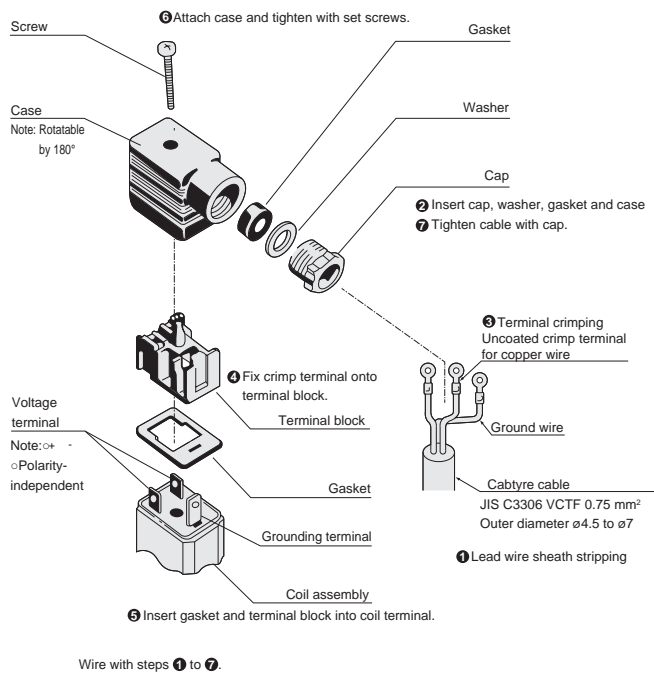

\* The orientation of the cord can be changed by removing the terminal block from the case, rotating it by  $180^\circ$ , and then replacing the block into the case.

#### DIN terminal box (Pg11), DIN terminal box with lamp (Pg11)

- (1) Use the following cabtyre cable.
  - Cable O.D.:  $\varnothing 6$  to  $\varnothing 10$  · Nominal sectional area:  $0.5$  to  $1.5 \text{ mm}^2$
- (2) Put the crimp terminal for copper wire on the cabtyre cable's lead wire and crimp the terminal. The terminal box thread size is M3.
- (3) Tighten the screws with the following tightening torque.
  - Set screw tightening torque:  $0.5 \text{ N}\cdot\text{m}$
  - Terminal screw tightening torque:  $0.5 \text{ N}\cdot\text{m}$

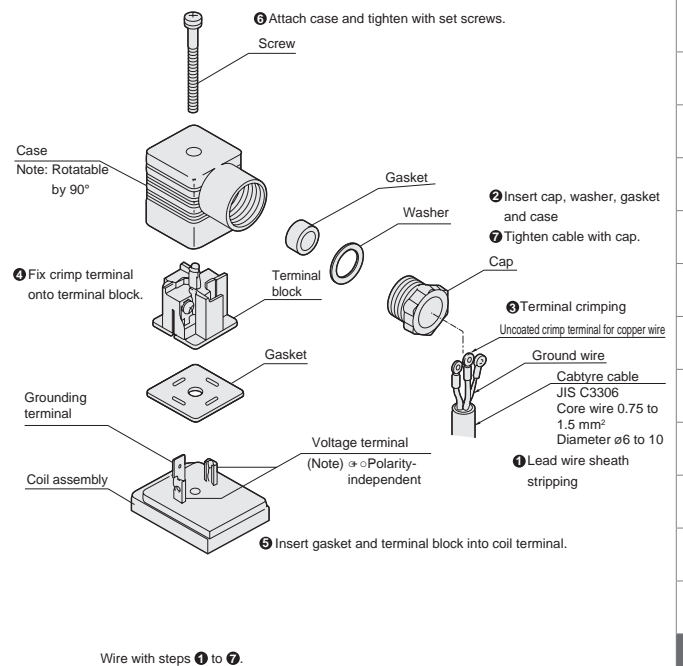

\* The orientation of the cord can be changed by removing the terminal block from the case, rotating it by  $90^\circ$ , and then replacing the block into the case.

EXA
FWD
HNB/G
USB/G
FAB/G
FGB/G
FVB
FWB/G
FHB
FLB
AB
AG
AP/AD
APK/ADK
DryAir
EX-XPLNprf
XPLNprf
HVB/HVL
S $\diamond$ B/NAB
LAD/NAD
Water-Rela
NP/NAP/NVP
SNP
CHB/G
MXB/G
Other valves
SWD/MWD
DustColl
CVE/CVSE
CCH/CPE/D
LifeSci
Gas-Combus
Auto-Water
Outdoor
SpecFld
Custom
Ending

EXA
FWD
HNB/G
USB/G
FAB/G
FGB/G
FVB
FWB/G
FHB
FLB
AB
AG
AP/ AD
APK/ ADK
DryAir
EX- XPLNprf
XPLNprf
HVB/ HVL
S ◇ B/ NAB
LAD/ NAD
Water- Rela
NP/NAP/ NVP
SNP
CHB/G
MXB/G
Other valves
SWD/ MWD
DustColl
CVE/ CVSE
CCH/ CPE/D
LifeSci
Gas- Combust
Auto- Water
Outdoor
SpecFld
Custom
Ending

## How to connect terminal box

T type terminal box (G1/2), T type terminal box with lamp (G1/2)

- (1) Use the following cabtyre cable.
  - Nominal sectional area: 0.75 mm<sup>2</sup>
- (2) Put the crimp terminal for copper wire on the cabtyre cable's lead wire and crimp the terminal. The terminal box thread size is M3.
- (3) Tighten the screws with the following tightening torque.
  - Mounting screw tightening torque: 0.5 N·m ·Terminal screw tightening torque: 0.5 N·m

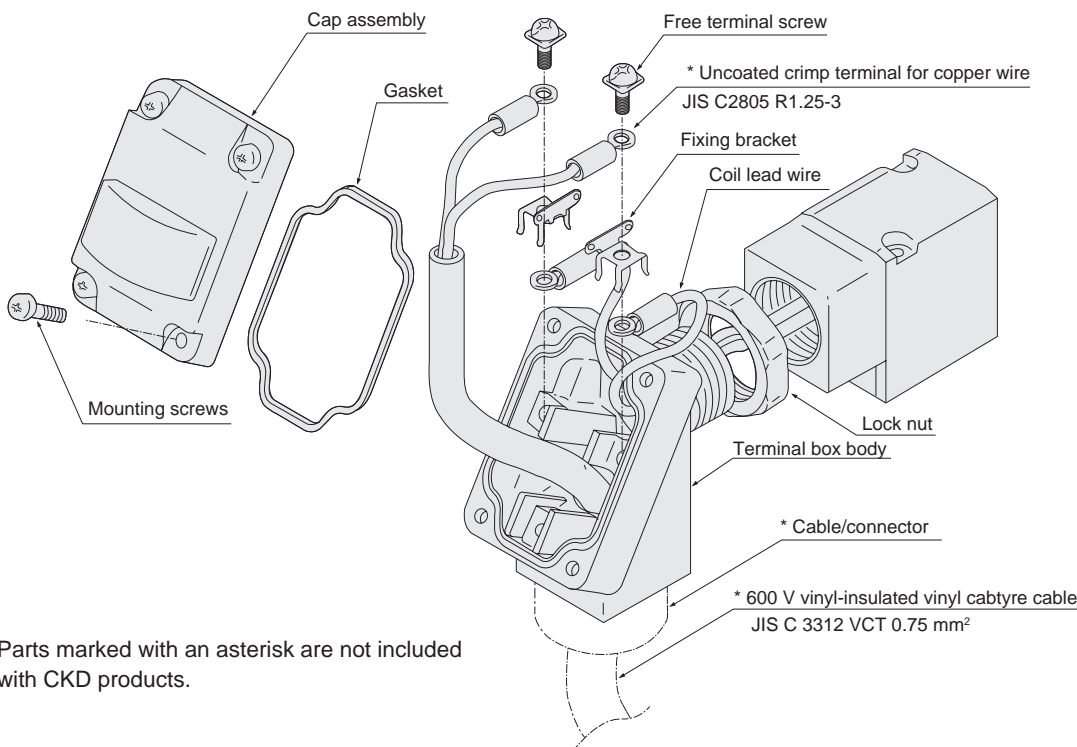

\* Changing the orientation of T type terminal box

Use the following steps to change the orientation of the T type terminal box from the default state.

- (1) Hold the width across flats (25 width) of the T type terminal box with a tool (adjustable wrench, wrench, etc.), and loosen it by turning counterclockwise.
- (2) Loosen the lock nut.
- (3) Rotate the T type terminal box clockwise to approx. 15° before the required position.
- (4) Tighten the lock nut to the coil side by hand until it is lightly tightened.
- (5) Hold the width across flats of the T type terminal box with a tool, and rotate it (approx. 15°) to tighten it to the required position.

Note: When further tightening the terminal box to change the orientation from the default position, rotate it within 1/2 turn.

### NVP11, NP13, NP14-10A to 25A

#### 1 Pilot solenoid valve assembling procedure (for types with solenoid valve)

If the pilot solenoid valve has been disassembled, assemble it as follows.

After disassembly, assemble the manual override section (green) onto the port A side of the body.

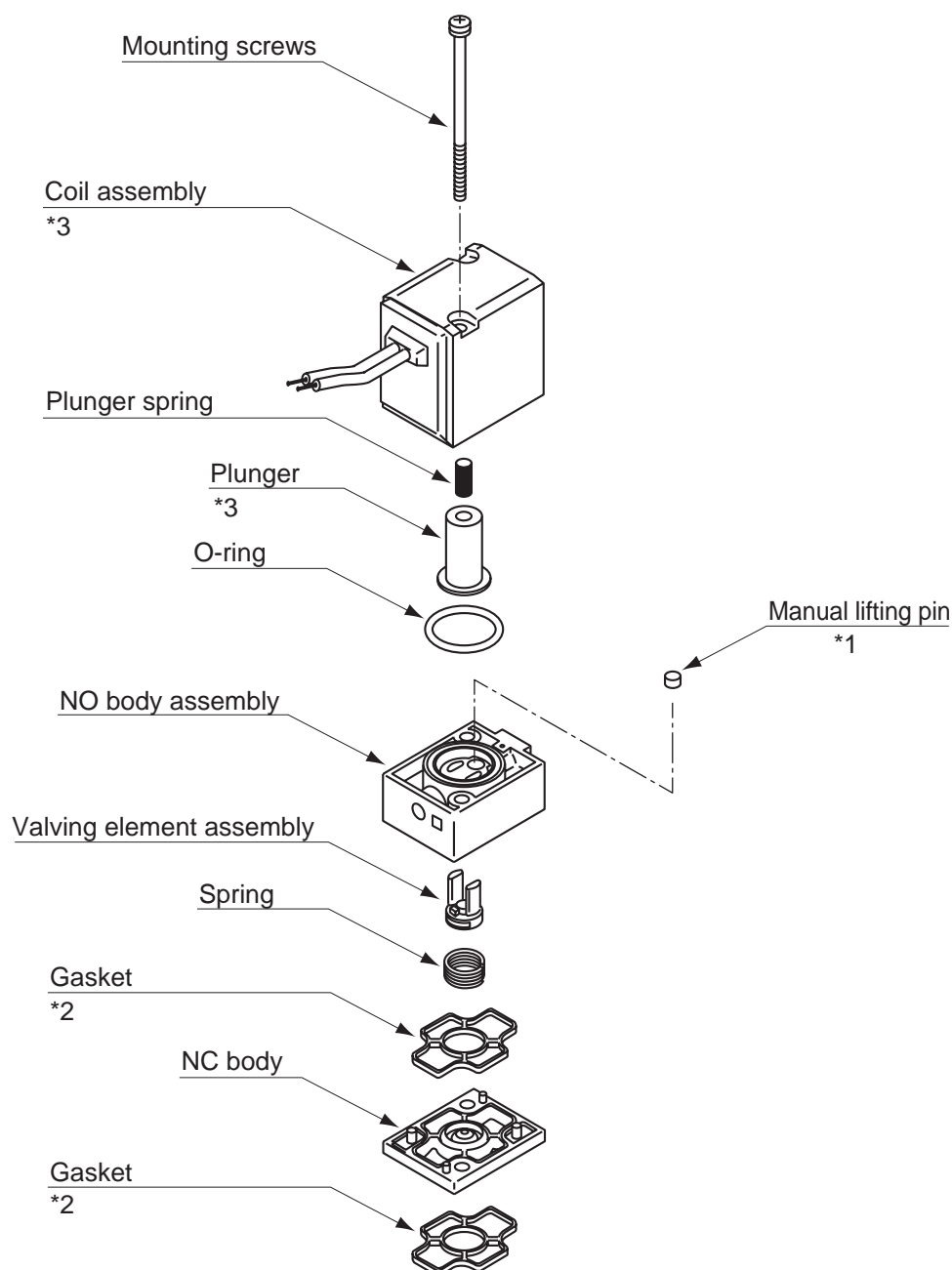

\*1 : Do not lose components such as manual lifting pins during disassembly.

\*2 : The gasket has an orientation. Be careful when setting in the NC body.

\*3 : Coil assembly and plunger are different between AC voltage and DC voltage. Replace them as a set when necessary.

\*4 : Plunger is coated with turbine oil for lubrication.

#### ■ Remarks

● Model No. of pilot solenoid valve (actuator assembly kit) for NVP11-10A to 25A, NP<sub>14</sub><sup>13</sup>-10A to 25A

CVS2-B-0   - (Rated voltage)

↑  
Coil option code

EXA
FWD
HNB/G
USB/G
FAB/G
FGB/G
FVB
FWB/G
FHB
FLB
AB
AG
AP/ AD
APK/ ADK
DryAir
EX- XPLNprf
XPLNprf
HVB/ HVL
S <sup>◇</sup> B/ NAB
LAD/ NAD
Water- Rela
<b>NP/NAP/ NVP</b>
SNP
CHB/G
MXB/G
Other valves
SWD/ MWD
DustColl
CVE/ CVSE
CCH/ CPE/D
LifeSci
Gas- Combus
Auto- Water
Outdoor
SpecFld
Custom
Ending