

D3-156878 2 2022.09.30 Handling Instructions

W4G4 series

Single air supply spacer

Single air exhaust spacer

Thank you for purchasing CKD product.

Please review the precautions in this instruction thoroughly for safe operation of this equipment.

Keep this document in a safe location so that it is easily referenced as necessary.

For further information, refer to the instruction manual and product catalog.

CAUTION! Do not unpack solenoid valve until the piping is ready for connection.

Foreign materials entering through piping port will cause failure and malfunction.

Piping and installation

⚠ WARNING

- Screws used to fasten pipe joints must be tightened with correct torque. Otherwise, air will leak or screws will be damaged.

Tightening torque

Connecting screw	Tightening torque N·m
Rc/NPT/G 1/8	3-5
Rc/NPT/G 1/4	6-8
Rc/NPT/G 3/8	13-15

- Before connecting the piping to the valve, thoroughly clean the inside of piping by air blowing (flushing) or by washing to clear off chips, cutting lubricant, dust and foreign objects.
- When wrapping a seal tape, start wrapping 2 mm from the tip of the screw, in the direction of screw. If the tape protrudes from the screw section, it will be cut as the piping is screwed, leaving shreds inside valve. These chips or shreds will result in failure.

Parts composition

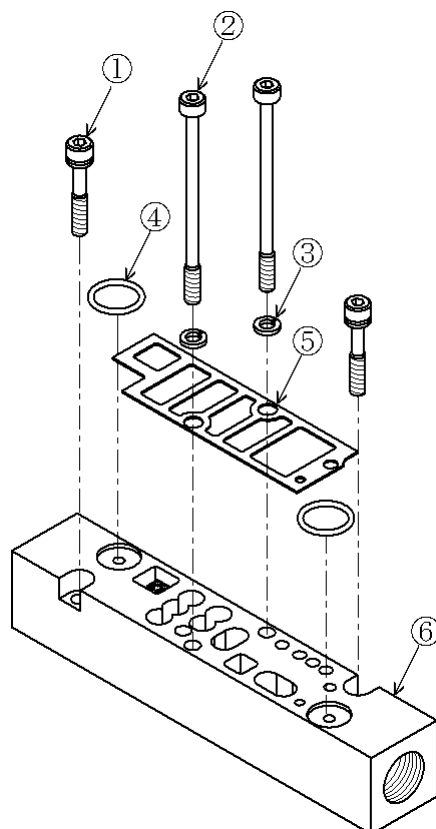

- ① Hexagon Socket Head Cap Screw M4 25mm x2
Tightening torque 2.4 - 2.6 N·m
- ② Hexagon Socket Head Cap Screw M4 62mm x2
Tightening torque 2.4 - 2.6 N·m
- ③ Spring Lock Washer x2
- ④ O-ring x2
- ⑤ Gasket x1
- ⑥ Supply spacer or Exhaust spacer x1

Method of installing spacer

- Please pay attention not to lose the gasket when the solenoid valve body is disassembled.
- The supply spacer and the exhaust spacer have the same parts composition except for the main body of the supply and exhaust spacer.

<<Installation method>>

1. Turn off the pressure to the manifold.
2. Disassemble the solenoid valve where the spacer is added.
(This screw is not used for the spacer installation.)
3. Tighten the screw after setting the parts as shown below.
Tighten the one side lightly first, then tighten the other side, and tighten the first side tightened lightly firmly.

<Tightening torque>

2.4 - 2.6 N·m

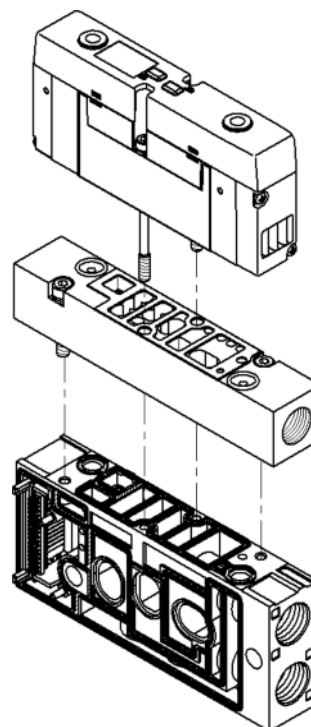

CKD corporation

Head Office & Factory

2-250 Uji, Komaki-city, Aichi, 485-8551, Japan
Phone +81-(0)568-77-1111
FAX +81-(0)568-77-1123

Overseas Sales Administration Department

2-250 Uji, Komaki-city, Aichi, 485-8551, Japan
Phone +81-(0)568-74-1338
FAX +81-(0)568-77-3461

For dealer information, refer to our catalog or visit our website.

<http://www.ckd.co.jp/>