

Material / Treatment

● PowerArm PAW

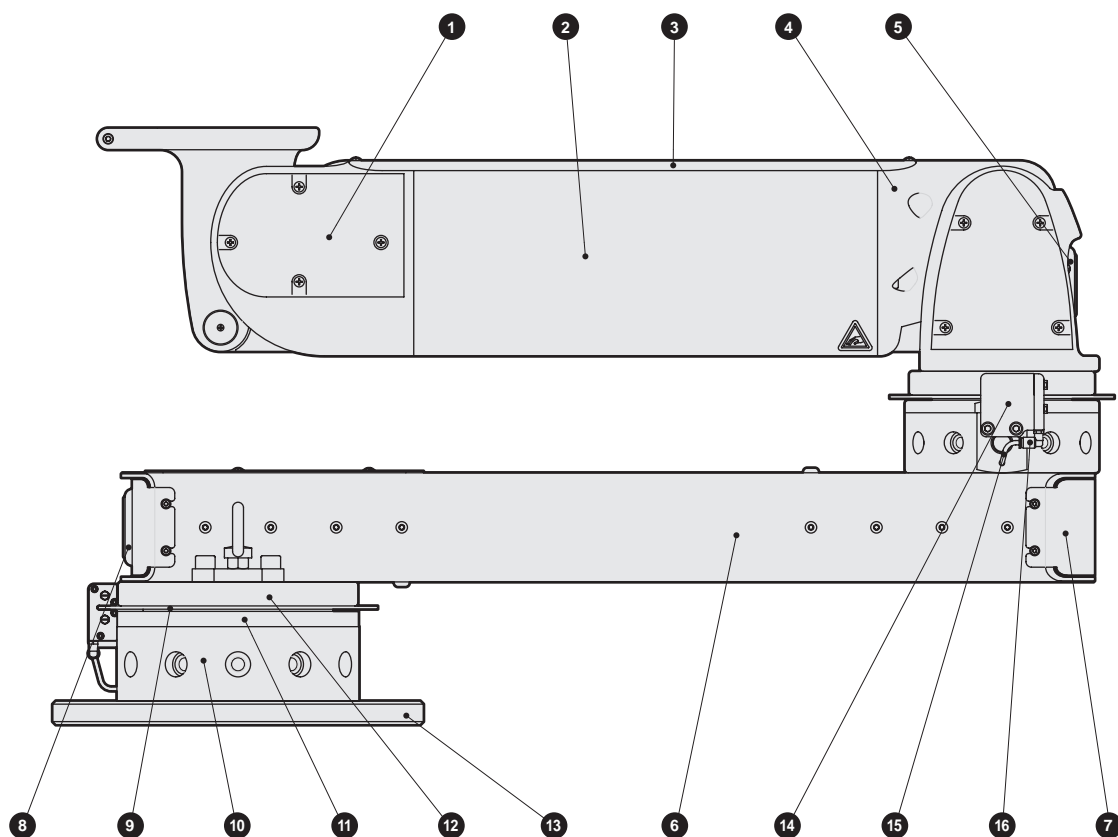

| No. | Product name | Part name | Material | Surface-treated |
|-----|-------------------------|------------------------------|---|--|
| 1 | PowerArm unit (*1) | Crevice cover, bracket cover | Flame-resistant ABS resin | |
| 2 | | Body | Aluminum alloy | Alumite treatment |
| 3 | | Top cover | Aluminum alloy | Alumite treatment |
| 4 | | Crevice, bracket, link arm | Aluminum alloy | Baked finish |
| 5 | | Grommet | EPDM | |
| 6 | SCARA arm unit (*2) | Body | Steel | Baked finish |
| 7 | | Cover | Aluminum alloy | Alumite treatment |
| 8 | | Grommet | EPDM | |
| 9 | Rotation unit (*3) | Lock disk | Stainless steel alloy | Industrial chrome plating |
| 10 | | Body | Aluminum alloy | Alumite treatment |
| 11 | | Washer | Steel | Zinc plated chromate treatment |
| 12 | | Mounting plate | Aluminum alloy | Alumite treatment |
| 13 | Base plate (*4) | Base plate | Steel | Zinc plated chromate treatment |
| 14 | Rotation lock unit (*5) | Rotation lock unit | Steel | Zinc plated chromate treatment |
| 15 | | Tube | Nylon | |
| 16 | | Fitting | Flame-resistant PBT resin Copper alloy | Electroless nickel plating for copper alloy sections |

Material / Treatment

● Palletizing specifications PAW-A

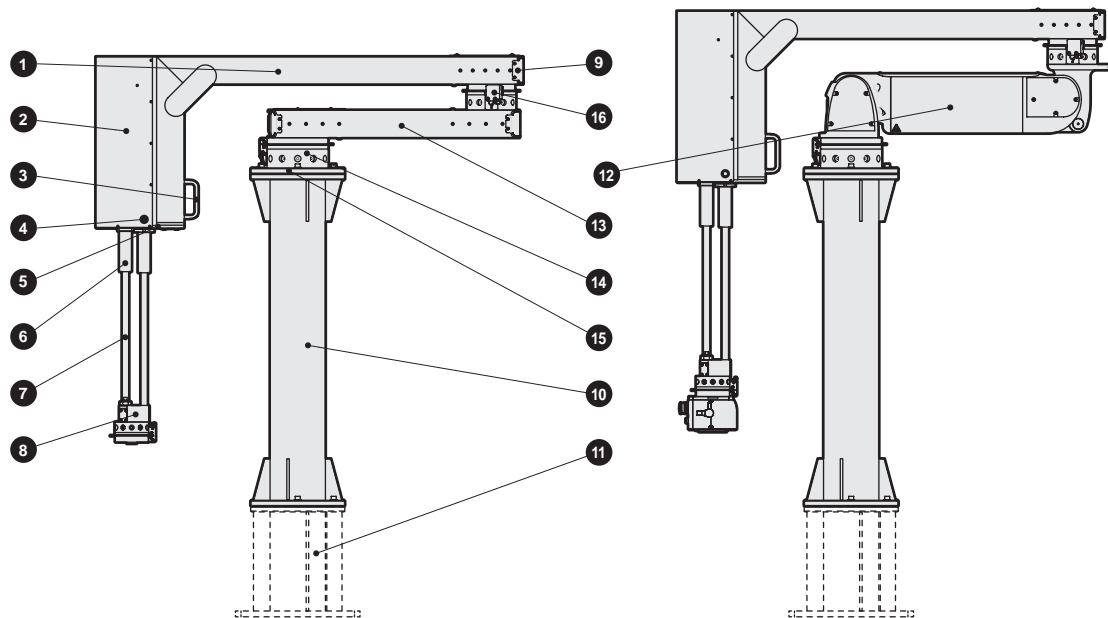

| No. | Product name | Part name | Material | Surface-treated |
|-----|------------------------------|-------------------------|-----------------------|--------------------------------|
| 1 | Palletizing unit | Extension body | Steel | Baked finish |
| 2 | | Cover A, Cover B | Stainless steel alloy | Baked finish |
| 3 | | Handle | Aluminum alloy | Electrostatic coating |
| 4 | | Grommet | EPDM | |
| 5 | | Mounting flange | Steel | Zinc plated chromate treatment |
| 6 | | Linear bush | Steel | Electroless nickel plating |
| 7 | | Guide shaft, piston rod | Steel | Industrial chrome plating |
| 8 | | Connection block | Aluminum alloy | Alumite treatment |
| 9 | | Rear cover | Aluminum alloy | Alumite treatment |
| 10 | | Mount frame | Steel | Painted |
| 11 | Base (made-to-order product) | Base | Steel | Painted |
| 12 | PowerArm unit | | Compliant to PAW (*1) | |
| 13 | SCARA arm unit | | Compliant to PAW (*2) | |
| 14 | Rotation unit | | Compliant to PAW (*3) | |
| 15 | Base plate | | Compliant to PAW (*4) | |
| 16 | Rotation lock unit | | Compliant to PAW (*5) | |

Regular maintenance parts

The replacement must be performed by an operator having sufficient knowledge and experience. Be sure to read the instruction manual carefully.

| Part name | Part model No. | Applicable unit model No. | Standard replacement time *1, *2 |
|---|---|---------------------------|--|
| Stopper bolt | PAW-RU-T-STB-KIT | PAW-RU-T | 20,000 cycles or a year |
| | PAW-RU-8-STB-KIT | PAW-RU-8 | |
| | PAW-RU-X-STB-KIT | PAW-RU-X | |
| | PAW-RU-Z-STB-KIT | PAW-RU-Z | |
| | PAW-RU-ZS-STB-KIT | PAW-RU-ZS | |
| Anti-rotation bolt | PAW-RU-T-ARB-KIT | PAW-RU-T | 100,000 cycles or 5 years (20,000 cycles or 1 year when not using a stopper bolt and used as a rotating stopper) |
| | PAW-RU-8-ARB-KIT | PAW-RU-8 | |
| | PAW-RU-X-ARB-KIT | PAW-RU-X | |
| | PAW-RU-Z-ARB-KIT | PAW-RU-Z | |
| | PAW-RU-ZS-ARB-KIT | PAW-RU-ZS | |
| [Mechanical lock specifications only] Cushion rubber | PAW-AU-8-B-CR-KIT | PAW-AU-8-B | 100,000 cycles or 5 years |
| | PAW-AU-X-B-CR-KIT | PAW-AU-X-B | |
| | PAW-AU-Z-B-CR-KIT | PAW-AU-Z-B | |
| SPIRAL TUBE AND BINDING BAND | Recommended product: TS-9 Recommended product: AB80 | | 100,000 cycles or 5 years |
| Tube | Wear resistant tube ARU-8×5 (Aoi Co., Ltd.) Wear resistant tube ARU-10×6.5 (Aoi Co., Ltd.) Soft nylon tube F-1504 (CKD Co., Ltd.) | | |

*1: As this value differs depending on the frequency of use and working conditions, it is not a guaranteed value.

*2: Estimated frequency calculated as 80 cycles/day (vertical reciprocating operation) × 240 days/year.