

EKS-L*

Electric actuator
Motorless specification

Slider (Fast tact/high rigidity model)



CONTENTS

Product introduction	Intro
Series variation	458
● Specifications/How to order/Dimensions	
· EKS-04L*	462
· EKS-05L*	470
· EKS-06L*	478
· EKS-08L*	486
· EKS-10L*	494
● Model selection	502
● Technical data	504
⚠ Safety precautions	686
Model Selection Check Sheet	708

EBS

EBR

ETS

ETS Multi-Axis

ECS

ETV

ECV

EKS

EBS

EBR

ETS

ECS

Safety
precautions

Series variation

Type	Model No.	Applicable motor capacity (W)	Body width (mm)	Screw lead (mm)	Max. load capacity (kg) *1			
					Horizontal	Wall-mounted	Vertical	
Slider		EKS-04L*-10	50 100	43	10	19	10.5	8.5
		EKS-04L*-16						
		EKS-05L*-10	100	53	10	26	19	12.5
		EKS-05L*-20						
		EKS-06L*-20	200	64	20	42	20	12
		EKS-06L*-30						
		EKS-08L*-20	400	84	20	83.5	45	23.5
		EKS-08L*-40						
		EKS-10L*-25	750	104	25	118.5	76	33.5
		EKS-10L*-50						

Servo motor compatible

Stepper motor compatible

Safety precautions

	Stroke length (mm) and max. speed (mm/s) *2																	Page		
	100 mm	200	300	400	500	600	700	800	900	1000	1100	1200	1300	1400	1500	1600	1700			
	500 mm/s					440	340	260	210	*3 🕒 4.3 sec.									462	
	800					710	540	420	340	🕒 2.66 sec.										
	500					390	310	250		🕒 3.61 sec.										470
	1000					780	620	500		🕒 1.83 sec.										
	1000					980	770	630	520	430	370	320			🕒 4.08 sec.					478
	1500					1480	1160	940	780	650	550	480			🕒 2.73 sec.					
	1000					980	800	670	560	480	420	360	320			🕒 4.7 sec.				486
	2000					1970	1610	1340	1130	970	840	730	650			🕒 2.34 sec.				
	1250									1050	890	760	660	580	510			🕒 2.97 sec.		494
	2500									2110	1790	1530	1330	1160	1030			🕒 1.51 sec.		

*1: Values for max. load capacity are at acceleration/deceleration 0.5 G and straight motor mounting. Refer to the specifications for each model and the Load Capacity by Acceleration/deceleration table on page 510 to 511 for details.

*2: The max. speed is the speed when the motor mounted by the customer can output a rotation speed of 3000 rpm. The max. speed is restricted by the stroke. Do not move at speeds beyond the limit.

*3: 🕒 shows the positioning time. Maximum stroke when installed horizontally and operated at max. speed and max. acceleration/deceleration. Note that this is not the value at maximum load capacity.

EBS
 EBR
 ETS
 ETS Multi-Axis
 ECS
 ETV
 ECV
EKS
 EBS
 EBR
 ETS
 ECS
 Stepper motor compatible
 Safety precautions

How to order

How to order

EKS - 04 L E - 10 0300 N NN - M 1 N C B

A B C D E F G H I J K

A Body size	
04	Body width 43 mm
05	Body width 53 mm
06	Body width 64 mm
08	Body width 84 mm
10	Body width 104 mm

B Motor	
L	None

C Motor mounting direction	
E	Straight mounting
R	Right mounting
D	Bottom mounting
L	Left mounting

D Screw lead	
10	10 mm
16	16 mm
20	20 mm
25	25 mm
30	30 mm
40	40 mm
50	50 mm

E Stroke length	
0100	100 mm
to	(In 100 mm increments)
1500	1500 mm

F Brake	
N	None

G Mounted motor specification	
M	Refer to the list on the page at right
Y	
P	

H Motor capacity	
H	50 W
1	100 W
2	200 W
4	400 W
8	750 W

I Motor shaft fixing method *1 *2 *3	
N	For straight mounting
D	Flat
K	Key
M	Friction locking

K Limit sensor	
N	None
B	Yes

J Origin sensor	
N	None
C	Yes

- *1: For straight mounting of all body sizes, select "For straight mounting."
- *2: For side mounting of EBS-04, 05, and 06 only, select "Flat" or "Key."
- *3: For side mounting of EBS-06, 08, and 10 only, select "Friction locking."

Example of model No.

EKS-04LE-100300NNN-M1NCB

Body size	: 04 Series
Motor	: None
Motor mounting direction	: Straight mounting
Screw lead	: 10 mm
Stroke length	: 300 mm
Mounted motor specification	: M (refer to the table on the page at right)
Motor capacity	: 100 W
Motor shaft fixing method	: Straight
Origin sensor	: Yes
Limit sensor	: Yes

*This product is composed of an actuator (and motor mounting parts) only; there is no motor attached. The user must prepare, mount, and adjust the motor and driver.

EBS
 EBR
 ETS
 ETS Multi-Axis
 ECS
 ETV
 ECV
EKS
 EBS
 EBR
 ETS
 ECS

Servo motor compatible

Stepper motor compatible

Safety precautions

List of servo motors recommended for mounting

Code	Manufacturer	Series	50 W (EKS-04 Series)	100 W (EKS-04/05 Series)
M	Mitsubishi Electric Corporation	MELSERVO J4	HG-KR053	HG-KR13
		MELSERVO J5	HG-KT053W	HK-KT13W
M	Delta Electronics Co., Ltd.	ECMA-C	ECMA-C1040F	ECMA-C10401
M	Sanyo Corporation, Ltd.	SANMOTION R *1	R2□A04005	R2□A04010
Y	YASKAWA Electric Corporation	Σ-V	SGMJV-A5	SGMJV-01
		Σ-7	SGM7J-A5	SGM7J-01
Y	Keyence Corporation	SV	SV-□005	SV-□010
		SV2	SV2-□005	SV2-□010
P	Panasonic Corporation	MINAS A5	MSMD5A	MSMD01
		MINAS A6	MSMF5A	MSMF01
M	OMRON Corporation	G5	R88M-K0503	R88M-K10030
		1S	-	R88M-1M10030
M	Fuji Electric Co., Ltd.	ALPHA7 GYS	GYS500D7-□B2□	GYS101D7-□B2□
		ALPHA7 GYB	-	-
M	FANUC CORPORATION	βis series	βis0.2/5000	βis0.3/5000
P	Bosch Rexroth AG	MSM	MSM019A	MSM019B
M	Rockwell Automation, Inc.	TLP	TLP-A046-005-DKA□2	TLP-A046-010-DKA□2
M	SIEMENS AG	1FK2 *2	1FK2102-0AG0	1FK2102-1AG0

Code	Manufacturer	Series	200 W (EKS-06 Series)	400 W (EKS-08 Series)	750 W (EKS-10 Series)
M	Mitsubishi Electric Corporation	MELSERVO J4	HG-KR23	HG-KR43	HG-KR73
		MELSERVO J5	HK-KT23W	HK-KT43W	HK-KT7M3W
M	Delta Electronics Co., Ltd.	ECMA-C	ECMA-C10602	ECMA-C10604	ECMA-C10807
M	Sanyo Corporation, Ltd.	SANMOTION R	R2□A06020	R2□A06040	-
Y	YASKAWA Electric Corporation	Σ-V	SGMJV-02	SGMJV-04	SGMJV-08
		Σ-7	SGM7J-02	SGM7J-04	SGM7J-08
Y	Keyence Corporation	SV	SV-□020	SV-□040	SV-□075
		SV2	SV2-□020	SV2-□040	SV2-□075
P	Panasonic Corporation	MINAS A5	MSMD02	MSMD04	MSMD08
		MINAS A6	MSMF02	MSMF04	MSMF08
P	OMRON Corporation	G5	R88M-K20030	R88M-K40030	R88M-K75030
		1S	R88M-1M20030	R88M-1M40030	R88M-1M75030
M	Fuji Electric Co., Ltd.	ALPHA7 GYS	GYS201D7-□B2□	GYS401D7-□B2□	GYS751D7-□B2□
		ALPHA7 GYB	GYB201D7-□B2□	GYB401D7-□B2□	GYB751D7-□B2□
P	Bosch Rexroth AG	MSM	MSM031B	MSM031C	MSM041B
M	Rockwell Automation, Inc.	TLP	TLP-A070-020-DKA□2	TLP-A070-040-DKA□2	TLP-A090-075-DKA□2
M	SIEMENS AG	1FK2 *2	1FK2203-2AG0	1FK2203-4AG0	1FK2204-5AK0

* Contact CKD for mounting other than the above motors and products of other motor manufacturers.

* Contact CKD for brake use with vertical use, etc.

*1: Motor side/bottom mounting direction (R: right, D: bottom, L: left) is not supported.

*2: The servo motor is subject to the regulations of Export Trade Control Order Appendix Table 1 Item 7 (8), and is applicable with regard to its specifications. (as of January 2021)



Electric actuator (motorless) Slider

EKS-04LE

Straight motor mounting

● Servo motor capacity: 50 W/100 W

How to order

EKS - 04 L E - 10 0300 N NN - M 1 N C B

A Body size

04	Body width 43 mm
----	------------------

B Motor

L	None
---	------

C Motor mounting direction

E	Straight mounting
---	-------------------

D Screw lead

10	10 mm
16	16 mm

E Stroke length *1

0100	100 mm
to	(In 100 mm increments)
0900	900 mm

F Brake

N	None
---	------

G Mounted motor specification

M	Select the mounted motor specification from the table at right.
Y	
P	

H Motor capacity

H	50 W
1	100 W

I Origin sensor *2

N	None
C	Yes

J Motor shaft fixing method

N	For straight mounting
---	-----------------------

K Limit sensor *2

N	None
B	Yes

Manufacturer	50 W	100 W
Mitsubishi Electric Corporation	M	M
Delta Electronics Co., Ltd.	M	M
Sanyo Denki Co., Ltd.	M	M
YASKAWA Electric Corporation	Y	Y
Keyence Corporation	Y	Y
Panasonic Corporation	P	P
OMRON Corporation	M	M
Fuji Electric Co., Ltd.	M	M
FANUC CORPORATION	M	M
Bosch Rexroth AG	P	P
Rockwell Automation, Inc.	M	M
SIEMENS AG	M	M

*Refer to page 461 for the motor model No.

*1: For the stroke length per 50 mm, contact CKD.

*2: Origin sensor and limit sensor are available as a set. As it is both-or-nothing, select "None" for both.

Specifications

Applicable motor capacity	50 W/100 W servo motor	
Drive method	Ball screw ϕ 10	
Stroke length mm	100 to 900	
Screw lead mm	10	16
Max. load capacity kg *1 *2	Horizontal	19
	Wall-mounted	10.5
	Vertical	8.5
Max. speed mm/s	500	800
Rated thrust *2 N	179	112
Repeatability mm	± 0.01	
Lost motion mm	0.1 or less	
Static allowable load N	2140	
Static allowable moment N·m	MP: 103, MY: 103, MR: 58	
Operating ambient temperature, humidity	0 to 40°C (no freezing) 20 to 80% RH (no condensation)	
Storage ambient temperature, humidity	0 to 40°C (no freezing) 20 to 80% RH (no condensation)	
Atmosphere	No corrosive gas, explosive gas, or dust	

*1: Values for max. load capacity are at acceleration/deceleration 0.5 G. Refer to page 510 for details.

*2: Rated thrust and max. load capacity are guideline values assuming that the motor mounted will output the rated torque.

Stroke and max. speed

		(mm/s)				
Screw lead	Stroke length	100 to 500	600	700	800	900
	10		500	440	340	260
16		800	710	540	420	340

*The max. speed is the speed when the motor mounted by the customer can output a rotation speed of 3000 rpm.
The max. speed is restricted by the stroke. Do not move at speeds beyond the limit.

Allowable overhang length

*Refer to page 504 for details.

Moment direction

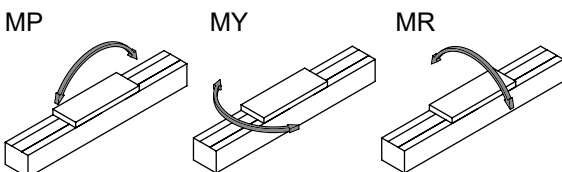

Safety precautions

EBS
 EBR
 ETS
 ETS Multi-Axis
 ECS
 ETV
 ECV
 EKS
 EBS
 EBR
 ETS
 ECS
 Stepper motor compatible
 Servo motor compatible
 Safety precautions

Dimensions Straight motor mounting

● EKS-04LE

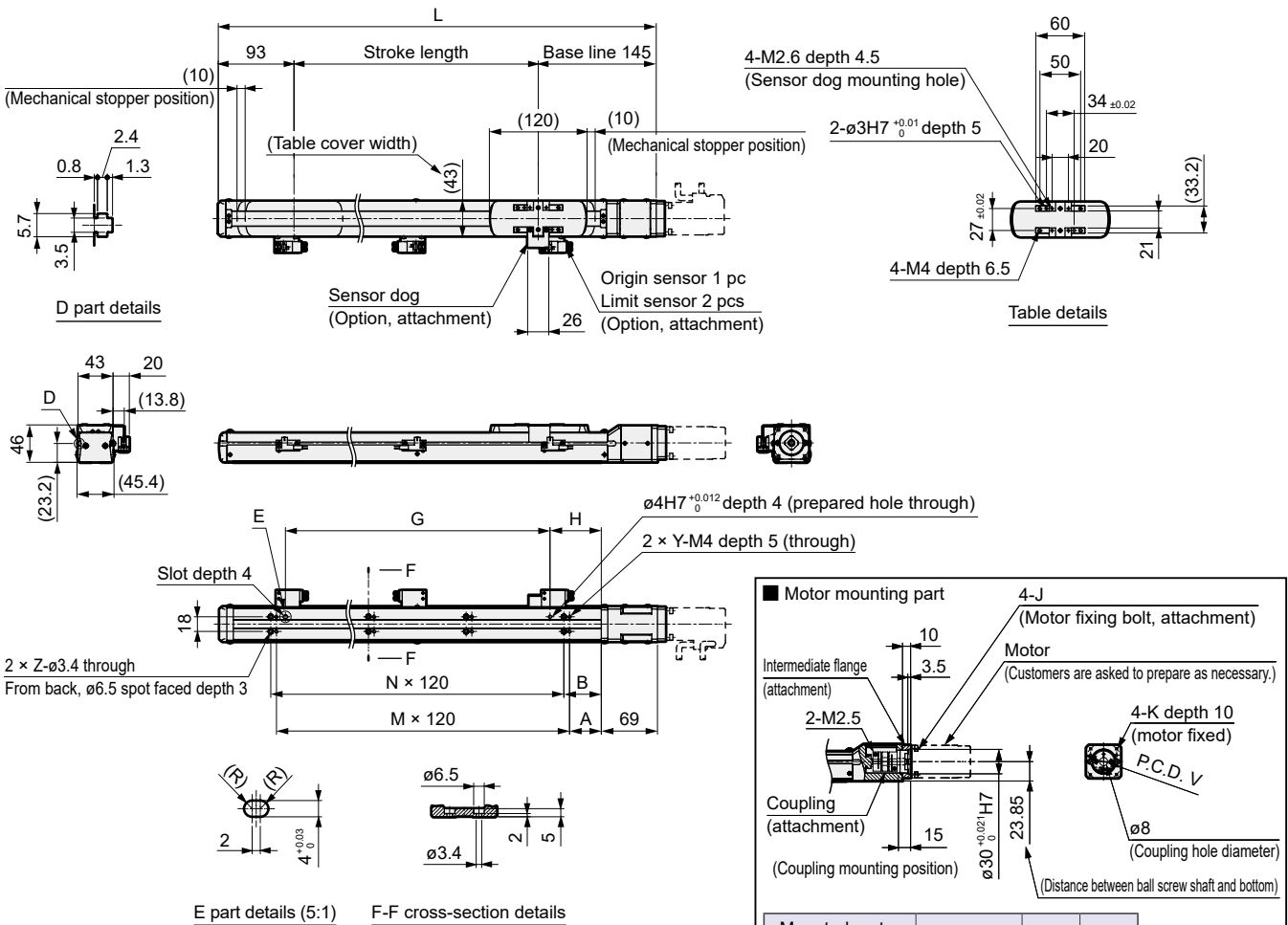

Stroke code	0100	0200	0300	0400	0500	0600	0700	0800	0900
Stroke length (mm)	100	200	300	400	500	600	700	800	900
L	338	438	538	638	738	838	938	1038	1138
A	59	42	39	89	79	69	59	42	39
B	66	56	46	96	86	76	66	56	46
G	125	225	325	425	525	625	725	825	925
H	48	63	63	48	63	63	48	63	63
M	1	2	3	3	4	5	6	7	8
N	1	2	3	3	4	5	6	7	8
Y	2	3	4	4	5	6	7	8	9
Z	2	3	4	4	5	6	7	8	9
Weight (kg)	1.7	2.1	2.5	2.9	3.2	3.6	4	4.4	4.7

List of attachments

[Motor mounting parts]

Mounted motor specification	Coupling	Intermediate flange fixing bolt	Motor mounting bolt	
			Size	Quantity
M	Included at shipment	Included at shipment	M4	4
Y			M4	4
P			M3	4

[Origin sensor, limit sensor]

Manufacturer	Model	Included quantity
OMRON Corporation	EE-SX674	3

*Refer to page 512 for sensor specifications.



Electric actuator (motorless) Slider

EKS-04L*

Motor side mounting (left, right, bottom)

● Servo motor capacity: 50 W/100 W

How to order

EKS - 04 L R - 10 0300 N NN - M 1 D C B

A Body size 04 Body width 43 mm	E Stroke length 0100 100 mm to (In 100 mm increments) 0900 900 mm	H Motor capacity H 50 W 1 100 W	J Origin sensor *2 N None C Yes																																							
B Motor L None	F Brake N None	I Motor shaft fixing method D Flat K Key	K Limit sensor *2 N None B Yes																																							
C Motor mounting direction R Right mounting D Bottom mounting L Left mounting	G Mounted motor specification M Select the mounted motor specification from the table at right. Y P	<table border="1"> <thead> <tr> <th>Manufacturer</th> <th>50 W</th> <th>100 W</th> </tr> </thead> <tbody> <tr><td>Mitsubishi Electric Corporation</td><td>M</td><td>M</td></tr> <tr><td>Delta Electronics Co., Ltd.</td><td>M</td><td>M</td></tr> <tr><td>Sanyo Denki Co., Ltd.</td><td>M</td><td>M</td></tr> <tr><td>YASKAWA Electric Corporation</td><td>Y</td><td>Y</td></tr> <tr><td>Keyence Corporation</td><td>Y</td><td>Y</td></tr> <tr><td>Panasonic Corporation</td><td>P</td><td>P</td></tr> <tr><td>OMRON Corporation</td><td>M</td><td>M</td></tr> <tr><td>Fuji Electric Co., Ltd.</td><td>M</td><td>M</td></tr> <tr><td>FANUC CORPORATION</td><td>M</td><td>M</td></tr> <tr><td>Bosch Rexroth AG</td><td>P</td><td>P</td></tr> <tr><td>Rockwell Automation, Inc.</td><td>M</td><td>M</td></tr> <tr><td>SIEMENS AG</td><td>M</td><td>M</td></tr> </tbody> </table>		Manufacturer	50 W	100 W	Mitsubishi Electric Corporation	M	M	Delta Electronics Co., Ltd.	M	M	Sanyo Denki Co., Ltd.	M	M	YASKAWA Electric Corporation	Y	Y	Keyence Corporation	Y	Y	Panasonic Corporation	P	P	OMRON Corporation	M	M	Fuji Electric Co., Ltd.	M	M	FANUC CORPORATION	M	M	Bosch Rexroth AG	P	P	Rockwell Automation, Inc.	M	M	SIEMENS AG	M	M
Manufacturer	50 W	100 W																																								
Mitsubishi Electric Corporation	M	M																																								
Delta Electronics Co., Ltd.	M	M																																								
Sanyo Denki Co., Ltd.	M	M																																								
YASKAWA Electric Corporation	Y	Y																																								
Keyence Corporation	Y	Y																																								
Panasonic Corporation	P	P																																								
OMRON Corporation	M	M																																								
Fuji Electric Co., Ltd.	M	M																																								
FANUC CORPORATION	M	M																																								
Bosch Rexroth AG	P	P																																								
Rockwell Automation, Inc.	M	M																																								
SIEMENS AG	M	M																																								
D Screw lead 10 10 mm 16 16 mm																																										

*1: For the stroke length per 50 mm, contact CKD.
*2: Origin sensor and limit sensor are available as a set. As it is both-or-nothing, select "None" for both.

*Refer to page 461 for the motor model No.

Specifications

Applicable motor capacity	50 W/100 W servo motor	
Drive method	Ball screw ϕ 10	
Stroke length mm	100 to 900	
Screw lead mm	10	16
Max. load capacity kg *1*2	Horizontal	14
	Wall-mounted	8
	Vertical	7
Max. speed mm/s	500	800
Rated thrust *2 N	179	112
Repeatability mm	\pm 0.01	
Lost motion mm	0.1 or less	
Static allowable load N	2140	
Static allowable moment N·m	MP: 103, MY: 103, MR: 58	
Operating ambient temperature, humidity	0 to 40°C (no freezing) 20 to 80% RH (no condensation)	
Storage ambient temperature, humidity	0 to 40°C (no freezing) 20 to 80% RH (no condensation)	
Atmosphere	No corrosive gas, explosive gas, or dust	

*1: Values for max. load capacity are at acceleration/deceleration 0.5 G. Refer to page 510 for details.
*2: Rated thrust and max. load capacity are guideline values assuming that the motor mounted will output the rated torque.

Stroke and max. speed

Screw lead \ Stroke length	(mm/s)				
	100 to 500	600	700	800	900
10	500	440	340	260	210
16	800	710	540	420	340

*The max. speed is the speed when the motor mounted by the customer can output a rotation speed of 3000 rpm.
The max. speed is restricted by the stroke. Do not move at speeds beyond the limit.

Allowable overhang length

*Refer to page 504 for details.

Moment direction

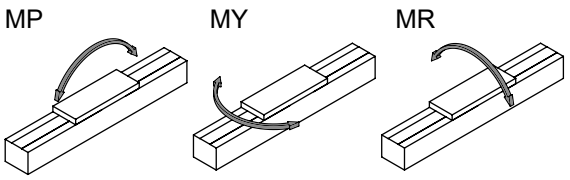

Servo motor compatible

Stepper motor compatible

Safety precautions

EBS EBR ETS ETS Multi-Axis ECS ETV ECV EKS EBS EBR ETS ECS Stepper motor compatible Servo motor compatible

Dimensions Motor right-side mounting

● EKS-04LR

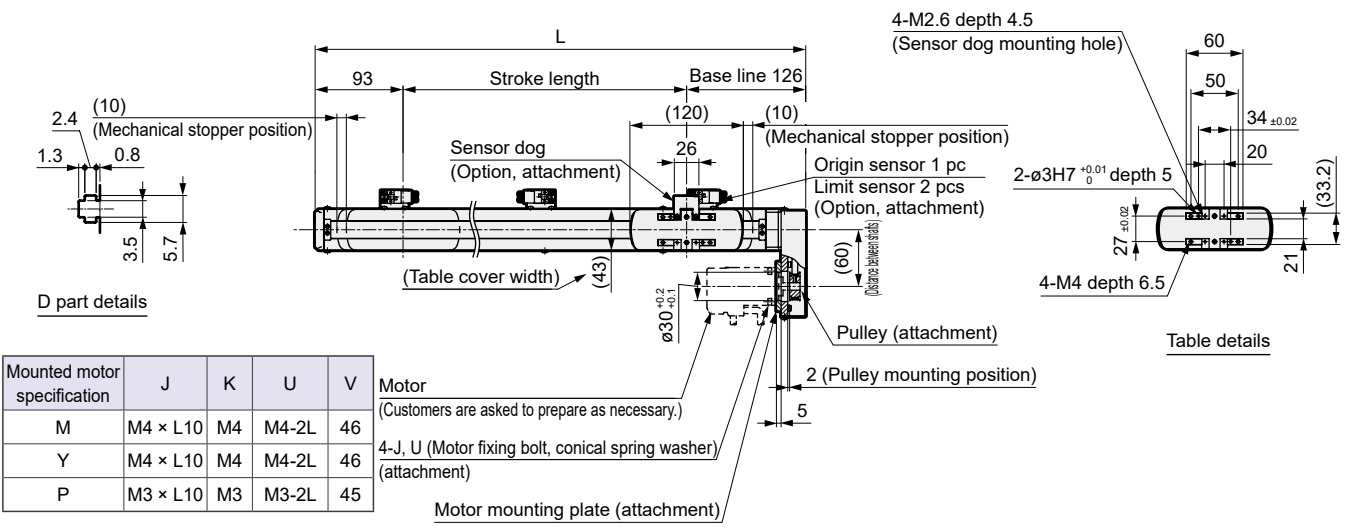

Mounted motor specification	J	K	U	V	Motor
M	M4 × L10	M4	M4-2L	46	(Customers are asked to prepare as necessary.)
Y	M4 × L10	M4	M4-2L	46	
P	M3 × L10	M3	M3-2L	45	

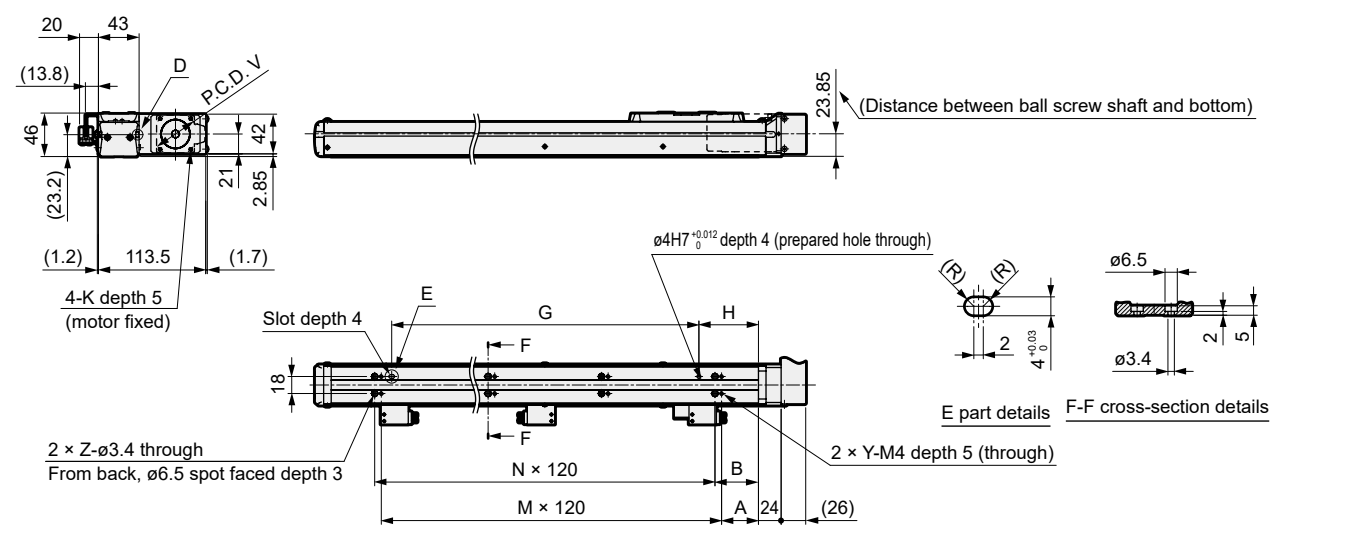

Stroke code	0100	0200	0300	0400	0500	0600	0700	0800	0900
Stroke length (mm)	100	200	300	400	500	600	700	800	900
L	319	419	519	619	719	819	919	1019	1119
A	59	42	39	89	79	69	59	42	39
B	66	56	46	96	86	76	66	56	46
G	125	225	325	425	525	625	725	825	925
H	48	63	63	48	63	63	48	63	63
M	1	2	3	3	4	5	6	7	8
N	1	2	3	3	4	5	6	7	8
Y	2	3	4	4	5	6	7	8	9
Z	2	3	4	4	5	6	7	8	9
Weight (kg)	1.9	2.3	2.7	3	3.4	3.8	4.2	4.5	4.9

List of attachments

[Motor mounting parts]

Mounted motor specification	Pulley	Motor mounting plate fixing bolt	Motor mounting bolt	
			Size	Quantity
M	Included at shipment	Included at shipment	M4	4
Y			M4	4
P			M3	4

[Origin sensor, limit sensor]

Manufacturer	Model	Included quantity
OMRON Corporation	EE-SX674	3

*Refer to page 512 for sensor specifications.

Safety precautions

EKS-04L*

Dimensions Motor bottom mounting

● EKS-04LD

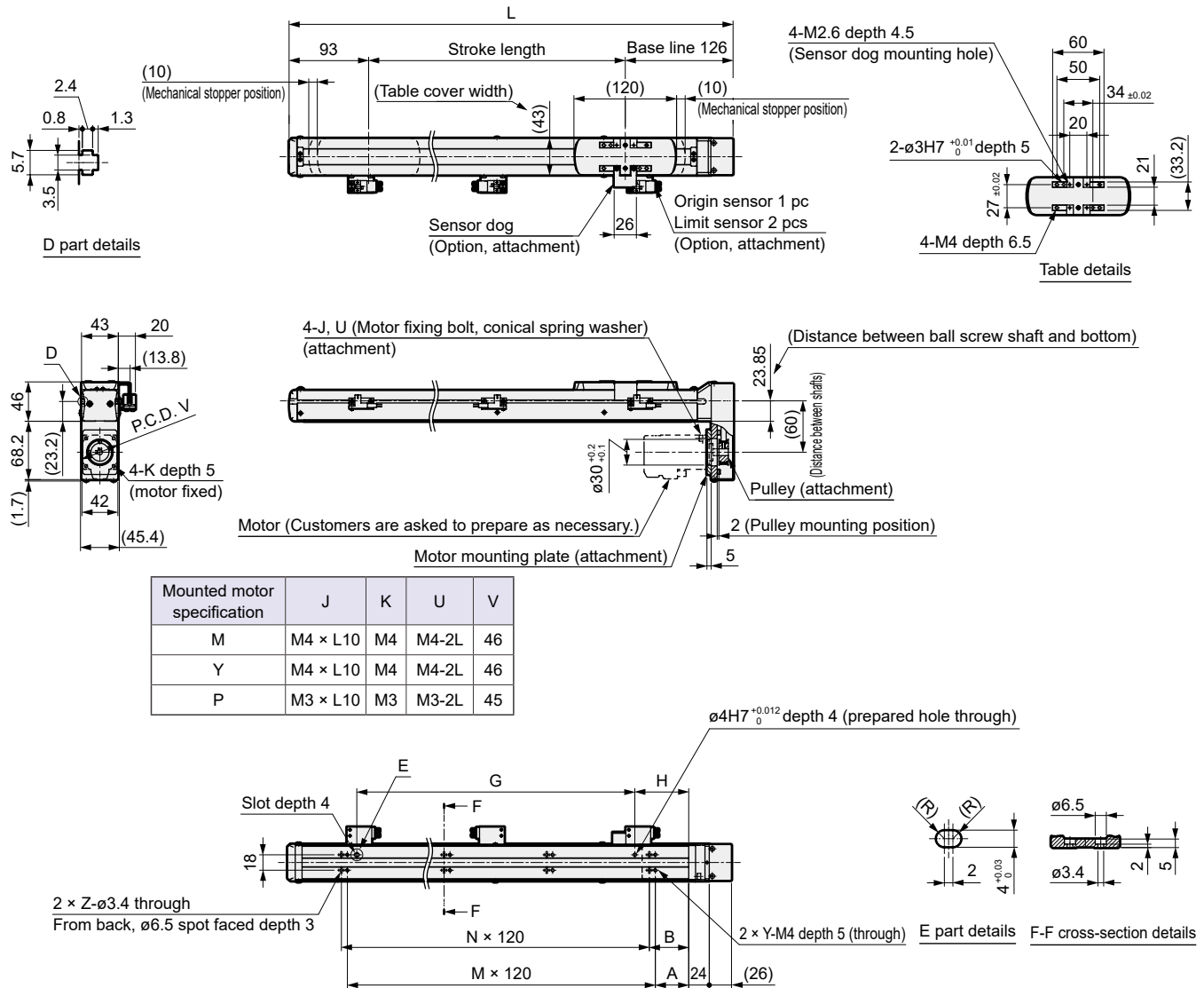

Stroke code	0100	0200	0300	0400	0500	0600	0700	0800	0900
Stroke length (mm)	100	200	300	400	500	600	700	800	900
L	319	419	519	619	719	819	919	1019	1119
A	59	42	39	89	79	69	59	42	39
B	66	56	46	96	86	76	66	56	46
G	125	225	325	425	525	625	725	825	925
H	48	63	63	48	63	63	48	63	63
M	1	2	3	3	4	5	6	7	8
N	1	2	3	3	4	5	6	7	8
Y	2	3	4	4	5	6	7	8	9
Z	2	3	4	4	5	6	7	8	9
Weight (kg)	1.9	2.3	2.7	3	3.4	3.8	4.2	4.5	4.9

List of attachments

[Motor mounting parts]

Mounted motor specification	Pulley	Motor mounting plate fixing bolt	Motor mounting bolt	
			Size	Quantity
M	Included at shipment	Included at shipment	M4	4
Y			M4	4
P			M3	4

[Origin sensor, limit sensor]

Manufacturer	Model	Included quantity
OMRON Corporation	EE-SX674	3

*Refer to page 512 for sensor specifications.

Dimensions Motor left-side mounting

● EKS-04LL

Mounted motor specification	J	K	U	V
M	M4 × L10	M4	M4-2L	46
Y	M4 × L10	M4	M4-2L	46
P	M3 × L10	M3	M3-2L	45

4-J, U (Motor fixing bolt, conical spring washer) Motor mounting plate (attachment) (attachment)

Motor (Customers are asked to prepare as necessary.)

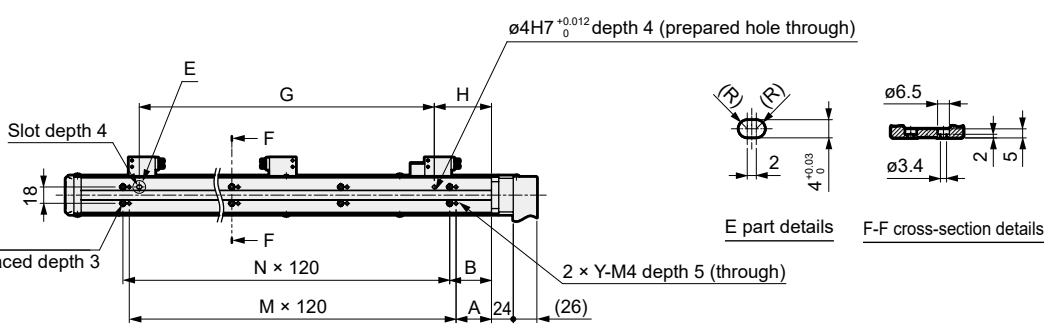
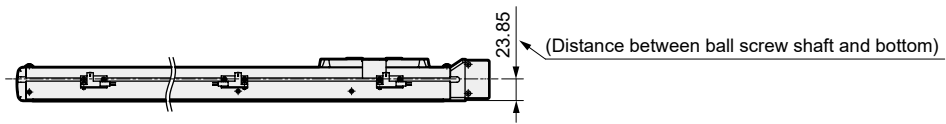
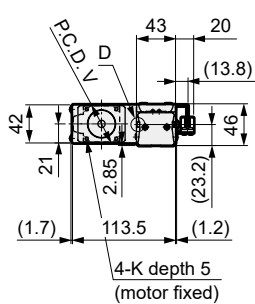
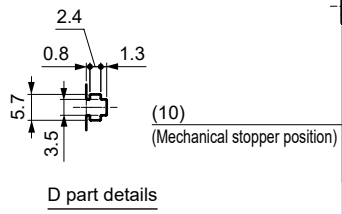
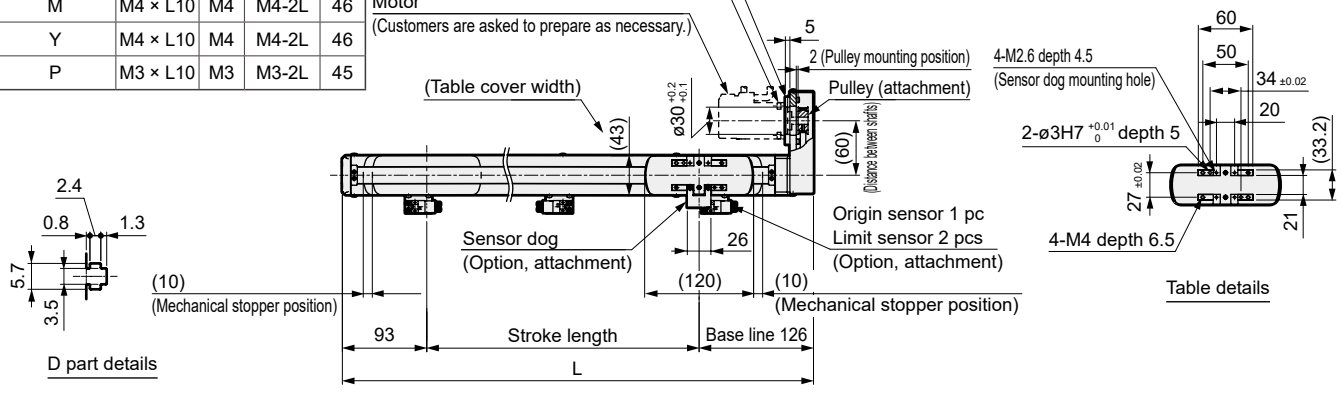

Stroke code	0100	0200	0300	0400	0500	0600	0700	0800	0900
Stroke length (mm)	100	200	300	400	500	600	700	800	900
L	319	419	519	619	719	819	919	1019	1119
A	59	42	39	89	79	69	59	42	39
B	66	56	46	96	86	76	66	56	46
G	125	225	325	425	525	625	725	825	925
H	48	63	63	48	63	63	48	63	63
M	1	2	3	3	4	5	6	7	8
N	1	2	3	3	4	5	6	7	8
Y	2	3	4	4	5	6	7	8	9
Z	2	3	4	4	5	6	7	8	9
Weight (kg)	1.9	2.3	2.7	3	3.4	3.8	4.2	4.5	4.9

List of attachments

[Motor mounting parts]

Mounted motor specification	Pulley	Motor mounting plate fixing bolt	Motor mounting bolt	
			Size	Quantity
M	Included at shipment	Included at shipment	M4	4
Y			M4	4
P			M3	4

[Origin sensor, limit sensor]

Manufacturer	Model	Included quantity
OMRON Corporation	EE-SX674	3

*Refer to page 512 for sensor specifications.

Common options

Dimensions for straight motor mounting

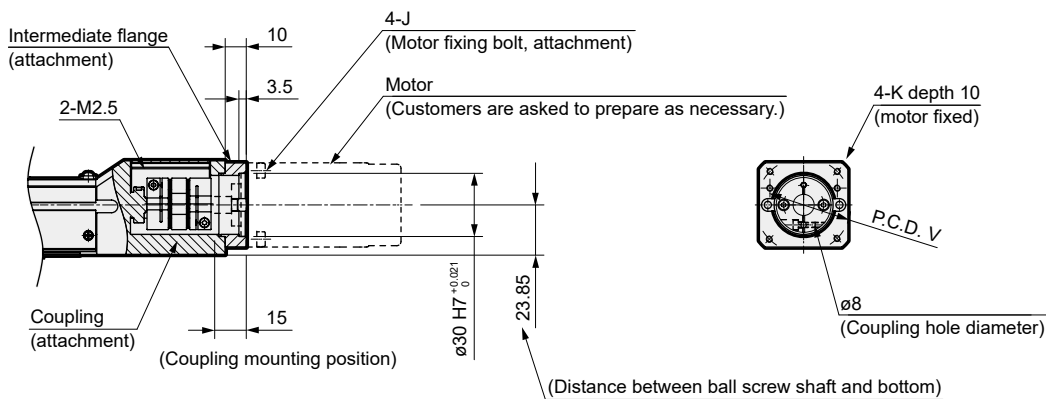

Motor mounting part details

Mounted motor specification	J	K	V
M	M4 × L10	M4	46
Y	M4 × L10	M4	46
P	M3 × L10	M3	45

For motor mounting on side/bottom

Motor shaft fixing method

Pulley (attachment)

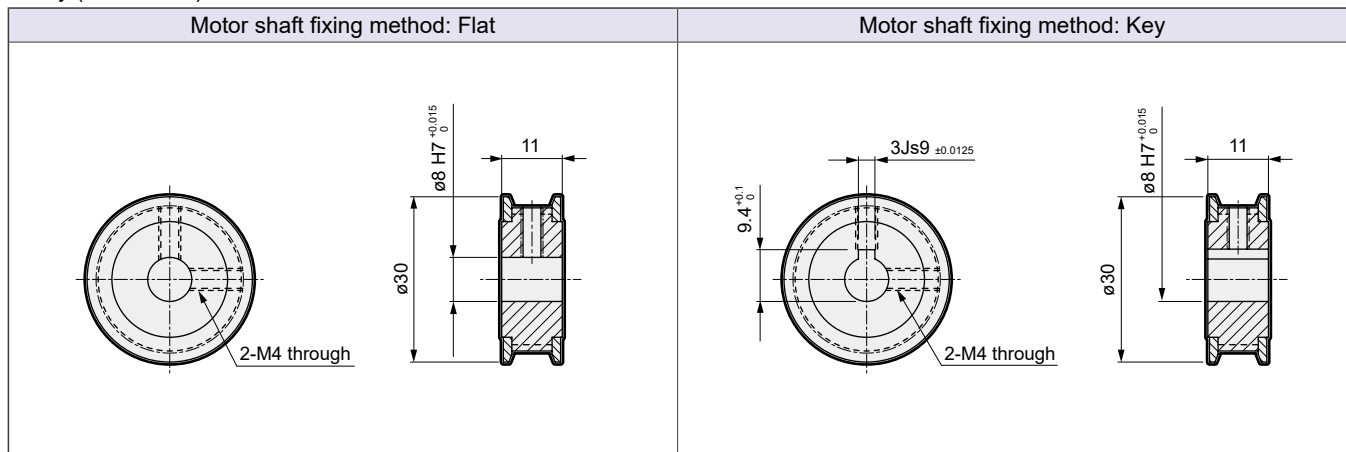

MEMO

Servo motor compatible						Stepper motor compatible					
EBS	EBR	ETS	ETS Multi-Axis	ECS	ETV	ECV	EKS	EBS	EBR	ETS	ECS

Safety precautions



Electric actuator (motorless) Slider

EKS-05LE

Straight motor mounting

● Servo motor capacity: 100 W

How to order

EKS - 05 L E - 10 0300 N NN - M 1 N C B

A Body size 05 Body width 53 mm	B Motor L None	C Motor mounting direction E Straight mounting	D Screw lead 10 10 mm 20 20 mm	E Stroke length *1 0100 100 mm to (In 100 mm increments) 0900 900 mm	F Brake N None	G Mounted motor specification M Select the mounted motor specification from the table at right. Y P	H Motor capacity 1 100 W	I Motor shaft fixing method N For straight mounting	J Origin sensor *2 N None C Yes	K Limit sensor *2 N None B Yes
---	--------------------------	--	---	--	--------------------------	---	------------------------------------	---	--	---

Manufacturer	100 W
Mitsubishi Electric Corporation	M
Delta Electronics Co., Ltd.	M
Sanyo Denki Co., Ltd.	M
YASKAWA Electric Corporation	Y
Keyence Corporation	Y
Panasonic Corporation	P
OMRON Corporation	M
Fuji Electric Co., Ltd.	M
FANUC CORPORATION	M
Bosch Rexroth AG	P
Rockwell Automation, Inc.	M
SIEMENS AG	M

*1: For the stroke length per 50 mm, contact CKD.

*2: Origin sensor and limit sensor are available as a set. As it is both-or-nothing, select "None" for both.

*Refer to page 461 for the motor model No.

Specifications

Applicable motor capacity	100 W servo motor	
Drive method	Ball screw ϕ 13	
Stroke length mm	100 to 900	
Screw lead mm	10	20
Max. load capacity kg *1 *2	Horizontal	7.5
	Wall-mounted	7.5
	Vertical	6
Max. speed mm/s	500	1000
Rated thrust *2 N	179	89
Repeatability mm	\pm 0.01	
Lost motion mm	0.1 or less	
Static allowable load N	3100	
Static allowable moment N·m	MP: 147, MY: 147, MR: 149	
Operating ambient temperature, humidity	0 to 40°C (no freezing) 20 to 80% RH (no condensation)	
Storage ambient temperature, humidity	0 to 40°C (no freezing) 20 to 80% RH (no condensation)	
Atmosphere	No corrosive gas, explosive gas, or dust	

*1: Values for max. load capacity are at acceleration/deceleration 0.5 G. Refer to page 510 for details.

*2: Rated thrust and max. load capacity are guideline values assuming that the motor mounted will output the rated torque.

Stroke and max. speed

Screw lead \ Stroke length	(mm/s)			
	100 to 600	700	800	900
10	500	390	310	250
20	1000	780	620	500

*The max. speed is the speed when the motor mounted by the customer can output a rotation speed of 3000 rpm.

The max. speed is restricted by the stroke. Do not move at speeds beyond the limit.

Allowable overhang length

*Refer to page 504 for details.

Moment direction

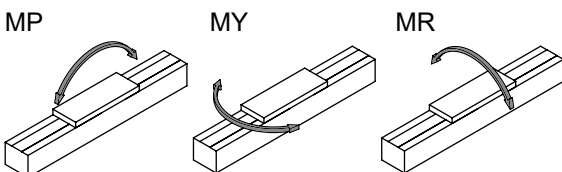

Safety precautions

Dimensions Straight motor mounting

● EKS-05LE

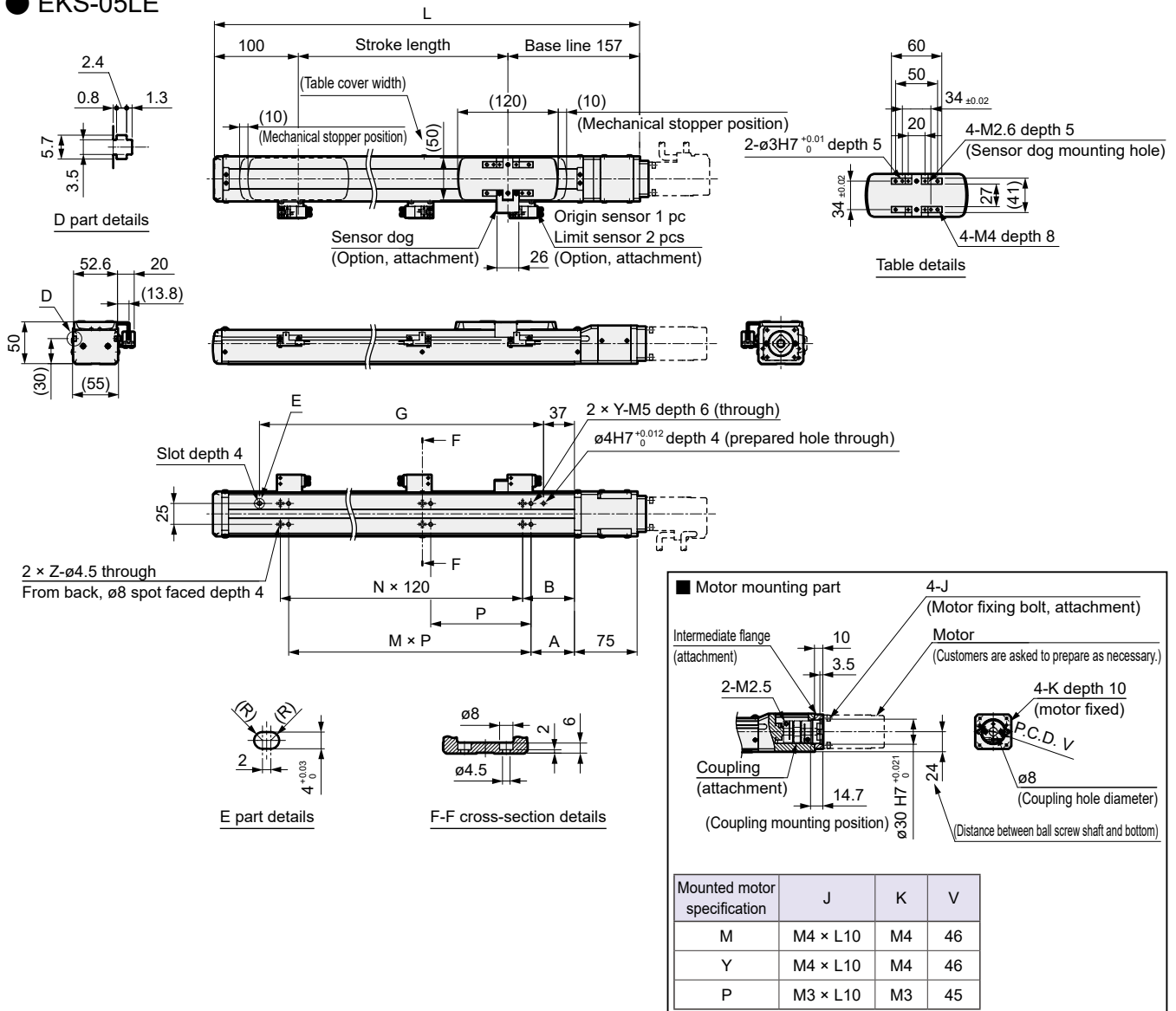

Stroke code	0100	0200	0300	0400	0500	0600	0700	0800	0900
Stroke length (mm)	100	200	300	400	500	600	700	800	900
L	357	457	557	657	757	857	957	1057	1157
A	12	52	27	92	82	72	62	52	27
B	72	62	52	102	92	82	72	62	52
G	190	290	390	490	590	690	790	890	990
M	2	2	3	3	4	5	6	7	8
N	1	2	3	3	4	5	6	7	8
P	120								
Y	3	3	4	4	5	6	7	8	9
Z	2	3	4	4	5	6	7	8	9
Weight (kg)	2.6	3.1	3.7	4.2	4.8	5.4	5.9	6.5	7

List of attachments

[Motor mounting parts]

Mounted motor specification	Coupling	Intermediate flange fixing bolt	Motor mounting bolt	
			Size	Quantity
M	Included at shipment	Included at shipment	M4	4
Y			M4	4
P			M3	4

[Origin sensor, limit sensor]

Manufacturer	Model	Included quantity
OMRON Corporation	EE-SX674	3

*Refer to page 512 for sensor specifications.



Electric actuator (motorless) Slider

EKS-05L*

Motor side mounting (left, right, bottom)

● Servo motor capacity: 100 W

How to order

EKS - 05 L R - 10 0300 N NN - M 1 D C B

A Body size 05 Body width 53 mm	B Motor L None	C Motor mounting direction R Right mounting D Bottom mounting L Left mounting	D Screw lead 10 10 mm 20 20 mm	E Stroke length *1 0100 100 mm to (In 100 mm increments) 0900 900 mm	F Brake N None	G Mounted motor specification M Select the mounted motor specification from the table at right. Y P	H Motor capacity 1 100 W	I Motor shaft fixing method D Flat K Key	J Origin sensor *2 N None C Yes	K Limit sensor *2 N None B Yes
---	--------------------------	---	---	--	--------------------------	---	------------------------------------	---	--	---

Manufacturer	100 W
Mitsubishi Electric Corporation	M
Delta Electronics Co., Ltd.	M
Sanyo Denki Co., Ltd.	M
YASKAWA Electric Corporation	Y
Keyence Corporation	Y
Panasonic Corporation	P
OMRON Corporation	M
Fuji Electric Co., Ltd.	M
FANUC CORPORATION	M
Bosch Rexroth AG	P
Rockwell Automation, Inc.	M
SIEMENS AG	M

*1: For the stroke length per 50 mm, contact CKD.

*2: Origin sensor and limit sensor are available as a set. As it is both-or-nothing, select "None" for both.

*Refer to page 461 for the motor model No.

Specifications

Applicable motor capacity	100 W servo motor	
Drive method	Ball screw ϕ 13	
Stroke length mm	100 to 900	
Screw lead mm	10	20
Max. load capacity kg *1 *2	Horizontal	7.5
	Wall-mounted	7.5
	Vertical	5
Max. speed mm/s	500	1000
Rated thrust *2 N	179	89
Repeatability mm	\pm 0.01	
Lost motion mm	0.1 or less	
Static allowable load N	3100	
Static allowable moment N·m	MP: 147, MY: 147, MR: 149	
Operating ambient temperature, humidity	0 to 40°C (no freezing) 20 to 80% RH (no condensation)	
Storage ambient temperature, humidity	0 to 40°C (no freezing) 20 to 80% RH (no condensation)	
Atmosphere	No corrosive gas, explosive gas, or dust	

*1: Values for max. load capacity are at acceleration/deceleration 0.5 G. Refer to page 510 for details.

*2: Rated thrust and max. load capacity are guideline values assuming that the motor mounted will output the rated torque.

Stroke and max. speed

Stroke length Screw lead	(mm/s)			
	100 to 600	700	800	900
10	500	390	310	250
20	1000	780	620	500

*The max. speed is the speed when the motor mounted by the customer can output a rotation speed of 3000 rpm.
The max. speed is restricted by the stroke. Do not move at speeds beyond the limit.

Allowable overhang length

*Refer to page 504 for details.

Moment direction

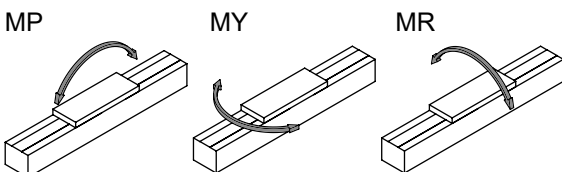

Dimensions Motor left-side mounting

● EKS-05LL

Mounted motor specification	J	K	V	V
M	M4 × L10	M4	M4-2L	46
Y	M4 × L10	M4	M4-2L	46
P	M3 × L10	M3	M3-2L	45

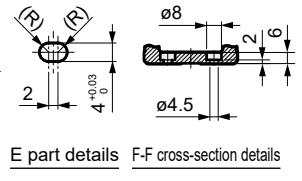
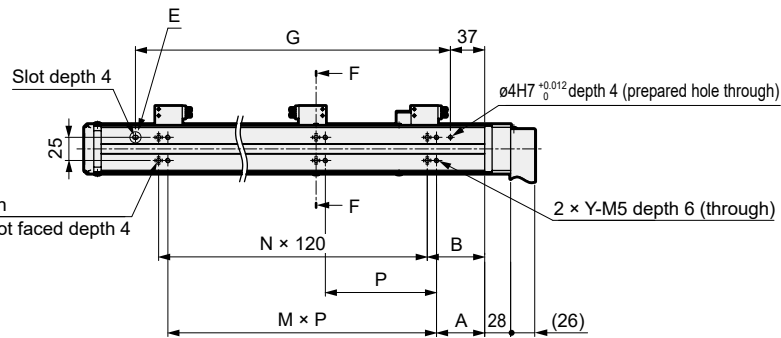
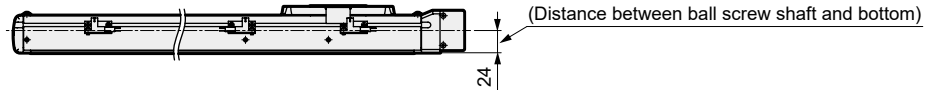
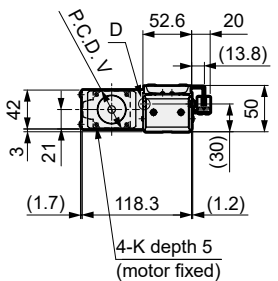
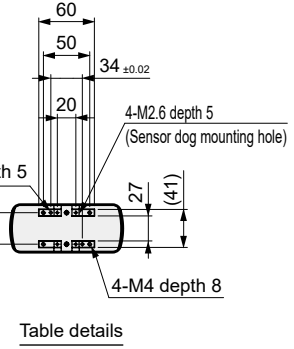
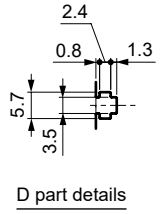
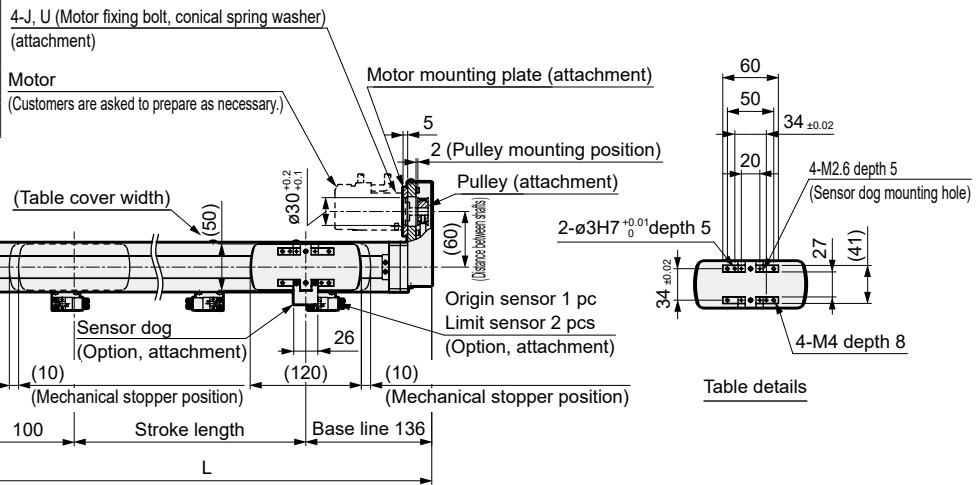

Stroke code	0100	0200	0300	0400	0500	0600	0700	0800	0900
Stroke length (mm)	100	200	300	400	500	600	700	800	900
L	336	436	536	636	736	836	936	1036	1136
A	12	52	27	92	82	72	62	52	27
B	72	62	52	102	92	82	72	62	52
G	190	290	390	490	590	690	790	890	990
M	2	2	3	3	4	5	6	7	8
N	1	2	3	3	4	5	6	7	8
P	120								
Y	3	3	4	4	5	6	7	8	9
Z	2	3	4	4	5	6	7	8	9
Weight (kg)	2.7	3.3	3.8	4.4	4.9	5.5	6	6.6	7.2

List of attachments

[Motor mounting parts]

Mounted motor specification	Pulley	Motor mounting plate fixing bolt	Motor mounting bolt	
			Size	Quantity
M	Included at shipment	Included at shipment	M4	4
Y			M4	4
P			M3	4

[Origin sensor, limit sensor]

Manufacturer	Model	Included quantity
OMRON Corporation	EE-SX674	3

*Refer to page 512 for sensor specifications.

Common options

Dimensions for straight motor mounting

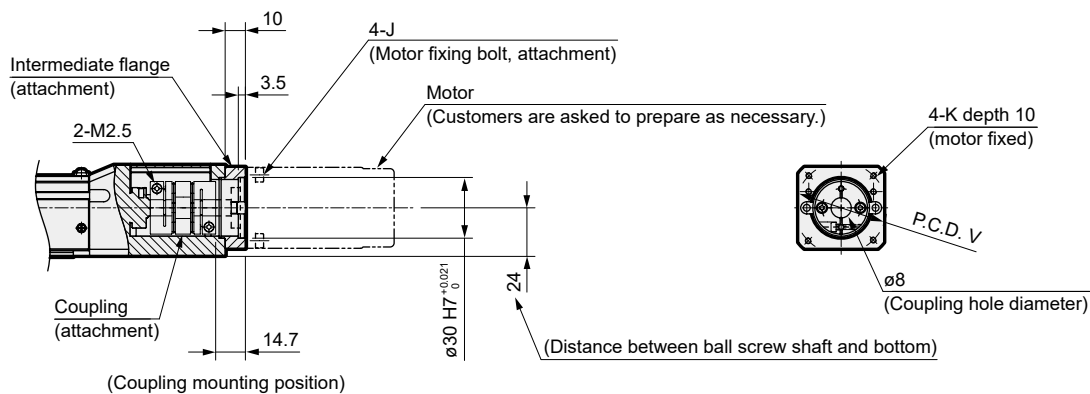

Motor mounting part details

Mounted motor specification	J	K	V
M	M4 × L10	M4	46
Y	M4 × L10	M4	46
P	M3 × L10	M3	45

For motor mounting on side/bottom

Motor shaft fixing method

Pulley (attachment)

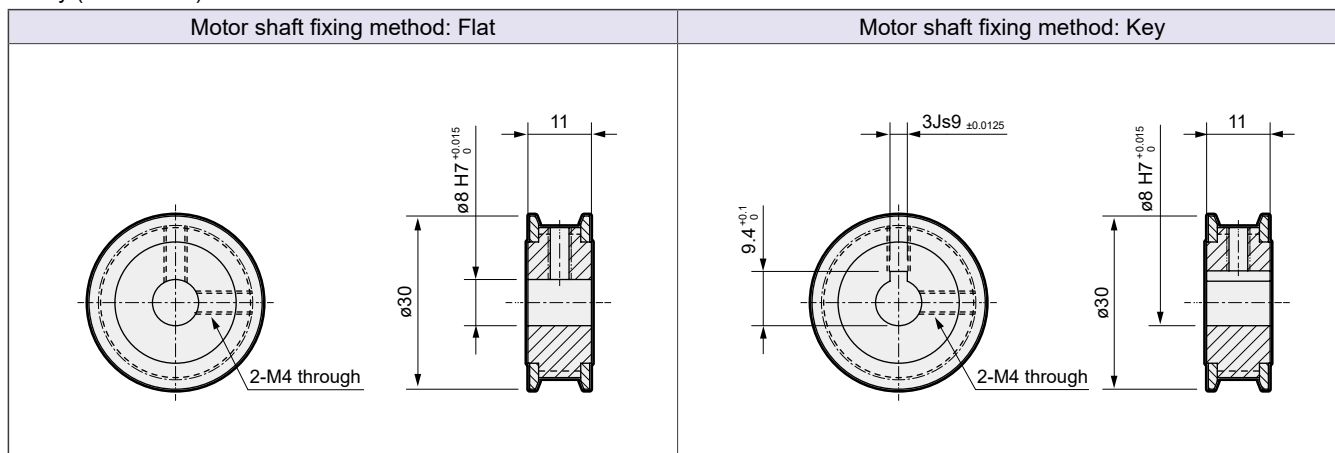

MEMO

Servo motor compatible						Stepper motor compatible					
EBS	EBR	ETS	ETS Multi-Axis	ECS	ETV	ECV	EKS	EBS	EBR	ETS	ECS

Safety precautions



Electric actuator (motorless) Slider

EKS-06LE

Straight motor mounting

● Servo motor capacity: 200 W

How to order

EKS - 06 L E - 20 0300 N NN - M 2 N C B

A Body size 06 Body width 64 mm	B Motor L None	C Motor mounting direction E Straight mounting	D Screw lead 20 20 mm 30 30 mm	E Stroke length *1 0100 100 mm to (In 100 mm increments) 1300 1300 mm	F Brake N None	G Mounted motor specification M Select the mounted motor Y specification from the table at right. P	H Motor capacity 2 200 W	I Motor shaft fixing method N For straight mounting	J Origin sensor *2 N None C Yes	K Limit sensor *2 N None B Yes
---	--------------------------	--	---	---	--------------------------	--	------------------------------------	---	--	---

Manufacturer	200 W
Mitsubishi Electric Corporation	M
Delta Electronics Co., Ltd.	M
Sanyo Denki Co., Ltd.	M
YASKAWA Electric Corporation	Y
Keyence Corporation	Y
Panasonic Corporation	P
OMRON Corporation	P
Fuji Electric Co., Ltd.	M
Bosch Rexroth AG	P
Rockwell Automation, Inc.	M
SIEMENS AG	M

*1: For the stroke length per 50 mm, contact CKD.

*2: Origin sensor and limit sensor are available as a set. As it is both-or-nothing, select "None" for both.

*Refer to page 461 for the motor model No.

Specifications

Applicable motor capacity	200 W servo motor	
Drive method	Ball screw $\phi 15$	
Stroke length	mm 100 to 1300	
Screw lead	mm 20	30
Max. load capacity kg *1 *2	Horizontal	42
	Wall-mounted	20
	Vertical	12
Max. speed	mm/s 1000	1500
Rated thrust *2	N 180	120
Repeatability	mm ± 0.01	
Lost motion	mm 0.1 or less	
Static allowable load	N 3250	
Static allowable moment	N·m MP: 330, MY: 216, MR: 188	
Operating ambient temperature, humidity	0 to 40°C (no freezing) 20 to 80% RH (no condensation)	
Storage ambient temperature, humidity	0 to 40°C (no freezing) 20 to 80% RH (no condensation)	
Atmosphere	No corrosive gas, explosive gas, or dust	

*1: Values for max. load capacity are at acceleration/deceleration 0.5 G. Refer to page 510 for details.

*2: Rated thrust and max. load capacity are guideline values assuming that the motor mounted will output the rated torque.

Stroke and max. speed

Stroke length \ Screw lead	(mm/s)							
	100 up 600	700	800	900	1000	1100	1200	1300
20	1000	980	770	630	520	430	370	320
30	1500	1480	1160	940	780	650	550	480

*The max. speed is the speed when the motor mounted by the customer can output a rotation speed of 3000 rpm. The max. speed is restricted by the stroke. Do not move at speeds beyond the limit.

Allowable overhang length

*Refer to page 504 for details.

Moment direction

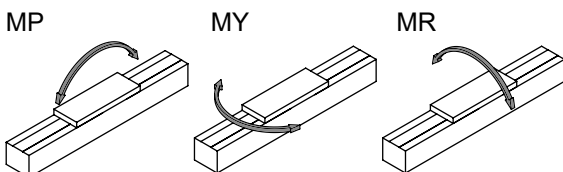

Safety precautions

EBS
 EBR
 ETS
 ETS Multi-Axis
 ECS
 ETV
 ECV
 EKS
 EBS
 EBR
 ETS
 ECS

Servo motor compatible
 Stepper motor compatible
 Safety precautions

Dimensions Straight motor mounting

● EKS-06LE

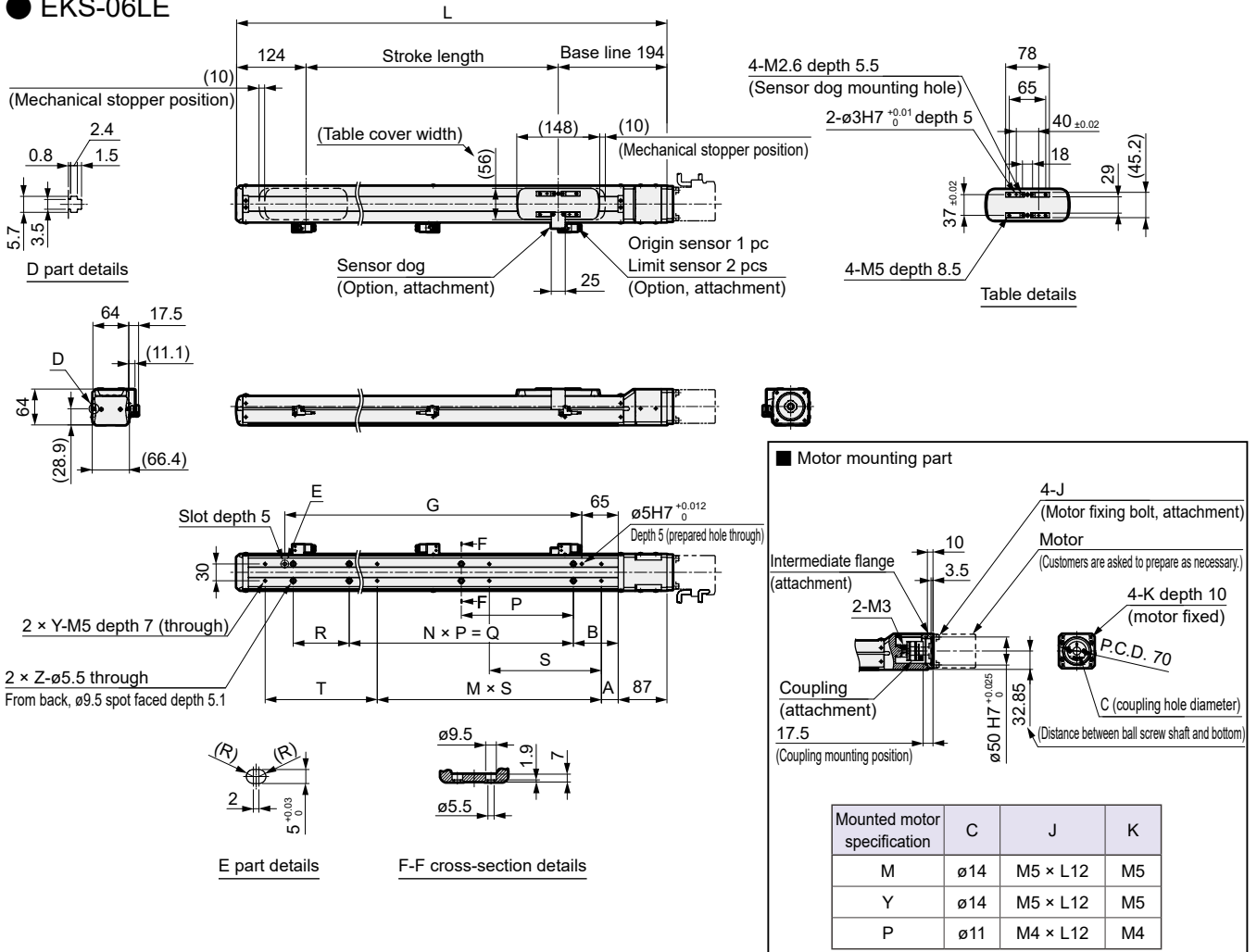

Stroke code	0100	0200	0300	0400	0500	0600	0700	0800	0900	1000	1100	1200	1300
Stroke length (mm)	100	200	300	400	500	600	700	800	900	1000	1100	1200	1300
L	418	518	618	718	818	918	1018	1118	1218	1318	1418	1518	1618
A	55	55	55	55	55	55	55	55	55	55	55	55	55
B	105	105	105	105	105	105	105	105	105	105	105	105	105
G	180	280	380	480	580	680	780	880	980	1080	1180	1280	1380
M	2	1	2	2	3	3	4	4	5	5	6	6	7
N	-	-	-	2	2	3	3	4	4	5	5	6	6
P	100	200											
Q	-	-	-	400	400	600	600	800	800	1000	1000	1200	1200
R	-	-	100	-	100	-	100	-	100	-	100	-	100
S	100	200											
T	-	100	-	100	-	100	-	100	-	100	-	100	-
Y	3	3	3	4	4	5	5	6	6	7	7	8	8
Z	2	2	3	3	4	4	5	5	6	6	7	7	8
Weight (kg)	4.3	5.1	5.8	6.6	7.4	8.2	8.9	9.7	10.5	11.3	12	12.8	13.6

List of attachments

[Motor mounting parts]

Mounted motor specification	Coupling	Intermediate flange fixing bolt	Motor mounting bolt	
			Size	Quantity
M	Included at shipment	Included at shipment	M5	4
Y			M5	4
P			M4	4

[Origin sensor, limit sensor]

Manufacturer	Model	Included quantity
OMRON Corporation	EE-SX674	3

*Refer to page 512 for sensor specifications.



Electric actuator (motorless) Slider

EKS-06L*

Motor side mounting (left, right, bottom)

● Servo motor capacity: 200 W

How to order

EKS - 06 L R - 20 0300 N NN - M 2 D C B

A Body size 06 Body width 64 mm	B Motor L None	C Motor mounting direction R Right mounting D Bottom mounting L Left mounting	D Screw lead 20 20 mm 30 30 mm	E Stroke length *1 0100 100 mm to (In 100 mm increments) 1300 1300 mm	F Brake N None	G Mounted motor specification M Select the mounted motor specification from the table at right. Y P	H Motor capacity 2 200 W	I Motor shaft fixing method D Flat K Key M Friction locking	J Origin sensor *2 N None C Yes	K Limit sensor *2 N None B Yes
---	--------------------------	---	---	---	--------------------------	---	------------------------------------	---	--	---

Manufacturer	200 W
Mitsubishi Electric Corporation	M
Delta Electronics Co., Ltd.	M
Sanyo Denki Co., Ltd.	M
YASKAWA Electric Corporation	Y
Keyence Corporation	Y
Panasonic Corporation	P
OMRON Corporation	P
Fuji Electric Co., Ltd.	M
Bosch Rexroth AG	P
Rockwell Automation, Inc.	M
SIEMENS AG	M

*1: For the stroke length per 50 mm, contact CKD.

*2: Origin sensor and limit sensor are available as a set. As it is both-or-nothing, select "None" for both.

*Refer to page 461 for the motor model No.

Specifications

Applicable motor capacity	200 W servo motor	
Drive method	Ball screw $\phi 15$	
Stroke length	mm 100 to 1300	
Screw lead	mm 20	30
Max. load capacity kg *1 *2	Horizontal	41
	Wall-mounted	20
	Vertical	10.5
Max. speed	mm/s 1000	1500
Rated thrust *2	N 180	120
Repeatability	mm ± 0.01	
Lost motion	mm 0.1 or less	
Static allowable load	N 3250	
Static allowable moment	N·m MP: 330, MY: 216, MR: 188	
Operating ambient temperature, humidity	0 to 40°C (no freezing) 20 to 80% RH (no condensation)	
Storage ambient temperature, humidity	0 to 40°C (no freezing) 20 to 80% RH (no condensation)	
Atmosphere	No corrosive gas, explosive gas, or dust	

*1: Values for max. load capacity are at acceleration/deceleration 0.5 G. Refer to page 510 for details.

*2: Rated thrust and max. load capacity are guideline values assuming that the motor mounted will output the rated torque.

Stroke and max. speed

Stroke length \ Screw lead	(mm/s)						
	100 to 600	700	800	900	1000	1100	1200 1300
20	1000	980	770	630	520	430	370 320
30	1500	1480	1160	940	780	650	550 480

*The max. speed is the speed when the motor mounted by the customer can output a rotation speed of 3000 rpm. The max. speed is restricted by the stroke. Do not move at speeds beyond the limit.

Allowable overhang length

*Refer to page 504 for details.

Moment direction

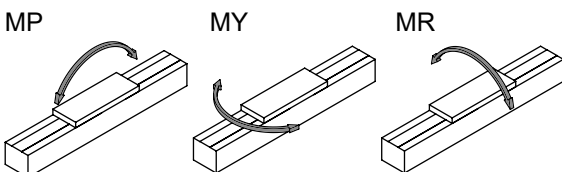

Safety precautions

Dimensions Motor right-side mounting

● EKS-06LR

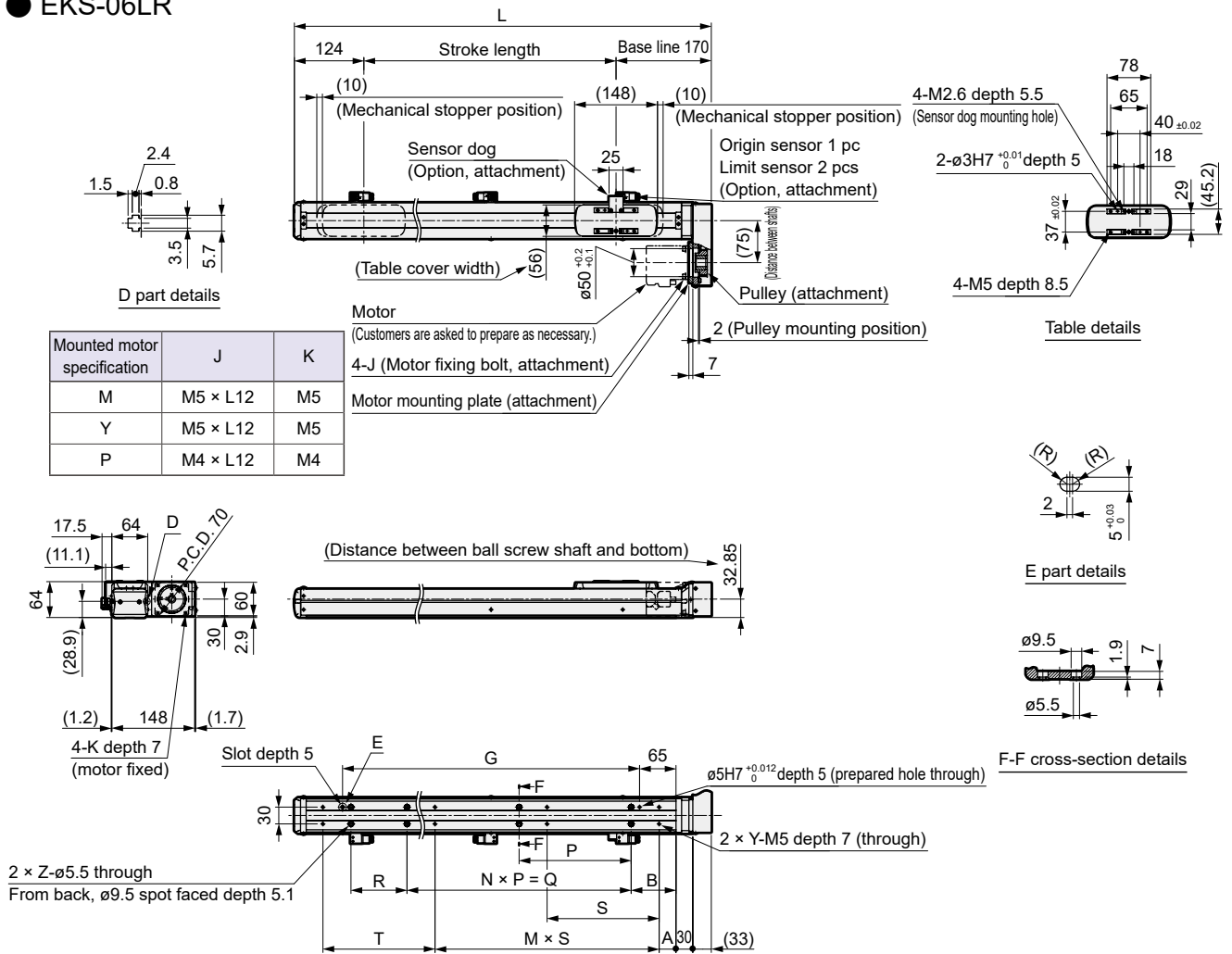

Stroke code	0100	0200	0300	0400	0500	0600	0700	0800	0900	1000	1100	1200	1300
Stroke length (mm)	100	200	300	400	500	600	700	800	900	1000	1100	1200	1300
L	394	494	594	694	794	894	994	1094	1194	1294	1394	1494	1594
A	55	55	55	55	55	55	55	55	55	55	55	55	55
B	105	105	105	105	105	105	105	105	105	105	105	105	105
G	180	280	380	480	580	680	780	880	980	1080	1180	1280	1380
M	2	1	2	2	3	3	4	4	5	5	6	6	7
N	-	-	-	2	2	3	3	4	4	5	5	6	6
P	100	200											
Q	-	-	-	400	400	600	600	800	800	1000	1000	1200	1200
R	-	-	100	-	100	-	100	-	100	-	100	-	100
S	100	200											
T	-	100	-	100	-	100	-	100	-	100	-	100	-
Y	3	3	3	4	4	5	5	6	6	7	7	8	8
Z	2	2	3	3	4	4	5	5	6	6	7	7	8
Weight (kg)	4.9	5.6	6.4	7.2	8	8.7	9.5	10.3	11.1	11.8	12.6	13.4	14.2

List of attachments

[Motor mounting parts]

Mounted motor specification	Pulley	Motor mounting plate fixing bolt	Motor mounting bolt	
			Size	Quantity
M	Included at shipment	Included at shipment	M5	4
Y			M5	4
P			M4	4

[Origin sensor, limit sensor]

Manufacturer	Model	Included quantity
OMRON Corporation	EE-SX674	3

*Refer to page 512 for sensor specifications.

EBS
EBR
ETS
ETS Multi-Axis
ECS
ETV
ECV
EKS

Stepper motor compatible
EBS
EBR
ETS
ECS

Safety
Precautions

EKS-06L*

Dimensions Motor bottom mounting

● EKS-06LD

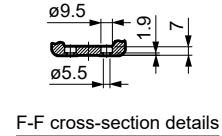
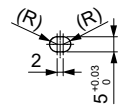
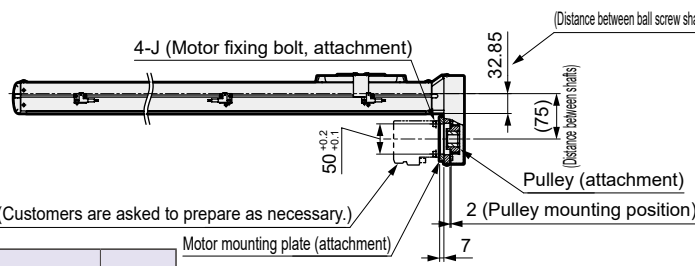
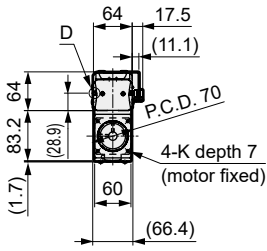
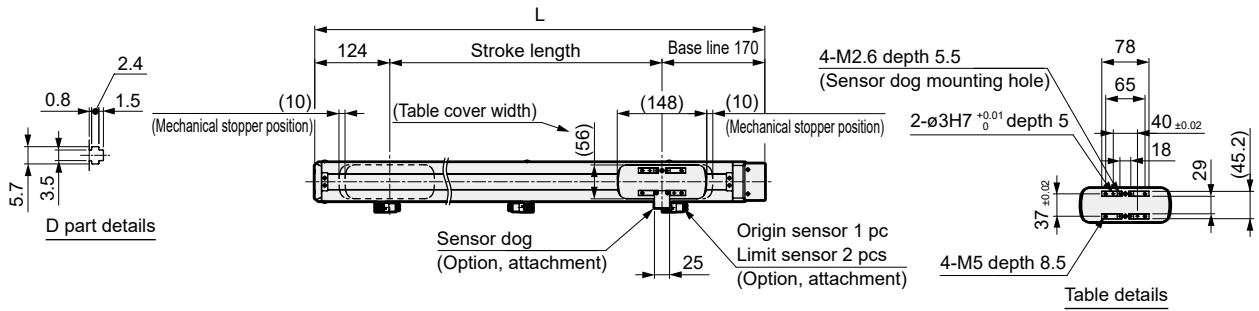

Mounted motor specification	J	K
M	M5 × L12	M5
Y	M5 × L12	M5
P	M4 × L12	M4

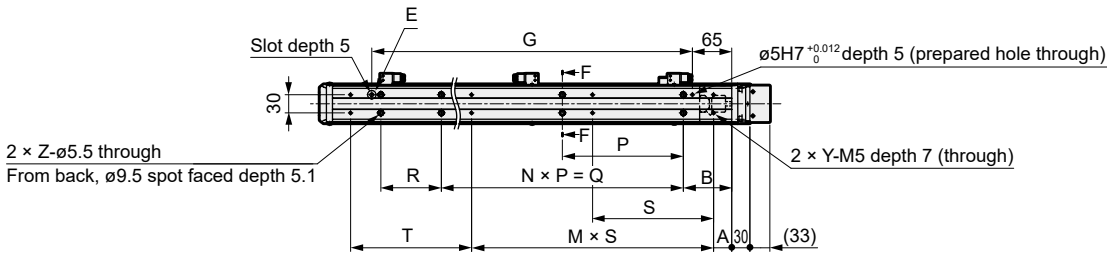

Stroke code	0100	0200	0300	0400	0500	0600	0700	0800	0900	1000	1100	1200	1300
Stroke length (mm)	100	200	300	400	500	600	700	800	900	1000	1100	1200	1300
L	394	494	594	694	794	894	994	1094	1194	1294	1394	1494	1594
A	55	55	55	55	55	55	55	55	55	55	55	55	55
B	105	105	105	105	105	105	105	105	105	105	105	105	105
G	180	280	380	480	580	680	780	880	980	1080	1180	1280	1380
M	2	1	2	2	3	3	4	4	5	5	6	6	7
N	-	-	-	2	2	3	3	4	4	5	5	6	6
P	100	200											
Q	-	-	-	400	400	600	600	800	800	1000	1000	1200	1200
R	-	-	100	-	100	-	100	-	100	-	100	-	100
S	100	200											
T	-	100	-	100	-	100	-	100	-	100	-	100	-
Y	3	3	3	4	4	5	5	6	6	7	7	8	8
Z	2	2	3	3	4	4	5	5	6	6	7	7	8
Weight (kg)	4.9	5.6	6.4	7.2	8	8.7	9.5	10.3	11.1	11.8	12.6	13.4	14.2

List of attachments

[Motor mounting parts]

Mounted motor specification	Pulley	Motor mounting plate fixing bolt	Motor mounting bolt	
			Size	Quantity
M	Included at shipment	Included at shipment	M5	4
Y			M5	4
P			M4	4

[Origin sensor, limit sensor]

Manufacturer	Model	Included quantity
OMRON Corporation	EE-SX674	3

*Refer to page 512 for sensor specifications.

Dimensions Motor left-side mounting

● EKS-06LL

Mounted motor specification	J	K
M	M5 × L12	M5
Y	M5 × L12	M5
P	M4 × L12	M4

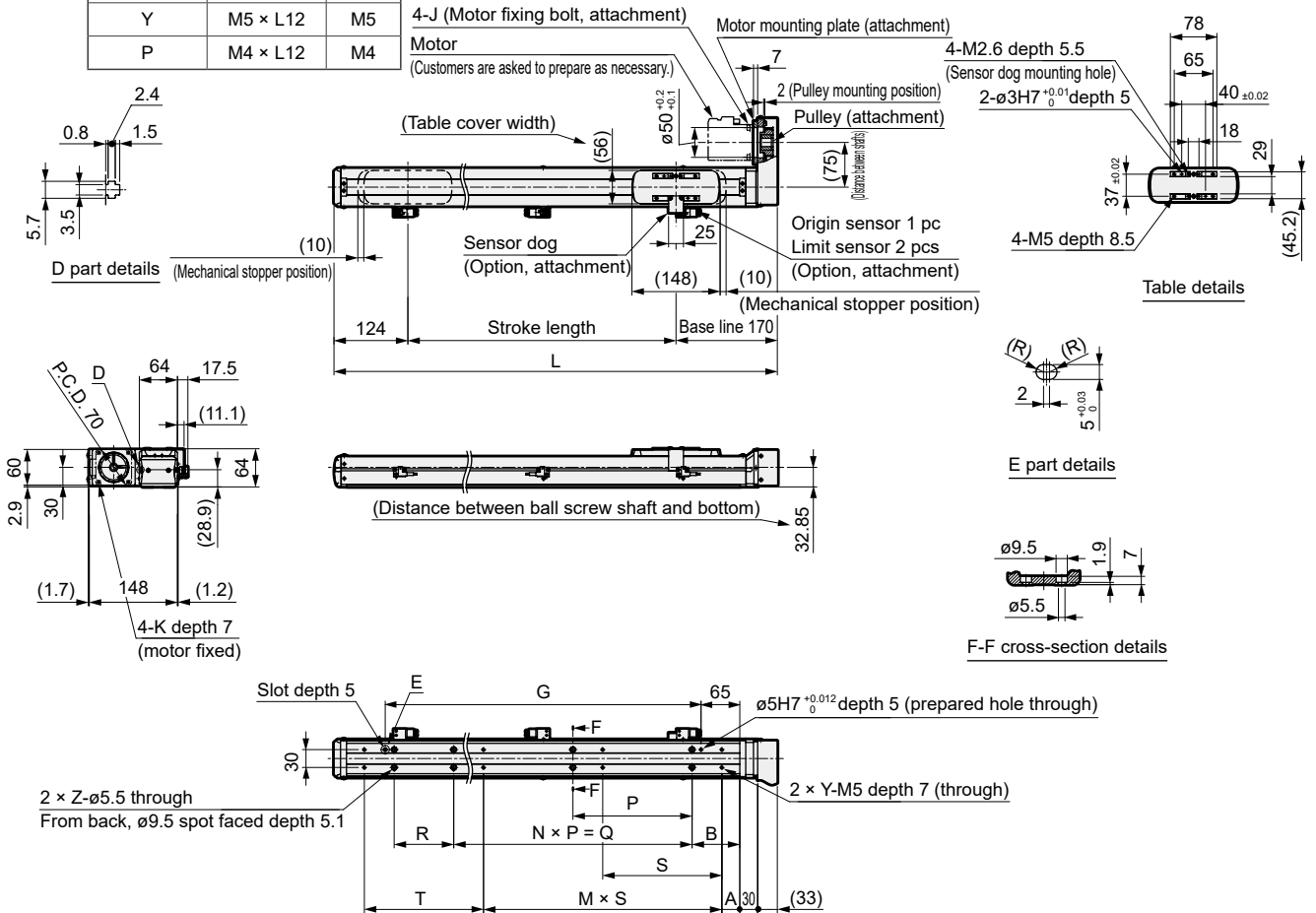

Stroke code	0100	0200	0300	0400	0500	0600	0700	0800	0900	1000	1100	1200	1300
Stroke length (mm)	100	200	300	400	500	600	700	800	900	1000	1100	1200	1300
L	394	494	594	694	794	894	994	1094	1194	1294	1394	1494	1594
A	55	55	55	55	55	55	55	55	55	55	55	55	55
B	105	105	105	105	105	105	105	105	105	105	105	105	105
G	180	280	380	480	580	680	780	880	980	1080	1180	1280	1380
M	2	1	2	2	3	3	4	4	5	5	6	6	7
N	-	-	-	2	2	3	3	4	4	5	5	6	6
P	100	200											
Q	-	-	-	400	400	600	600	800	800	1000	1000	1200	1200
R	-	-	100	-	100	-	100	-	100	-	100	-	100
S	100	200											
T	-	100	-	100	-	100	-	100	-	100	-	100	-
Y	3	3	3	4	4	5	5	6	6	7	7	8	8
Z	2	2	3	3	4	4	5	5	6	6	7	7	8
Weight (kg)	4.9	5.6	6.4	7.2	8	8.7	9.5	10.3	11.1	11.8	12.6	13.4	14.2

List of attachments

[Motor mounting parts]

Mounted motor specification	Pulley	Motor mounting plate fixing bolt	Motor mounting bolt	
			Size	Quantity
M	Included at shipment	Included at shipment	M5	4
Y			M5	4
P			M4	4

[Origin sensor, limit sensor]

Manufacturer	Model	Included quantity
OMRON Corporation	EE-SX674	3

*Refer to page 512 for sensor specifications.

EBS

EBR

ETS

ETS Multi-Axis

ECS

ETV

ECV

EKS

EBS

EBR

ETS

ECS

ETS

Safety
Precautions

Common options

Dimensions for straight motor mounting

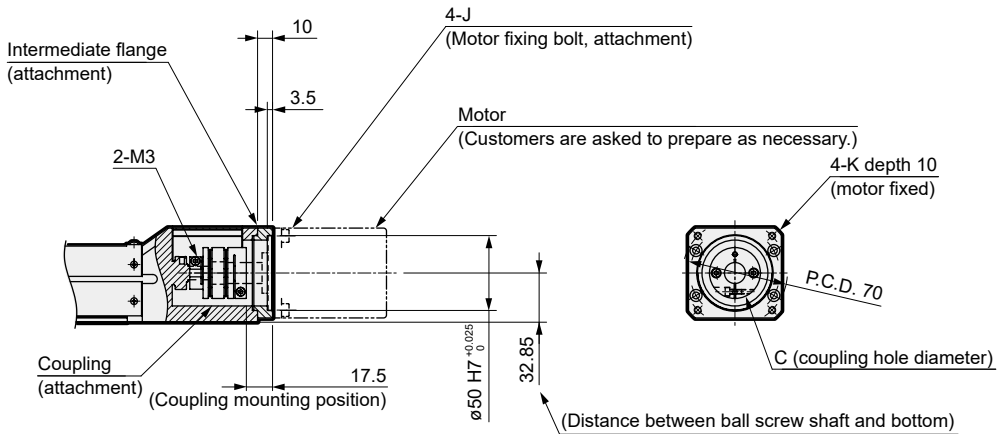

Motor mounting part details

Mounted motor specification	C	J	K
M	ø14	M5 × L12	M5
Y	ø14	M5 × L12	M5
P	ø11	M4 × L12	M4

For motor mounting on side/bottom

Motor shaft fixing method

Pulley (attachment)

	Mounted motor specification: M, Y Motor shaft fixing method: Key	Mounted motor specification: P Motor shaft fixing method: Key
	Motor shaft fixing method: Flat	Mounted motor specification: P Motor shaft fixing method: Friction locking
	<p>Mounted motor specification: For P Mounted motor specification: For M and Y</p>	

MEMO

Servo motor compatible						Stepper motor compatible					
EBS	EBR	ETS	ETS Multi-Axis	ECS	ETV	ECV	EKS	EBS	EBR	ETS	ECS

Safety precautions



Electric actuator (motorless) Slider

EKS-08LE

Straight motor mounting

● Servo motor capacity: 400 W

How to order

EKS - 08 L E - 20 0300 N NN - M 4 N C B

A Body size 08 Body width 84 mm	B Motor L None	C Motor mounting direction E Straight mounting	D Screw lead 20 20 mm 40 40 mm	E Stroke length 0100 100 mm to (In 100 mm increments) 1500 1500 mm	F Brake N None	G Mounted motor specification M Select the mounted motor Y specification from the table at right. P	H Motor capacity 4 400 W	I Motor shaft fixing method N For straight mounting	J Origin sensor *1 N None C Yes	K Limit sensor *1 N None B Yes
---	--------------------------	--	---	--	--------------------------	--	------------------------------------	---	--	---

Manufacturer	400 W
Mitsubishi Electric Corporation	M
Delta Electronics Co., Ltd.	M
Sanyo Denki Co., Ltd.	M
YASKAWA Electric Corporation	Y
Keyence Corporation	Y
Panasonic Corporation	P
OMRON Corporation	P
Fuji Electric Co., Ltd.	M
Bosch Rexroth AG	P
Rockwell Automation, Inc.	M
SIEMENS AG	M

*1: Origin sensor and limit sensor are available as a set. As it is both-or-nothing, select "None" for both.

*Refer to page 461 for the motor model No.

Specifications

Applicable motor capacity	400 W servo motor	
Drive method	Ball screw ø20	
Stroke length	mm 100 to 1500	
Screw lead	mm 20	40
Max. load capacity kg *1 *2	Horizontal	83.5 19
	Wall-mounted	45 19
	Vertical	23.5 10.5
Max. speed	mm/s 1000	2000
Rated thrust *2	N 359	179
Repeatability	mm ±0.01	
Lost motion	mm 0.1 or less	
Static allowable load	N 4000	
Static allowable moment N·m	MP: 730, MY: 437, MR: 387	
Operating ambient temperature, humidity	0 to 40°C (no freezing)	
	20 to 80% RH (no condensation)	
Storage ambient temperature, humidity	0 to 40°C (no freezing)	
	20 to 80% RH (no condensation)	
Atmosphere	No corrosive gas, explosive gas, or dust	

*1: Values for max. load capacity are at acceleration/deceleration 0.5 G. Refer to page 510 for details.

*2: Rated thrust and max. load capacity are guideline values assuming that the motor mounted will output the rated torque.

Stroke and max. speed

Screw lead \ Stroke length	(mm/s)								
	100 to 700	800	900	1000	1100	1200	1300	1400	1500
20	1000	980	800	670	560	480	420	360	320
40	2000	1970	1610	1340	1130	970	840	730	650

*The max. speed is the speed when the motor mounted by the customer can output a rotation speed of 3000 rpm. The max. speed is restricted by the stroke. Do not move at speeds beyond the limit.

Allowable overhang length

*Refer to page 504 for details.

Moment direction

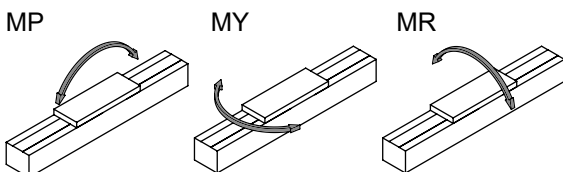

Servo motor compatible

Stepper motor compatible

Safety precautions

Dimensions Straight motor mounting

● EKS-08LE

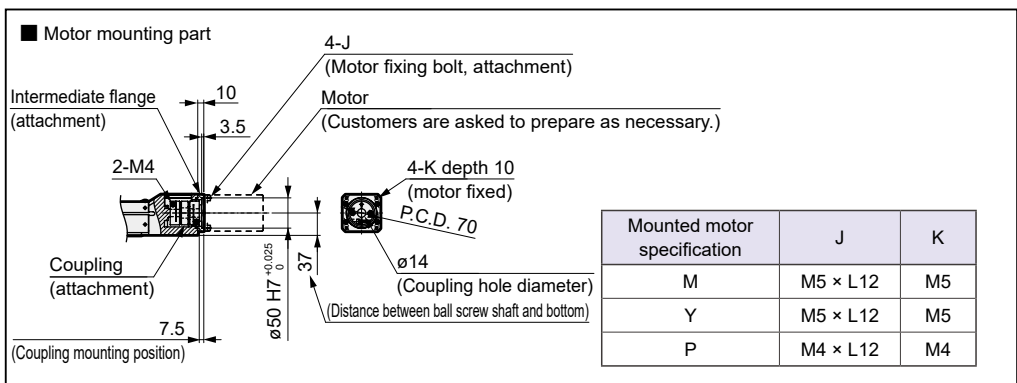
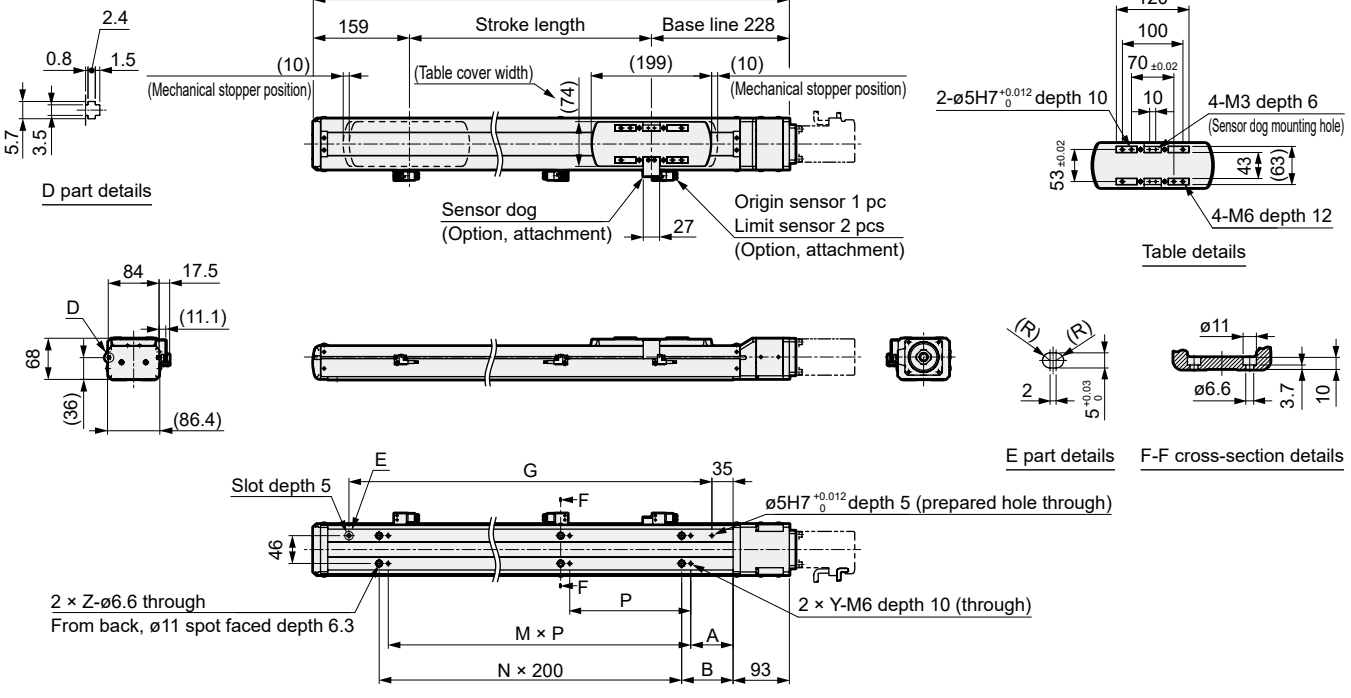

Stroke code	0100	0200	0300	0400	0500	0600	0700	0800	0900	1000	1100	1200	1300	1400	1500
Stroke length (mm)	100	200	300	400	500	600	700	800	900	1000	1100	1200	1300	1400	1500
L	487	587	687	787	887	987	1087	1187	1287	1387	1487	1587	1687	1787	1887
A	65	25	70	120	70	120	70	120	70	120	70	120	70	120	70
B	85	135	85	135	85	135	85	135	85	135	85	135	85	135	85
G	300	400	500	600	700	800	900	1000	1100	1200	1300	1400	1500	1600	1700
M	2	2	2	2	3	3	4	4	5	5	6	6	7	7	8
N	1	1	2	2	3	3	4	4	5	5	6	6	7	7	8
P	120	200													
Y	3	3	3	3	4	4	5	5	6	6	7	7	8	8	9
Z	2	2	3	3	4	4	5	5	6	6	7	7	8	8	9
Weight (kg)	8.1	9.4	10.7	12	13.3	14.6	15.9	17.2	18.5	19.8	21.1	22.4	23.7	25	26.3

List of attachments

[Motor mounting parts]

Mounted motor specification	Coupling	Intermediate flange fixing bolt	Motor mounting bolt	
			Size	Quantity
M	Included at shipment	Included at shipment	M5	4
Y			M5	4
P			M4	4

[Origin sensor, limit sensor]

Manufacturer	Model	Included quantity
OMRON Corporation	EE-SX674	3

*Refer to page 512 for sensor specifications.



Electric actuator (motorless) Slider

EKS-08L*

Motor side mounting (left, right, bottom)

● Servo motor capacity: 400 W

How to order

EKS - 08 L R - 20 0300 N NN - M 4 M C B

A Body size 08 Body width 84 mm	B Motor L None	C Motor mounting direction R Right mounting D Bottom mounting L Left mounting	D Screw lead 20 20 mm 40 40 mm	E Stroke length 0100 100 mm to (In 100 mm increments) 1500 1500 mm	F Brake N None	G Mounted motor specification M Select the mounted motor specification from the table at right. Y P	H Motor capacity 4 400 W	I Motor shaft fixing method M Friction locking	J Origin sensor *1 N None C Yes	K Limit sensor *1 N None B Yes
---	--------------------------	---	---	--	--------------------------	---	------------------------------------	--	--	---

Manufacturer	400 W
Mitsubishi Electric Corporation	M
Delta Electronics Co., Ltd.	M
Sanyo Denki Co., Ltd.	M
YASKAWA Electric Corporation	Y
Keyence Corporation	Y
Panasonic Corporation	P
OMRON Corporation	P
Fuji Electric Co., Ltd.	M
Bosch Rexroth AG	P
Rockwell Automation, Inc.	M
SIEMENS AG	M

*1 Origin sensor and limit sensor are available as a set. As it is both-or-nothing, select "None" for both.

*Refer to page 461 for the motor model No.

Specifications

Applicable motor capacity	400 W servo motor	
Drive method	Ball screw ø20	
Stroke length mm	100 to 1500	
Screw lead mm	20	40
Max. load capacity kg *1 *2	Horizontal	79.5 18
	Wall-mounted	45 18
	Vertical	20.5 9
Max. speed mm/s	1000	2000
Rated thrust *2 N	359	179
Repeatability mm	±0.01	
Lost motion mm	0.1 or less	
Static allowable load N	4000	
Static allowable moment N·m	MP: 730, MY: 437, MR: 387	
Operating ambient temperature, humidity	0 to 40°C (no freezing)	
	20 to 80% RH (no condensation)	
Storage ambient temperature, humidity	0 to 40°C (no freezing)	
	20 to 80% RH (no condensation)	
Atmosphere	No corrosive gas, explosive gas, or dust	

*1: Values for max. load capacity are at acceleration/deceleration 0.5 G. Refer to page 510 for details.

*2: Rated thrust and max. load capacity are guideline values assuming that the motor mounted will output the rated torque.

Stroke and max. speed

Screw lead \ Stroke length	(mm/s)								
	100 to 700	800	900	1000	1100	1200	1300	1400	1500
20	1000	980	800	670	560	480	420	360	320
40	2000	1970	1610	1340	1130	970	840	730	650

*The max. speed is the speed when the motor mounted by the customer can output a rotation speed of 3000 rpm. The max. speed is restricted by the stroke. Do not move at speeds beyond the limit.

Allowable overhang length

*Refer to page 504 for details.

Moment direction

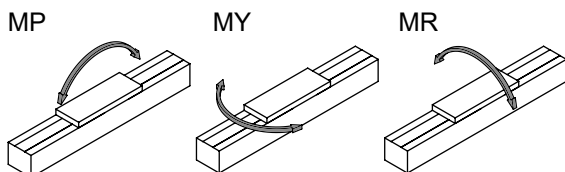

Safety precautions

EBS
 EBR
 ETS
 ETS Multi-Axis
 ECS
 ETV
 ECV
 EKS
 EBS
 EBR
 ETS
 ECS

Dimensions Motor right-side mounting

● EKS-08LR

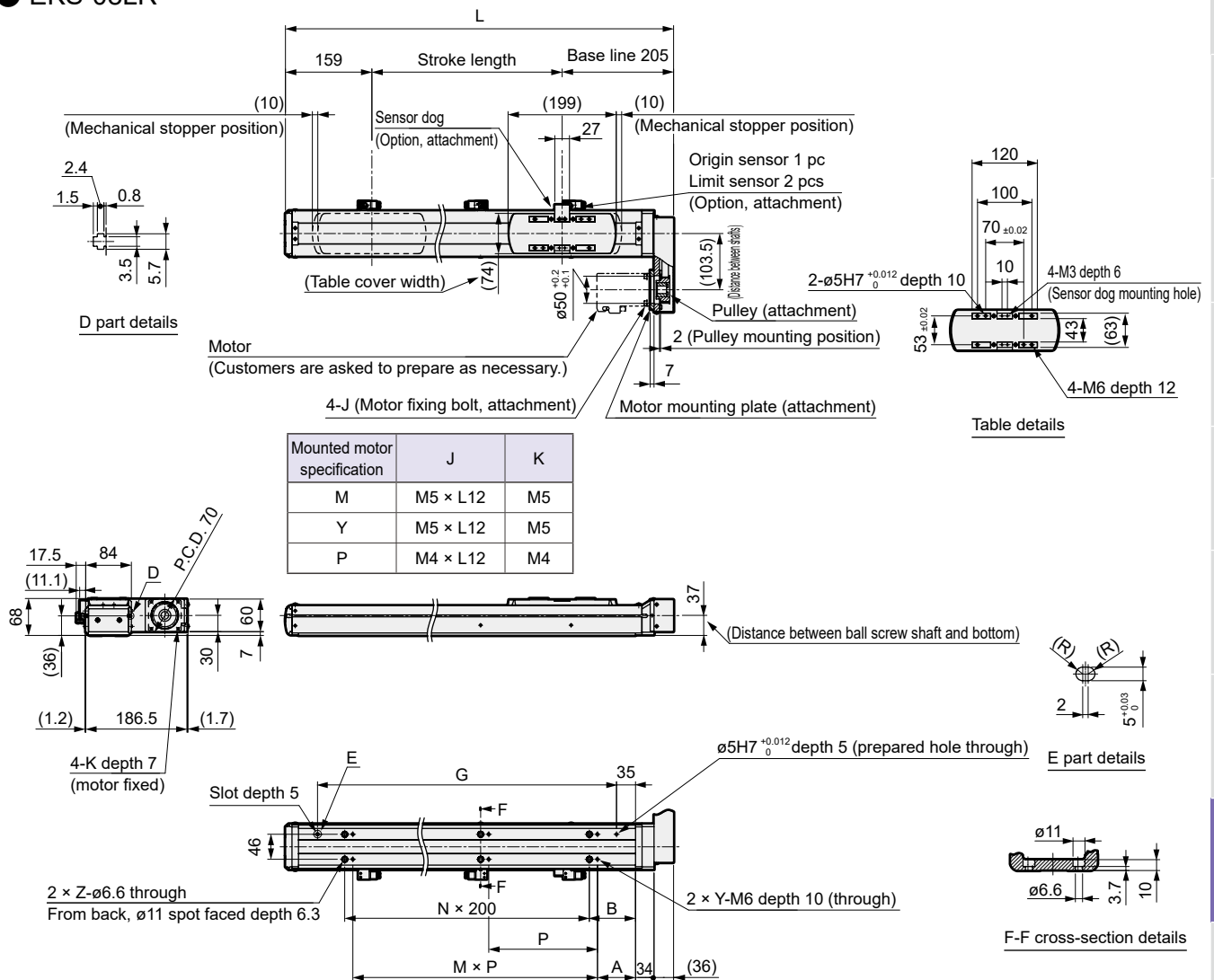

Stroke code	0100	0200	0300	0400	0500	0600	0700	0800	0900	1000	1100	1200	1300	1400	1500
Stroke length (mm)	100	200	300	400	500	600	700	800	900	1000	1100	1200	1300	1400	1500
L	464	564	664	764	864	964	1064	1164	1264	1364	1464	1564	1664	1764	1864
A	65	25	70	120	70	120	70	120	70	120	70	120	70	120	70
B	85	135	85	135	85	135	85	135	85	135	85	135	85	135	85
G	300	400	500	600	700	800	900	1000	1100	1200	1300	1400	1500	1600	1700
M	2	2	2	2	3	3	4	4	5	5	6	6	7	7	8
N	1	1	2	2	3	3	4	4	5	5	6	6	7	7	8
P	120	200													
Y	3	3	3	3	4	4	5	5	6	6	7	7	8	8	9
Z	2	2	3	3	4	4	5	5	6	6	7	7	8	8	9
Weight (kg)	8.7	10	11.3	12.6	13.9	15.2	16.5	17.8	19.1	20.4	21.7	23	24.3	25.6	26.9

List of attachments

[Motor mounting parts]

Mounted motor specification	Pulley	Motor mounting plate fixing bolt	Motor mounting bolt	
			Size	Quantity
M	Included at shipment	Included at shipment	M5	4
Y			M5	4
P			M4	4

[Origin sensor, limit sensor]

Manufacturer	Model	Included quantity
OMRON Corporation	EE-SX674	3

*Refer to page 512 for sensor specifications.

Stepper motor compatible
 Safety precautions

EKS-08L*

Dimensions Motor bottom mounting

● EKS-08LD

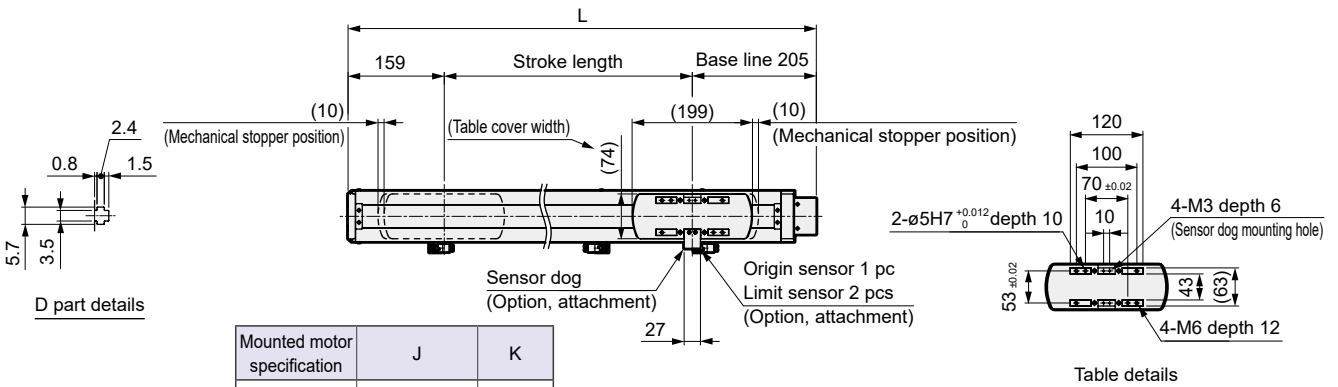

Mounted motor specification	J	K
M	M5 × L12	M5
Y	M5 × L12	M5
P	M4 × L12	M4

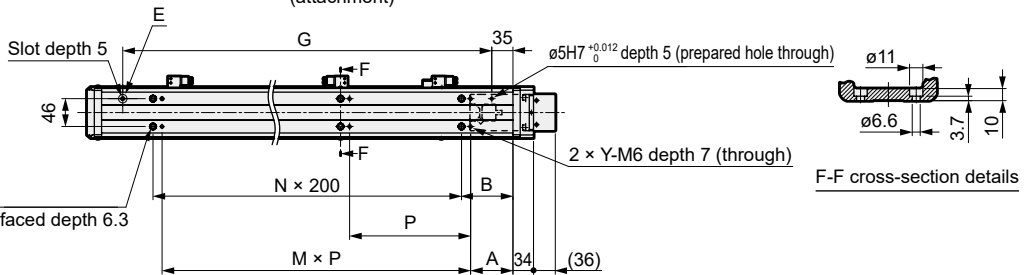
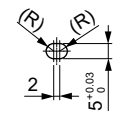
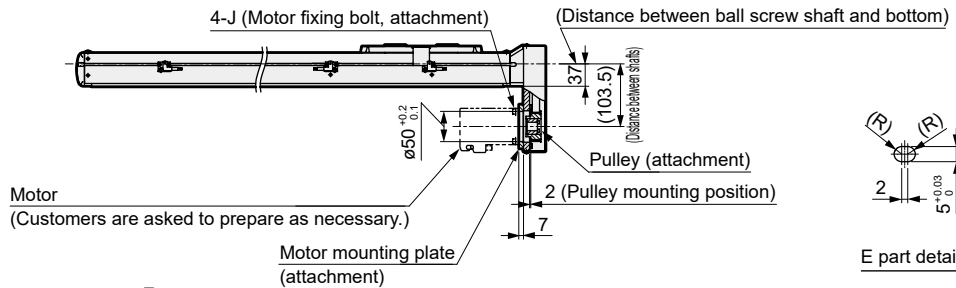
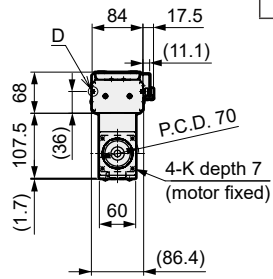

Stroke code	0100	0200	0300	0400	0500	0600	0700	0800	0900	1000	1100	1200	1300	1400	1500
Stroke length (mm)	100	200	300	400	500	600	700	800	900	1000	1100	1200	1300	1400	1500
L	464	564	664	764	864	964	1064	1164	1264	1364	1464	1564	1664	1764	1864
A	65	25	70	120	70	120	70	120	70	120	70	120	70	120	70
B	85	135	85	135	85	135	85	135	85	135	85	135	85	135	85
G	300	400	500	600	700	800	900	1000	1100	1200	1300	1400	1500	1600	1700
M	2	2	2	2	3	3	4	4	5	5	6	6	7	7	8
N	1	1	2	2	3	3	4	4	5	5	6	6	7	7	8
P	120	200													
Y	3	3	3	3	4	4	5	5	6	6	7	7	8	8	9
Z	2	2	3	3	4	4	5	5	6	6	7	7	8	8	9
Weight (kg)	8.7	10	11.3	12.6	13.9	15.2	16.5	17.8	19.1	20.4	21.7	23	24.3	25.6	26.9

List of attachments

[Motor mounting parts]

Mounted motor specification	Pulley	Motor mounting plate fixing bolt	Motor mounting bolt	
			Size	Quantity
M	Included at shipment	Included at shipment	M5	4
Y			M5	4
P			M4	4

[Origin sensor, limit sensor]

Manufacturer	Model	Included quantity
OMRON Corporation	EE-SX674	3

*Refer to page 512 for sensor specifications.

Dimensions Motor left-side mounting

● EKS-08LL

Mounted motor specification	J	K
M	M5 × L12	M5
Y	M5 × L12	M5
P	M4 × L12	M4

4-J (Motor fixing bolt, attachment)
 Motor
 (Customers are asked to prepare as necessary.)

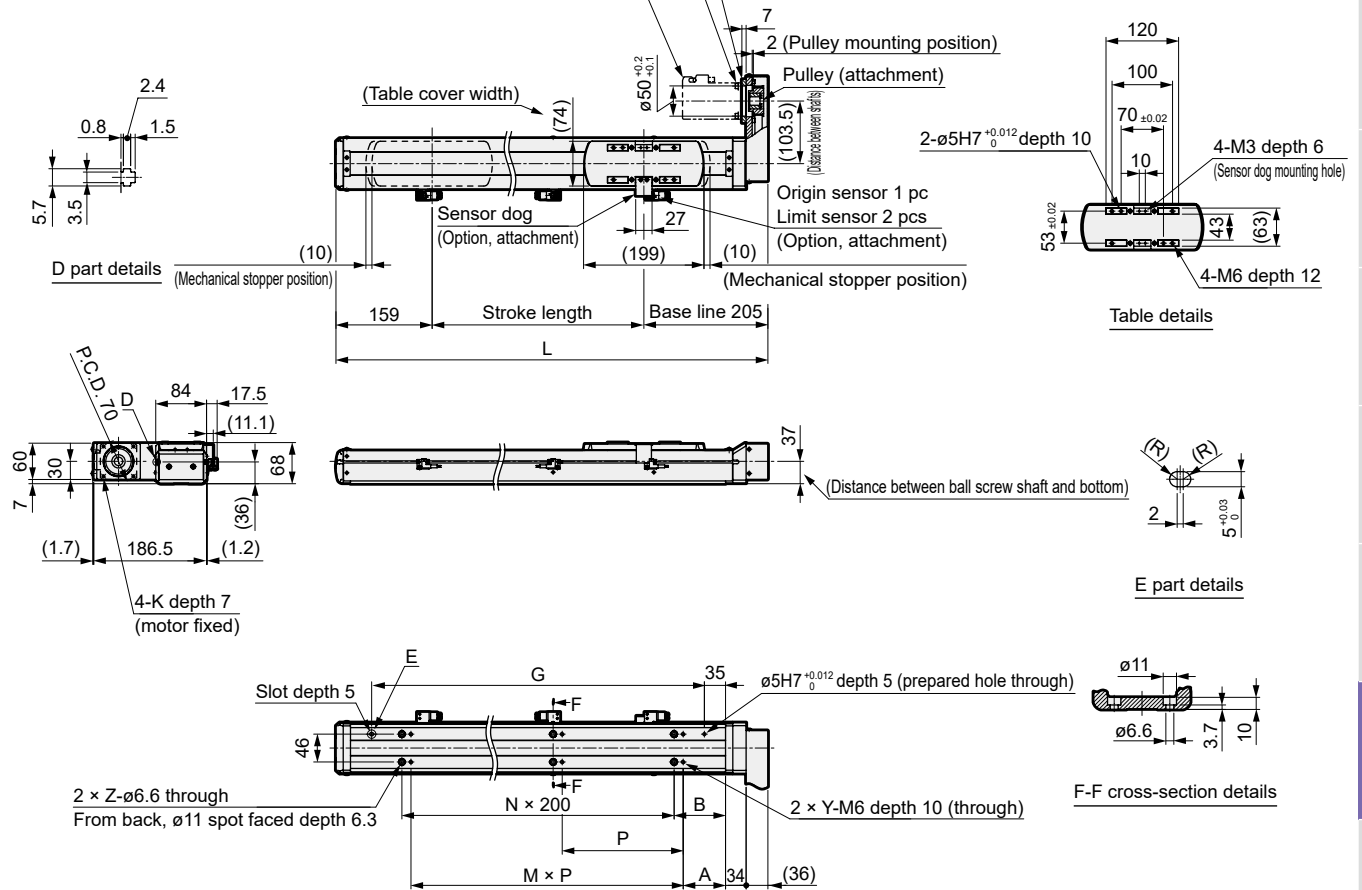

Stroke code	0100	0200	0300	0400	0500	0600	0700	0800	0900	1000	1100	1200	1300	1400	1500
Stroke length (mm)	100	200	300	400	500	600	700	800	900	1000	1100	1200	1300	1400	1500
L	464	564	664	764	864	964	1064	1164	1264	1364	1464	1564	1664	1764	1864
A	65	25	70	120	70	120	70	120	70	120	70	120	70	120	70
B	85	135	85	135	85	135	85	135	85	135	85	135	85	135	85
G	300	400	500	600	700	800	900	1000	1100	1200	1300	1400	1500	1600	1700
M	2	2	2	2	3	3	4	4	5	5	6	6	7	7	8
N	1	1	2	2	3	3	4	4	5	5	6	6	7	7	8
P	120	200													
Y	3	3	3	3	4	4	5	5	6	6	7	7	8	8	9
Z	2	2	3	3	4	4	5	5	6	6	7	7	8	8	9
Weight (kg)	8.7	10	11.3	12.6	13.9	15.2	16.5	17.8	19.1	20.4	21.7	23	24.3	25.6	26.9

List of attachments

[Motor mounting parts]

Mounted motor specification	Pulley	Motor mounting plate fixing bolt	Motor mounting bolt	
			Size	Quantity
M	Included at shipment	Included at shipment	M5	4
Y			M5	4
P			M4	4

[Origin sensor, limit sensor]

Manufacturer	Model	Included quantity
OMRON Corporation	EE-SX674	3

*Refer to page 512 for sensor specifications.

Common options

Dimensions for straight motor mounting

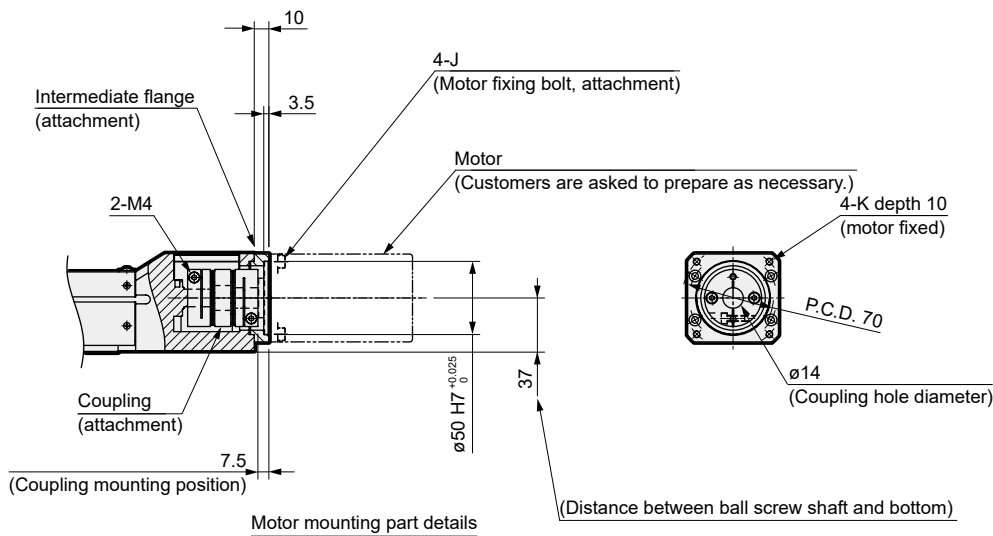

Mounted motor specification	J	K
M	M5 × L12	M5
Y	M5 × L12	M5
P	M4 × L12	M4

For motor mounting on side/bottom

Motor shaft fixing method

Pulley (attachment)

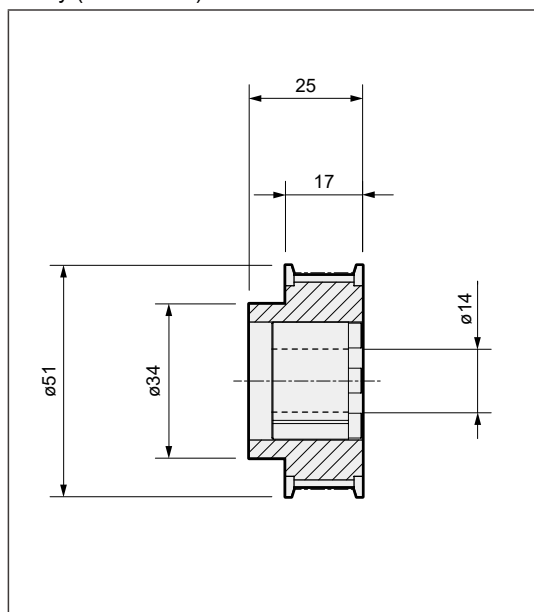

MEMO

Servo motor compatible						Stepper motor compatible					
EBS	EBR	ETS	ETS Multi-Axis	ECS	ETV	ECV	EKS	EBS	EBR	ETS	ECS

Safety
precautions



Electric actuator (motorless) Slider

EKS-10LE

Straight motor mounting

● Servo motor capacity: 750 W

How to order

EKS - 10 L E - 25 0300 N NN - M 8 N C B

A Body size 10 Body width 104 mm	B Motor L None	C Motor mounting direction E Straight mounting	D Screw lead 25 25 mm 50 50 mm	E Stroke length 0100 100 mm to (In 100 mm increments) 1500 1500 mm	F Brake N None	G Mounted motor specification M Select the mounted motor Y specification from the table at right. P	H Motor capacity 8 750 W	I Motor shaft fixing method N For straight mounting	J Origin sensor *1 N None C Yes	K Limit sensor *1 N None B Yes
--	--------------------------	--	---	--	--------------------------	--	------------------------------------	---	--	---

Manufacturer	750 W
Mitsubishi Electric Corporation	M
Delta Electronics Co., Ltd.	M
YASKAWA Electric Corporation	Y
Keyence Corporation	Y
Panasonic Corporation	P
OMRON Corporation	P
Fuji Electric Co., Ltd.	M
Bosch Rexroth AG	P
Rockwell Automation, Inc.	M
SIEMENS AG	M

*1 Origin sensor and limit sensor are available as a set. As it is both-or-nothing, select "None" for both.

*Refer to page 461 for the motor model No.

Specifications

Applicable motor capacity	750 W servo motor	
Drive method	Ball screw $\varnothing 25$	
Stroke length	mm 100 to 1500	
Screw lead	mm 25	50
Max. load capacity kg *1 *2	Horizontal	118.5
	Wall-mounted	76
	Vertical	33.5
Max. speed	mm/s 1250	2500
Rated thrust *2	N 540	270
Repeatability	mm ± 0.01	
Lost motion	mm 0.1 or less	
Static allowable load	N 5830	
Static allowable moment N·m	MP: 1048, MY: 712, MR: 671	
Operating ambient temperature, humidity	0 to 40°C (no freezing) 20 to 80% RH (no condensation)	
Storage ambient temperature, humidity	0 to 40°C (no freezing) 20 to 80% RH (no condensation)	
Atmosphere	No corrosive gas, explosive gas, or dust	

*1: Values for max. load capacity are at acceleration/deceleration 0.5 G. Refer to page 510 for details.

*2: Rated thrust and max. load capacity are guideline values assuming that the motor mounted will output the rated torque.

Stroke and max. speed

Stroke length Screw lead	(mm/s)						
	100 to 900	1000	1100	1200	1300	1400	1500
25	1250	1050	890	760	660	580	510
50	2500	2110	1790	1530	1330	1160	1030

*The max. speed is the speed when the motor mounted by the customer can output a rotation speed of 3000 rpm.

The max. speed is restricted by the stroke. Do not move at speeds beyond the limit.

Allowable overhang length

*Refer to page 504 for details.

Moment direction

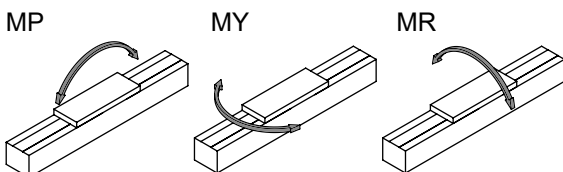

Safety precautions

EBS EBR ETS ETS Multi-Axis ECS ETV ECV EKS EBS EBR ETS ECS Stepper motor compatible Servo motor compatible Safety precautions

Dimensions Straight motor mounting

● EKS-10LE

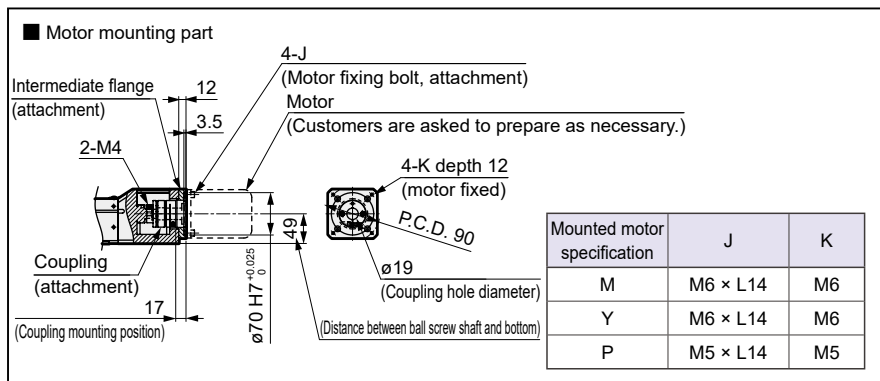
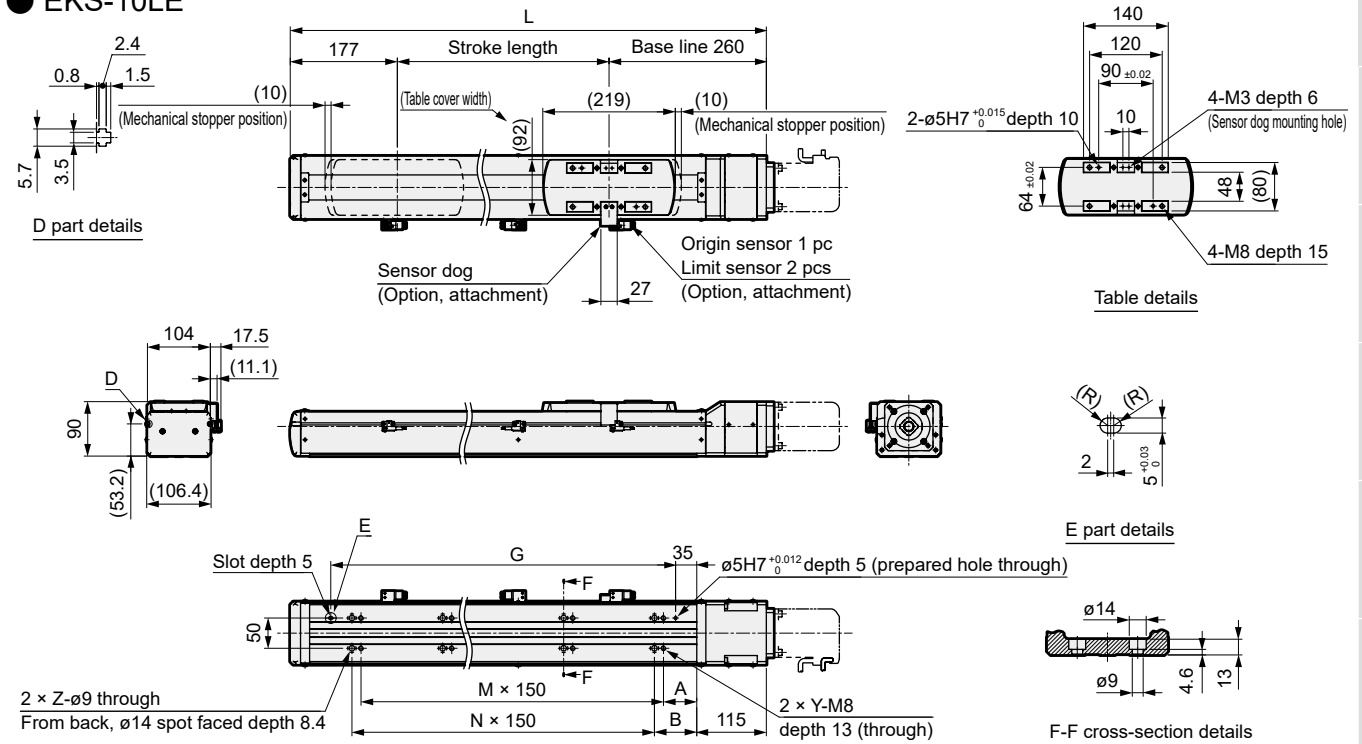

Stroke code	0100	0200	0300	0400	0500	0600	0700	0800	0900	1000	1100	1200	1300	1400	1500
Stroke length (mm)	100	200	300	400	500	600	700	800	900	1000	1100	1200	1300	1400	1500
L	537	637	737	837	937	1037	1137	1237	1337	1437	1537	1637	1737	1837	1937
A	45	80	55	105	80	55	105	80	55	105	80	55	105	80	55
B	120	95	70	120	95	70	120	95	70	120	95	70	120	95	70
G	320	420	520	620	720	820	920	1020	1120	1220	1320	1420	1520	1620	1720
M	2	2	3	3	4	5	5	6	7	7	8	9	9	10	11
N	1	2	3	3	4	5	5	6	7	7	8	9	9	10	11
Y	3	3	4	4	5	6	6	7	8	8	9	10	10	11	12
Z	2	3	4	4	5	6	6	7	8	8	9	10	10	11	12
Weight (kg)	14.7	16.8	18.8	20.9	22.9	25	27	29.1	31.2	33.2	35.3	37.3	39.4	41.5	43.5

List of attachments

[Motor mounting parts]

Mounted motor specification	Coupling	Intermediate flange fixing bolt	Motor mounting bolt	
			Size	Quantity
M	Included at shipment	Included at shipment	M6	4
Y			M6	4
P			M5	4

[Origin sensor, limit sensor]

Manufacturer	Model	Included quantity
OMRON Corporation	EE-SX674	3

*Refer to page 512 for sensor specifications.



Electric actuator (motorless) Slider

EKS-10L*

Motor side mounting (left, right, bottom)

● Servo motor capacity: 750 W

How to order

EKS - 10 L R - 25 0300 N NN - M 8 M C B

A Body size 10 Body width 104 mm	E Stroke length 0100 100 mm to (In 100 mm increments) 1500 1500 mm	H Motor capacity 8 750 W	J Origin sensor *1 N None C Yes																						
B Motor L None	F Brake N None	I Motor shaft fixing method M Friction locking	K Limit sensor *1 N None B Yes																						
C Motor mounting direction R Right mounting D Bottom mounting L Left mounting	G Mounted motor specification M Select the mounted motor specification from the table at right. Y P	<table border="1"> <thead> <tr> <th>Manufacturer</th> <th>750 W</th> </tr> </thead> <tbody> <tr><td>Mitsubishi Electric Corporation</td><td>M</td></tr> <tr><td>Delta Electronics Co., Ltd.</td><td>M</td></tr> <tr><td>YASKAWA Electric Corporation</td><td>Y</td></tr> <tr><td>Keyence Corporation</td><td>Y</td></tr> <tr><td>Panasonic Corporation</td><td>P</td></tr> <tr><td>OMRON Corporation</td><td>P</td></tr> <tr><td>Fuji Electric Co., Ltd.</td><td>M</td></tr> <tr><td>Bosch Rexroth AG</td><td>P</td></tr> <tr><td>Rockwell Automation, Inc.</td><td>M</td></tr> <tr><td>SIEMENS AG</td><td>M</td></tr> </tbody> </table>		Manufacturer	750 W	Mitsubishi Electric Corporation	M	Delta Electronics Co., Ltd.	M	YASKAWA Electric Corporation	Y	Keyence Corporation	Y	Panasonic Corporation	P	OMRON Corporation	P	Fuji Electric Co., Ltd.	M	Bosch Rexroth AG	P	Rockwell Automation, Inc.	M	SIEMENS AG	M
Manufacturer	750 W																								
Mitsubishi Electric Corporation	M																								
Delta Electronics Co., Ltd.	M																								
YASKAWA Electric Corporation	Y																								
Keyence Corporation	Y																								
Panasonic Corporation	P																								
OMRON Corporation	P																								
Fuji Electric Co., Ltd.	M																								
Bosch Rexroth AG	P																								
Rockwell Automation, Inc.	M																								
SIEMENS AG	M																								
D Screw lead 25 25 mm 50 50 mm																									

*1 Origin sensor and limit sensor are available as a set. As it is both-or-nothing, select "None" for both.

*Refer to page 461 for the motor model No.

Specifications

Applicable motor capacity	750 W servo motor	
Drive method	Ball screw $\varnothing 25$	
Stroke length	mm 100 to 1500	
Screw lead	mm 25	50
Max. load capacity kg *1 *2	Horizontal	92.5 37.5
	Wall-mounted	76 37.5
	Vertical	28 12.5
Max. speed	mm/s 1250	2500
Rated thrust *2	N 540	270
Repeatability	mm ± 0.01	
Lost motion	mm 0.1 or less	
Static allowable load	N 5830	
Static allowable moment	N·m MP: 1048, MY: 712, MR: 671	
Operating ambient temperature, humidity	0 to 40°C (no freezing)	
	20 to 80% RH (no condensation)	
Storage ambient temperature, humidity	0 to 40°C (no freezing)	
	20 to 80% RH (no condensation)	
Atmosphere	No corrosive gas, explosive gas, or dust	

*1: Values for max. load capacity are at acceleration/deceleration 0.5 G. Refer to page 510 for details.

*2: Rated thrust and max. load capacity are guideline values assuming that the motor mounted will output the rated torque.

Stroke and max. speed

Stroke length Screw lead	(mm/s)						
	100 to 900	1000	1100	1200	1300	1400	1500
25	1250	1050	890	760	660	580	510
50	2500	2110	1790	1530	1330	1160	1030

*The max. speed is the speed when the motor mounted by the customer can output a rotation speed of 3000 rpm. The max. speed is restricted by the stroke. Do not move at speeds beyond the limit.

Allowable overhang length

*Refer to page 504 for details.

Moment direction

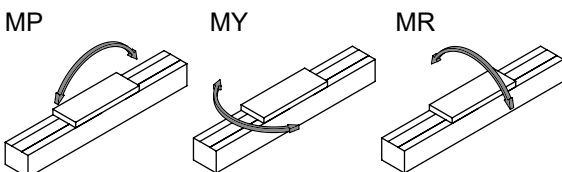

Dimensions Motor right-side mounting

● EKS-10LR

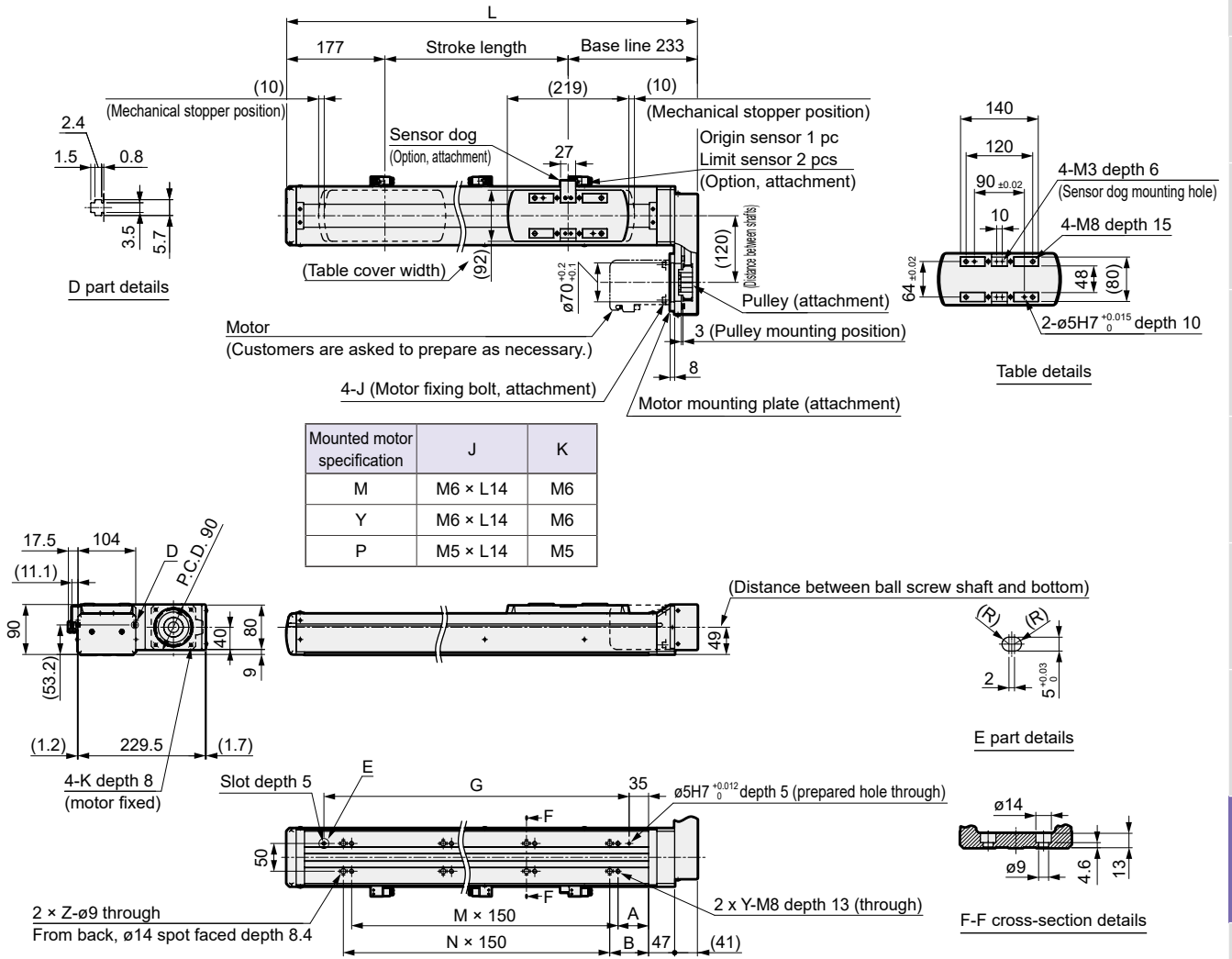

Stroke code	0100	0200	0300	0400	0500	0600	0700	0800	0900	1000	1100	1200	1300	1400	1500
Stroke length (mm)	100	200	300	400	500	600	700	800	900	1000	1100	1200	1300	1400	1500
L	510	610	710	810	910	1010	1110	1210	1310	1410	1510	1610	1710	1810	1910
A	45	80	55	105	80	55	105	80	55	105	80	55	105	80	55
B	120	95	70	120	95	70	120	95	70	120	95	70	120	95	70
G	320	420	520	620	720	820	920	1020	1120	1220	1320	1420	1520	1620	1720
M	2	2	3	3	4	5	5	6	7	7	8	9	9	10	11
N	1	2	3	3	4	5	5	6	7	7	8	9	9	10	11
Y	3	3	4	4	5	6	6	7	8	8	9	10	10	11	12
Z	2	3	4	4	5	6	6	7	8	8	9	10	10	11	12
Weight (kg)	15.6	17.7	19.8	21.8	23.9	25.9	28	30.1	32.1	34.2	36.2	38.3	40.4	42.4	44.5

List of attachments

[Motor mounting parts]

Mounted motor specification	Pulley	Motor mounting plate fixing bolt	Motor mounting bolt	
			Size	Quantity
M	Included at shipment	Included at shipment	M6	4
Y			M6	4
P			M5	4

[Origin sensor, limit sensor]

Manufacturer	Model	Included quantity
OMRON Corporation	EE-SX674	3

*Refer to page 512 for sensor specifications.

EKS-10L*

Dimensions Motor bottom mounting

● EKS-10LD

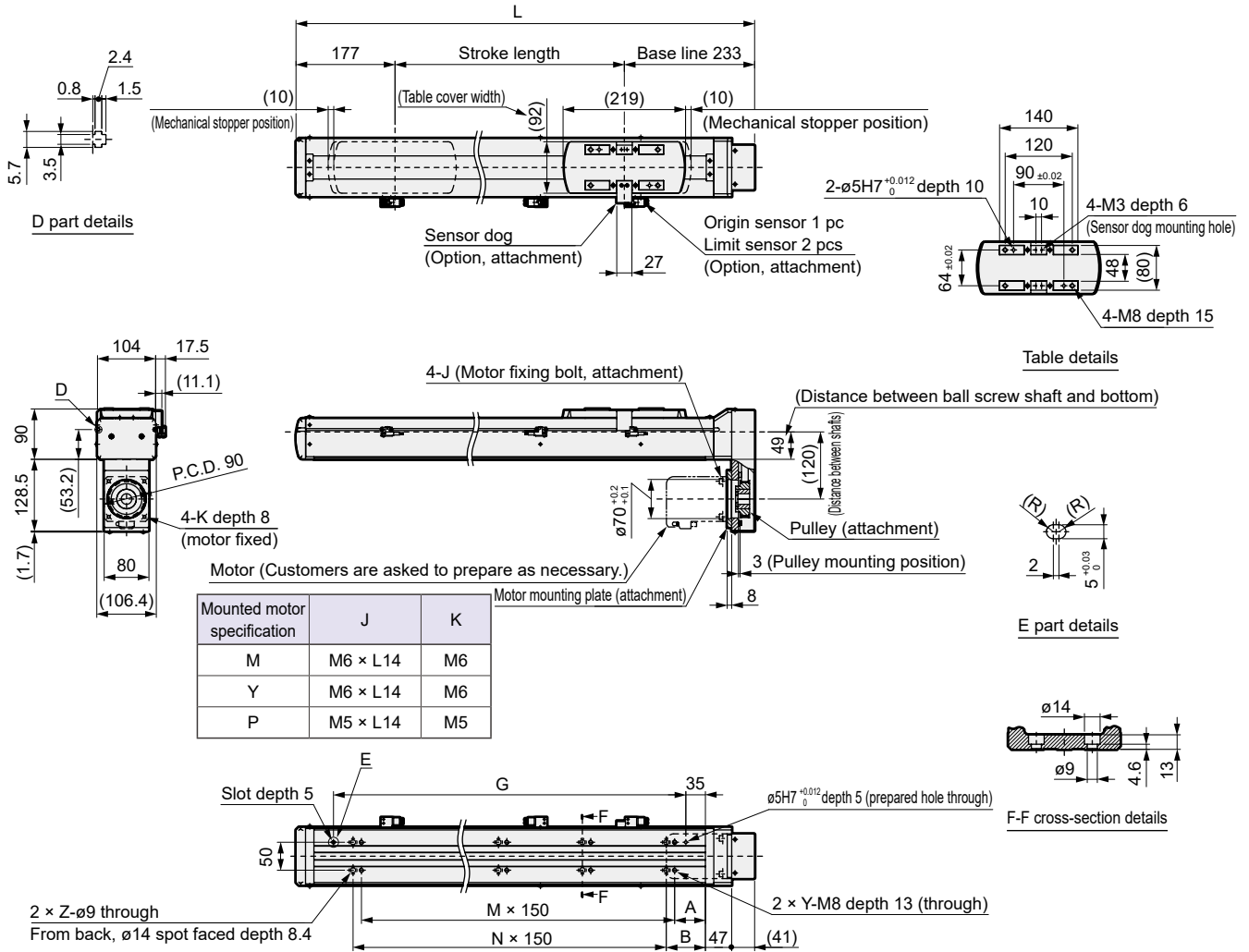

Stroke code	0100	0200	0300	0400	0500	0600	0700	0800	0900	1000	1100	1200	1300	1400	1500
Stroke length (mm)	100	200	300	400	500	600	700	800	900	1000	1100	1200	1300	1400	1500
L	510	610	710	810	910	1010	1110	1210	1310	1410	1510	1610	1710	1810	1910
A	45	80	55	105	80	55	105	80	55	105	80	55	105	80	55
B	120	95	70	120	95	70	120	95	70	120	95	70	120	95	70
G	320	420	520	620	720	820	920	1020	1120	1220	1320	1420	1520	1620	1720
M	2	2	3	3	4	5	5	6	7	7	8	9	9	10	11
N	1	2	3	3	4	5	5	6	7	7	8	9	9	10	11
Y	3	3	4	4	5	6	6	7	8	8	9	10	10	11	12
Z	2	3	4	4	5	6	6	7	8	8	9	10	10	11	12
Weight (kg)	15.6	17.7	19.8	21.8	23.9	25.9	28	30.1	32.1	34.2	36.2	38.3	40.4	42.4	44.5

List of attachments

[Motor mounting parts]

Mounted motor specification	Pulley	Motor mounting plate fixing bolt	Motor mounting bolt	
			Size	Quantity
M	Included at shipment	Included at shipment	M6	4
Y			M6	4
P			M5	4

[Origin sensor, limit sensor]

Manufacturer	Model	Included quantity
OMRON Corporation	EE-SX674	3

*Refer to page 512 for sensor specifications.

Dimensions Motor left-side mounting

● EKS-10LL

Mounted motor specification	J	K
M	M6 × L14	M6
Y	M6 × L14	M6
P	M5 × L14	M5

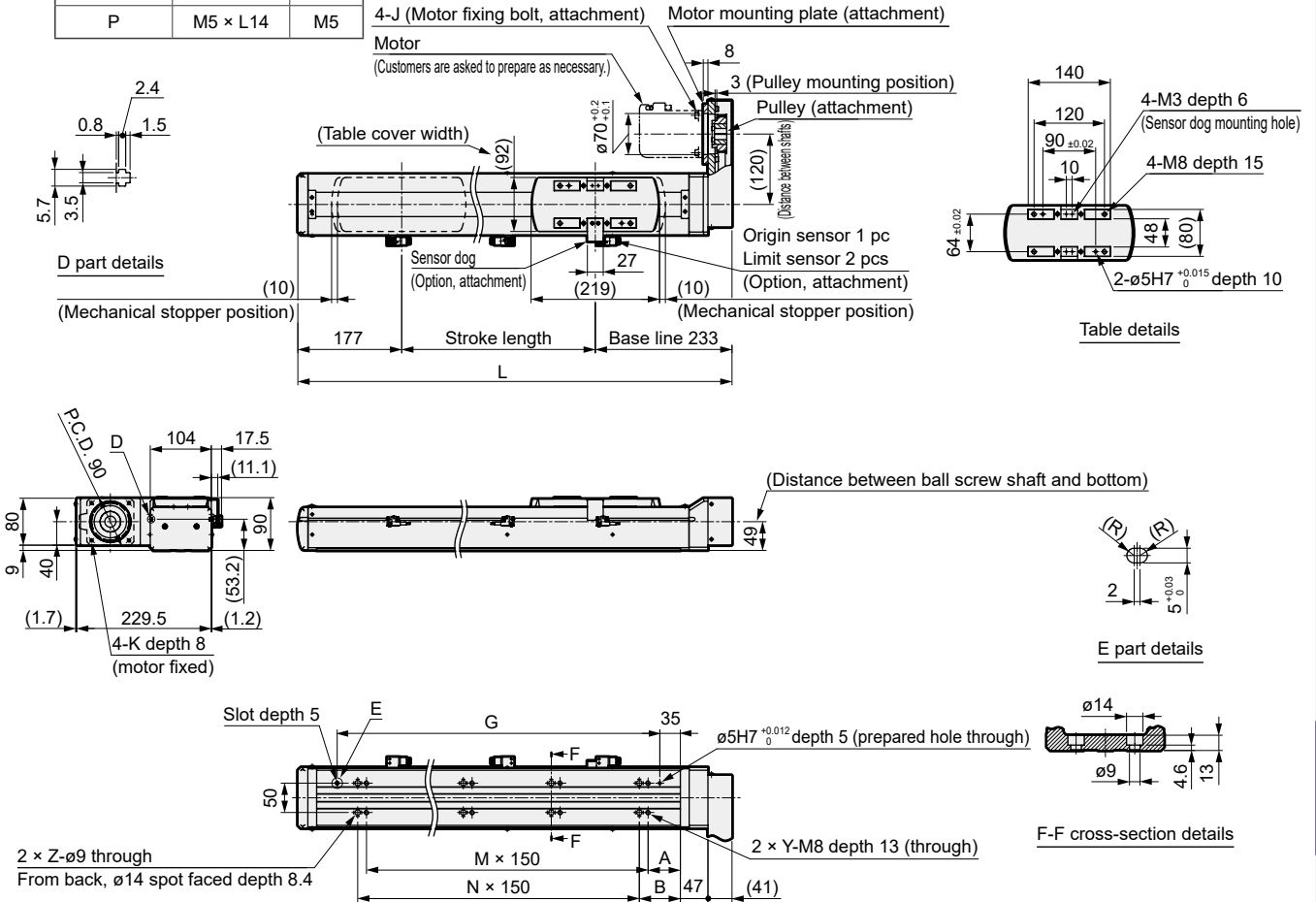

Stroke code	0100	0200	0300	0400	0500	0600	0700	0800	0900	1000	1100	1200	1300	1400	1500
Stroke length (mm)	100	200	300	400	500	600	700	800	900	1000	1100	1200	1300	1400	1500
L	510	610	710	810	910	1010	1110	1210	1310	1410	1510	1610	1710	1810	1910
A	45	80	55	105	80	55	105	80	55	105	80	55	105	80	55
B	120	95	70	120	95	70	120	95	70	120	95	70	120	95	70
G	320	420	520	620	720	820	920	1020	1120	1220	1320	1420	1520	1620	1720
M	2	2	3	3	4	5	5	6	7	7	8	9	9	10	11
N	1	2	3	3	4	5	5	6	7	7	8	9	9	10	11
Y	3	3	4	4	5	6	6	7	8	8	9	10	10	11	12
Z	2	3	4	4	5	6	6	7	8	8	9	10	10	11	12
Weight (kg)	15.6	17.7	19.8	21.8	23.9	25.9	28	30.1	32.1	34.2	36.2	38.3	40.4	42.4	44.5

List of attachments

[Motor mounting parts]

Mounted motor specification	Pulley	Motor mounting plate fixing bolt	Motor mounting bolt	
			Size	Quantity
M	Included at shipment	Included at shipment	M6	4
Y			M6	4
P			M5	4

[Origin sensor, limit sensor]

Manufacturer	Model	Included quantity
OMRON Corporation	EE-SX674	3

*Refer to page 512 for sensor specifications.

Common options

Dimensions for straight motor mounting

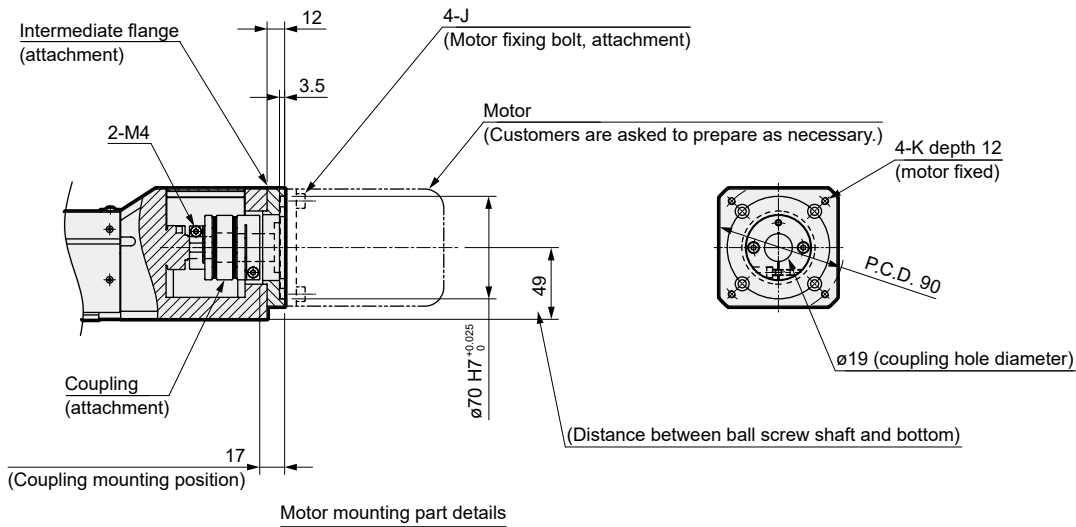

Mounted motor specification	J	K
M	M6 × L14	M6
Y	M6 × L14	M6
P	M5 × L14	M5

For motor mounting on side/bottom

Motor shaft fixing method

Pulley (attachment)

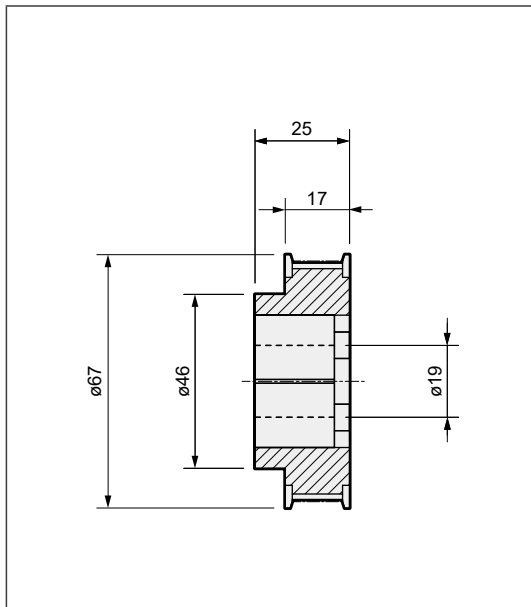

MEMO

Servo motor compatible						Stepper motor compatible					
EBS	EBR	ETS	ETS Multi-Axis	ECS	ETV	ECV	EKS	EBS	EBR	ETS	ECS

Safety precautions

Model selection

STEP 1 Confirming load capacity

Load capacity varies with mounting orientation and screw lead.

Refer to the Table of Load Capacity by Acceleration/deceleration (pages 510 and 511) to select the size and screw lead.

STEP 2 Confirming positioning time

Calculate the positioning time of the selected product according to the following example and confirm that the required tact is achievable.

Select the speed and acceleration/deceleration from the specification table for each model and the motor selected by the customer.

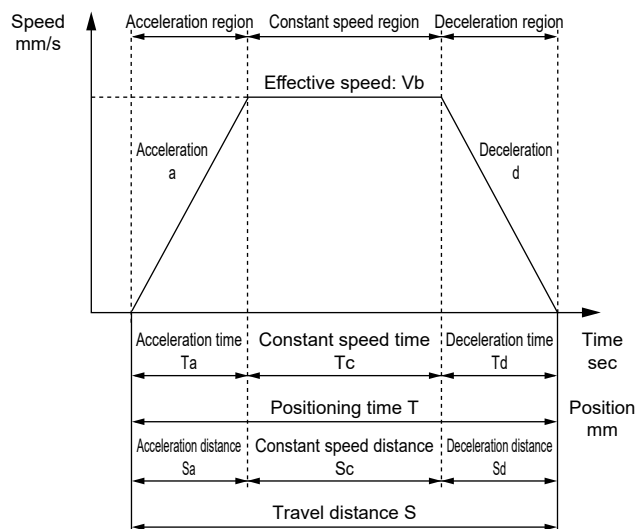

	Description	Code	Unit	Remarks
Set value	Set speed	V	mm/s	
	Set acceleration	a	mm/s ²	
	Set deceleration	d	mm/s ²	
	Travel distance	S	mm	
Calculated value	Achieved speed	Vmax	mm/s	$= \{2 \times a \times d \times S / (a + d)\}^{1/2}$
	Effective speed	Vb	mm/s	Smaller of V and Vmax
	Acceleration time	Ta	s	$= Vb/a$
	Deceleration time	Td	s	$= Vb/d$
	Constant speed time	Tc	s	$= Sc/Vb$
	Acceleration distance	Sa	mm	$= (a \times Ta^2)/2$
	Deceleration distance	Sd	mm	$= (d \times Td^2)/2$
	Constant speed distance	Sc	mm	$= S - (Sa + Sd)$
	Positioning time	T	s	$= Ta + Tc + Td$

*Do not use at speeds that exceed the specifications.

*Depending on acceleration/deceleration and stroke length, the trapezoidal speed waveform may not be formed (the set speed may not be achieved). In this case, select the effective speed (Vb) from the set speed (V) and the achieved speed (Vmax), whichever is smaller.

*Use at acceleration/deceleration of 2 G or less.

*1 G \approx 9.8 m/s².

STEP 3 Confirming allowable overhang length

Make sure that the load overhang length during operation is within the allowable range (pages 504 to 509).

Contact CKD for selection details.

MEMO

Servo motor compatible						Stepper motor compatible					
EBS	EBR	ETS	ETS Multi-Axis	ECS	ETV	ECV	EKS	EBS	EBR	ETS	ECS

Safety
precautions

Allowable moment and overhang length by mounting orientation (EKS Series)

[When installed horizontally]

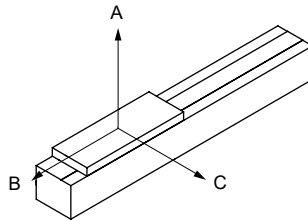

[Allowable overhang length]

● EKS-04

Motor mounted	Acceleration/ deceleration G	Screw lead	Weight kg	Overhang mm		
				A	B	C
Straight	0.15	10	4.5	400	130	220
			9.5	400	60	100
			19	370	20	40
		16	3.5	400	140	220
			7	400	60	100
			14	270	30	40
	1	10	4.5	400	130	210
			9.5	210	60	100
			19	90	20	40
		16	3.5	360	140	200
			7	160	60	90
			14	60	20	40
	2	10	3	400	210	310
			6	220	100	150
			12	90	40	70
		16	2	370	240	290
			4	170	110	140
			8.5	70	50	70
Left/ Right/ Bottom	0.15	10	4.5	400	130	220
			9.5	400	60	100
			19	370	20	40
		16	3.5	400	140	220
			7	400	60	100
			14	270	30	40
	1	10	4.5	400	130	210
			9.5	210	60	100
			19	90	20	40
		16	3.5	360	140	200
			7	160	60	90
			14	60	20	40
	2	10	2.5	400	240	350
			5	250	120	170
			10.5	110	50	80
		16	1.5	400	270	330
			3.5	200	130	160
			7.5	80	60	80

*Screw lead 10 mm at Stroke length: 550 mm
Rated speed: 500 mm/s
Screw lead 16 mm at Stroke length: 550 mm
Rated speed: 800 mm/s.

● EKS-05

Motor mounted	Acceleration/ deceleration G	Screw lead	Weight kg	Overhang mm		
				A	B	C
Straight	0.15	10	6.5	500	160	340
			13	500	70	160
			26	460	30	70
		20	1.5	500	360	500
			3.5	500	170	330
			7.5	500	80	160
	1	10	6	500	160	310
			12.5	270	70	150
			25.5	120	30	70
		20	1.5	500	360	500
			3.5	380	170	270
			7.5	170	80	130
	2	10	1.5	500	500	500
			3.5	500	280	470
			7.5	300	130	230
		20	1	500	490	500
			2.5	330	240	300
			5.5	150	110	150
Left/ Right/ Bottom	0.15	10	6.5	500	160	340
			13	500	70	160
			26	460	30	70
		20	1.5	500	360	500
			3.5	500	170	330
			7.5	500	80	160
	1	10	5.5	500	190	370
			11	320	90	180
			22	140	40	80
		20	1.5	500	360	500
			3.5	380	170	270
			7.5	170	80	130
	2	10	1.5	500	500	500
			3	500	350	500
			6	380	170	290
		20	1	500	500	500
			2.5	360	270	320
			5	160	130	160

*Screw lead 10 mm at Stroke length: 600 mm
Rated speed: 500 mm/s
Screw lead 16 mm at Stroke length: 600 mm
Rated speed: 1000 mm/s.

● EKS-06

Motor mounted	Acceleration/ deceleration G	Screw lead	Weight kg	Overhang mm		
				A	B	C
Straight	0.15	20	11.5	600	120	210
			23.5	460	50	100
			47.5	180	20	40
		30	5	600	290	520
			10	600	140	250
			20.5	550	60	120
	1	20	6.5	490	210	320
			13.5	220	100	160
			27	90	40	70
		30	3.5	600	430	520
			7	350	200	260
			14	150	90	130
	2	20	2	600	600	600
			4.5	460	330	400
			9	210	160	200
		30	1.5	600	600	600
			3.5	420	400	380
			7.5	190	190	200
Left/ Right/ Bottom	0.15	20	11	600	120	230
			22	500	50	100
			44.5	200	20	40
		30	4.5	600	310	570
			9.5	600	150	270
			19	600	70	130
	1	20	5	600	290	430
			10	310	140	210
			22.5	130	60	100
		30	2.5	600	550	600
			5.5	450	270	330
			11	200	120	160
	2	20	1	600	600	600
			2	600	600	600
			4.5	460	330	400
		30	1	600	600	600
			2.5	600	600	570
			5	300	290	290

*Screw lead 20 mm at Stroke length: 650 mm
Rated speed: 1000 mm/s
Screw lead 30 mm at Stroke length: 650 mm
Rated speed: 1500 mm/s.

Allowable moment and overhang length by mounting orientation (EKS Series)

[When installed horizontally]

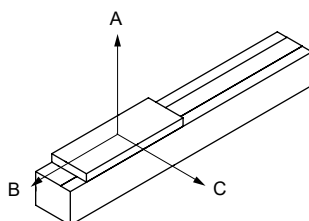

[Allowable overhang length]

● EKS-08

Motor mounted	Acceleration/ deceleration G	Screw lead	Weight kg	Overhang mm		
				A	B	C
Straight	0.15	20	20.5	800	190	320
			41.5	760	90	140
			83.5	310	30	60
		40	4.5	800	680	800
			9.5	800	330	540
			19	800	150	260
	1	20	12	800	340	480
			24.5	380	160	230
			49	160	70	110
		40	4	800	780	770
			8	550	380	380
			16.5	250	180	190
	2	20	3.5	800	800	800
			7	800	610	710
			14	430	300	350
		40	2	800	800	800
			4	690	760	600
			8.5	320	370	300
Left/ Right/ Bottom	0.15	20	19.5	800	200	330
			39.5	800	90	150
			79.5	340	40	60
		40	4.5	800	720	800
			9	800	350	580
			18	800	160	270
	1	20	9.5	800	440	610
			19	500	210	300
			38.5	220	90	140
		40	3	800	800	800
			6.5	680	470	470
			13.5	320	220	230
	2	20	1.5	800	800	800
			3	800	800	800
			6.5	800	660	760
		40	1.5	800	800	800
			3	800	800	800
			6	470	530	420

*Screw lead 20 mm at Stroke length: 700 mm
 Rated speed: 1000 mm/s
 Screw lead 40 mm at Stroke length: 700 mm
 Rated speed: 2000 mm/s.

● EKS-10

Motor mounted	Acceleration/ deceleration G	Screw lead	Weight kg	Overhang mm		
				A	B	C
Straight	0.15	25	42.5	1000	200	350
			85.5	890	90	160
			171.5	360	30	60
		50	10	1000	680	1000
			20	1000	330	590
			40	1000	150	280
	1	25	16	1000	560	770
			32	590	270	380
			64.5	260	120	180
		50	4.5	1000	1000	1000
			9.5	970	710	690
			19	450	340	350
	2	25	4	1000	1000	1000
			8	1000	1000	1000
			16	770	560	640
		50	1.5	1000	1000	1000
			3.5	1000	1000	1000
			7	820	980	740
Left/ Right/ Bottom	0.15	25	40	1000	210	380
			80.5	960	90	170
			161.5	400	40	70
		50	9	1000	730	1000
			18.5	1000	350	630
			37.5	1000	160	300
	1	25	11	1000	830	1000
			22	890	400	560
			44	410	190	280
		50	3	1000	1000	1000
			6.5	1000	1000	1000
			13	690	510	510
	2	50	1	1000	1000	1000
			2.5	1000	1000	1000

*Screw lead 25 mm at Stroke length: 900 mm
 Rated speed: 1250 mm/s
 Screw lead 50 mm at Stroke length: 900 mm
 Rated speed: 2500 mm/s.

Allowable moment and overhang length by mounting orientation (EKS Series)

[When wall-mounted]

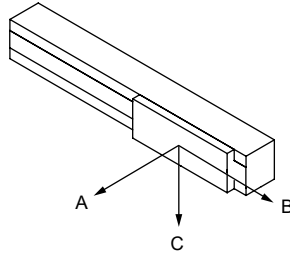

[Allowable overhang length]

● EKS-04

Motor mounted	Acceleration/deceleration G	Screw lead	Weight kg	Overhang mm		
				A	B	C
Straight	0.15	10	2.5	360	210	400
			5.5	150	90	400
			11	50	30	400
		16	2	360	220	400
			4	150	90	400
			8.5	50	30	350
	1	10	2.5	360	230	400
			5	160	100	400
			10	50	30	180
		16	1.5	340	250	400
			3.5	150	110	310
			7.5	50	40	120
	2	10	2	340	250	400
			4.5	150	110	270
			9.5	50	40	110
		16	1.5	300	270	400
			3.5	130	120	200
			7	50	40	80
Left/Right/Bottom	0.15	10	2.5	360	210	400
			5.5	150	90	400
			11	50	30	400
		16	2	360	220	400
			4	150	90	400
			8.5	50	30	350
	1	10	2.5	360	230	400
			5	160	100	400
			10	50	30	180
		16	1.5	340	250	400
			3.5	150	110	310
			7.5	50	40	120
	2	10	2	340	250	400
			4.5	150	110	270
			9.5	50	40	110
		16	1.5	300	270	400
			3.5	130	120	200
			7	50	40	80

*Screw lead 10 mm at Stroke length: 550 mm
Rated speed: 500 mm/s
Screw lead 16 mm at Stroke length: 550 mm
Rated speed: 800 mm/s.

● EKS-05

Motor mounted	Acceleration/deceleration G	Screw lead	Weight kg	Overhang mm		
				A	B	C
Straight	0.15	10	4.5	430	200	500
			9.5	190	80	500
			19.5	70	30	500
		20	1.5	500	340	500
			3.5	320	160	500
			7.5	130	60	500
	1	10	4.5	410	210	500
			9	180	90	390
			18	60	30	160
		20	1.5	490	340	500
			3.5	220	150	360
			7.5	90	60	150
	2	10	1.5	500	500	500
			3.5	420	260	500
			7.5	190	120	290
		20	1	500	470	500
			2.5	240	220	320
			5.5	100	90	140
Left/Right/Bottom	0.15	10	4.5	430	200	500
			9.5	190	80	500
			19.5	70	30	500
		20	1.5	500	340	500
			3.5	320	160	500
			7.5	130	60	500
	1	10	4.5	410	210	500
			9	180	90	390
			18	60	30	160
		20	1.5	490	340	500
			3.5	220	150	360
			7.5	90	60	150
	2	10	1.5	500	500	500
			3	500	340	500
			6	250	150	370
		20	1	500	500	500
			2.5	270	250	350
			5	120	110	150

*Screw lead 10 mm at Stroke length: 600 mm
Rated speed: 500 mm/s
Screw lead 16 mm at Stroke length: 600 mm
Rated speed: 1000 mm/s.

● EKS-06

Motor mounted	Acceleration/deceleration G	Screw lead	Weight kg	Overhang mm		
				A	B	C
Straight	0.15	20	5	480	250	600
			10.5	210	100	600
			21.5	70	30	350
		30	5	510	260	600
			10	220	110	600
			20.5	80	40	390
	1	20	4.5	420	290	600
			9	180	130	320
			18.5	60	40	120
		30	3.5	450	400	600
			7	200	180	320
			14	70	70	120
	2	20	2	600	600	600
			4.5	330	300	450
			9	140	130	200
		30	1.5	600	600	600
			3.5	310	360	400
			7.5	130	160	170
Left/Right/Bottom	0.15	20	5	480	250	600
			10.5	210	100	600
			21.5	70	30	350
		30	4.5	550	280	600
			9.5	240	120	600
			19	90	40	440
	1	20	4.5	420	290	600
			9	180	130	320
			18.5	60	40	120
		30	2.5	590	510	600
			5.5	270	240	420
			11	110	100	180
	2	20	1	600	600	600
			2	600	600	600
			4.5	330	300	450
		30	1	600	600	600
			2.5	490	570	600
			5	220	260	290

*Screw lead 20 mm at Stroke length: 650 mm
Rated speed: 1000 mm/s
Screw lead 30 mm at Stroke length: 650 mm
Rated speed: 1500 mm/s.

Allowable moment and overhang length by mounting orientation (EKS Series)

[When wall-mounted]

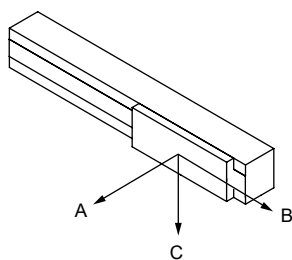

[Allowable overhang length]

● EKS-08

Motor mounted	Acceleration/deceleration G	Screw lead	Weight kg	Overhang mm		
				A	B	C
Straight	0.15	20	11.5	570	320	800
			23.5	250	140	800
			47.5	90	50	480
		40	4.5	800	640	800
			9.5	530	300	800
			19	230	130	800
	1	20	10.5	510	370	800
			21	220	160	430
			42	80	60	170
		40	4	700	740	800
			8	330	350	520
			16.5	140	150	220
	2	20	3.5	800	800	800
			7	640	580	800
			14	290	270	420
40		2	800	800	800	
		4	510	710	670	
		8.5	230	330	310	
Left/Right/Bottom	0.15	20	11.5	570	320	800
			23.5	250	140	800
			47.5	90	50	480
		40	4.5	800	680	800
			9	560	320	800
			18	240	140	800
	1	20	9.5	560	410	800
			19	250	180	470
			38.5	90	70	190
		40	3	800	800	800
			6.5	410	440	650
			13.5	180	190	290
	2	20	1.5	800	800	800
			3	800	800	800
			6.5	690	630	800
40		1.5	800	800	800	
		3	750	800	800	
		6	350	490	460	

*Screw lead 20 mm at Stroke length: 700 mm
 Rated speed: 1000 mm/s
 Screw lead 40 mm at Stroke length: 700 mm
 Rated speed: 2000 mm/s.

● EKS-10

Motor mounted	Acceleration/deceleration G	Screw lead	Weight kg	Overhang mm		
				A	B	C
Straight	0.15	25	21	730	390	1000
			42	310	170	1000
			84	110	60	680
		50	10	1000	640	1000
			20	550	290	1000
			40	220	120	1000
	1	25	16	700	520	1000
			32	310	230	550
			64.5	120	90	220
		50	4.5	1000	1000	1000
			9.5	600	670	920
			19	270	300	410
	2	25	4	1000	1000	1000
			8	1000	1000	1000
			16	550	520	750
50		1.5	1000	1000	1000	
		3.5	1000	1000	1000	
		7	620	920	800	
Left/Right/Bottom	0.15	25	21	730	390	1000
			42	310	170	1000
			84	110	60	680
		50	9	1000	680	1000
			18.5	590	310	1000
			37.5	250	130	1000
	1	25	11	1000	790	1000
			22	490	370	850
			44	210	150	380
		50	3	1000	1000	1000
			6.5	910	1000	1000
			13	420	470	650
	2	50	1	1000	1000	1000
			2.5	1000	1000	1000

*Screw lead 25 mm at Stroke length: 900 mm
 Rated speed: 1250 mm/s
 Screw lead 50 mm at Stroke length: 900 mm
 Rated speed: 2500 mm/s.

Allowable moment and overhang length by mounting orientation (EKS Series)

[When installed vertically]

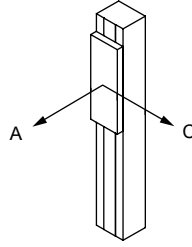

[Allowable overhang length]

● EKS-04

Motor mounted	Acceleration/deceleration G	Screw lead	Weight kg	Overhang mm	
				A	C
Straight	0.15	10	2	290	290
			4	130	130
			8.5	50	50
		16	1.5	270	270
			3.5	120	120
			7	50	50
	1	10	2	270	270
			4	120	120
			8.5	50	50
		16	1.5	270	270
			3	120	120
			6.5	50	50
	2	10	2	280	280
			4	130	130
			8	50	50
		16	1	290	290
			2.5	130	130
			5.5	50	50
Left/Right/Bottom	0.15	10	2	290	290
			4	130	130
			8.5	50	50
		16	1.5	270	270
			3.5	120	120
			7	50	50
	1	10	2	270	270
			4	120	120
			8.5	50	50
		16	1.5	270	270
			3	120	120
			6.5	50	50
	2	10	1.5	350	350
			3	160	160
			6.5	70	70
		16	1	360	360
			2	170	170
			4.5	70	70

*Screw lead 10 mm at Stroke length: 550 mm
Rated speed: 500 mm/s
Screw lead 16 mm at Stroke length: 550 mm
Rated speed: 800 mm/s.

● EKS-05

Motor mounted	Acceleration/deceleration G	Screw lead	Weight kg	Overhang mm	
				A	C
Straight	0.15	10	3	320	320
			6	140	140
			12.5	60	60
		20	1.5	420	420
			3	190	190
			6	80	80
	1	10	3	320	320
			6	140	140
			12	60	60
		20	1	400	400
			2.5	190	190
			5.5	80	80
	2	10	1	500	500
			2.5	370	370
			5	170	170
		20	1.5	280	280
			3.5	120	120
			-	-	-
Left/Right/Bottom	0.15	10	2.5	350	350
			5.5	160	160
			11.5	60	60
		20	1	460	460
			2.5	210	210
			5.5	90	90
	1	10	2.5	370	370
			5	170	170
			10.5	70	70
		20	1	500	500
			2	240	240
			4.5	100	100
	2	10	1	500	500
			2	470	470
			4	220	220
		20	1.5	330	330
			3	150	150
			-	-	-

*Screw lead 10 mm at Stroke length: 600 mm
Rated speed: 500 mm/s
Screw lead 16 mm at Stroke length: 600 mm
Rated speed: 1000 mm/s.

● EKS-06

Motor mounted	Acceleration/deceleration G	Screw lead	Weight kg	Overhang mm	
				A	C
Straight	0.15	20	3	440	440
			6	200	200
			12.5	80	80
		30	2	600	600
			4	340	340
			8	150	150
	1	20	2.5	450	450
			5.5	210	210
			11	90	90
		30	1.5	600	600
			3	330	330
			6.5	150	150
	2	20	1.5	600	600
			3	370	370
			6	170	170
		30	1	600	600
			2	420	420
			4.5	190	190
Left/Right/Bottom	0.15	20	2.5	510	510
			5.5	240	240
			11	100	100
		30	1.5	600	600
			3.5	390	390
			7	180	180
	1	20	2	560	560
			4.5	260	260
			9	110	110
		30	1	600	600
			2.5	440	440
			5	200	200
	2	20	1	600	600
			2.5	450	450
			-	-	-
		30	1.5	600	600
			3	310	310
			-	-	-

*Screw lead 20 mm at Stroke length: 650 mm
Rated speed: 1000 mm/s
Screw lead 30 mm at Stroke length: 650 mm
Rated speed: 1500 mm/s.

Allowable moment and overhang length by mounting orientation (EKS Series)

[When installed vertically]

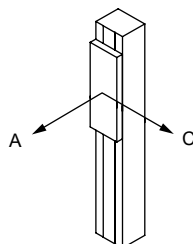

[Allowable overhang length]

● EKS-08

Motor mounted	Acceleration/deceleration G	Screw lead	Weight kg	Overhang mm	
				A	C
Straight	0.15	20	6	670	670
			12	320	320
			24.5	140	140
		40	2.5	800	800
			5.5	520	520
			11.5	240	240
	1	20	5	690	690
			10.5	330	330
			21.5	150	150
		40	2	800	800
			4	510	510
			8.5	240	240
	2	20	2	800	800
			4	800	800
			8.5	380	380
		40	1	800	800
			2.5	670	670
			5.5	320	320
Left/Right/Bottom	0.15	20	5.5	730	730
			11	350	350
			22.5	160	160
		40	2.5	800	800
			5	610	610
			10	290	290
	1	20	4.5	800	800
			9	400	400
			18	180	180
		40	1.5	800	800
			3.5	630	630
			7	300	300
	2	20	1.5	800	800
			3.5	800	800
			-	-	-
		40	1	800	800
			2	800	800
			4	450	450

*Screw lead 20 mm at Stroke length: 700 mm
 Rated speed: 1000 mm/s
 Screw lead 40 mm at Stroke length: 700 mm
 Rated speed: 2000 mm/s.

● EKS-10

Motor mounted	Acceleration/deceleration G	Screw lead	Weight kg	Overhang mm			
				A	C		
Straight	0.15	25	9	950	950		
			18.5	450	450		
			37	200	200		
			50	4	1000	1000	
				8.5	760	760	
				17	360	360	
		1	25	7	1000	1000	
				14	530	530	
				28	240	240	
			50	2.5	1000	1000	
				5	850	850	
				10.5	400	400	
	2	25	2	1000	1000		
			4.5	1000	1000		
			9.5	720	720		
			50	1	1000	1000	
				2.5	1000	1000	
				5	730	730	
		Left/Right/Bottom	0.15	25	8	1000	1000
					16	520	520
					32.5	240	240
				50	3.5	1000	1000
					7	900	900
					14.5	430	430
1	25		5	1000	1000		
			10.5	720	720		
			21	340	340		
	50		1.5	1000	1000		
			3.5	1000	1000		
			7.5	580	580		
2	50	1	1000	1000			
		2	1000	1000			

*Screw lead 25 mm at Stroke length: 900 mm
 Rated speed: 1250 mm/s
 Screw lead 50 mm at Stroke length: 900 mm
 Rated speed: 2500 mm/s.

Table of Load Capacity by Acceleration/deceleration

[EKS Series (straight motor mounting)]

*The table below lists the max. load capacity at each acceleration/deceleration.
Refer to the model that satisfies the required operation conditions.

When installed horizontally

Unit: kg

Model	Screw lead	Acceleration/deceleration (G)					
		0.15	0.3	0.5	1	1.5	2
EKS-04	10	19	19	19	19	18	12
	16	14	14	14	14	11.5	8.5
EKS-05	10	26	26	26	25.5	13.5	7.5
	20	7.5	7.5	7.5	7.5	7.5	5.5
EKS-06	20	47.5	47.5	42	27	15	9
	30	20.5	20.5	20.5	14	10	7.5
EKS-08	20	83.5	83.5	83.5	49	25.5	14
	40	19	19	19	16.5	11	8.5
EKS-10	25	171.5	171.5	118.5	64.5	33.5	16
	50	40	40	40	19	11	7

* 2G or more may also be supported in some cases. Contact CKD for details.

When wall-mounted

Unit: kg

Model	Screw lead	Acceleration/deceleration (G)					
		0.15	0.3	0.5	1	1.5	2
EKS-04	10	11	10.5	10.5	10	10	9.5
	16	8.5	8.5	8	7.5	7	7
EKS-05	10	19.5	19	19	18	13.5	7.5
	20	7.5	7.5	7.5	7.5	7.5	5.5
EKS-06	20	21.5	21	20	18.5	15	9
	30	20.5	19.5	18	14	10	7.5
EKS-08	20	47.5	46.5	45	42	25.5	14
	40	19	19	19	16.5	11	8.5
EKS-10	25	84	79.5	76	64.5	33.5	16
	50	40	40	40	19	11	7

* 2G or more may also be supported in some cases. Contact CKD for details.

When installed vertically

Unit: kg

Model	Screw lead	Acceleration/deceleration (G)					
		0.15	0.3	0.5	1	1.5	2
EKS-04	10	8.5	8.5	8.5	8.5	8.5	8
	16	7	7	7	6.5	6.5	5.5
EKS-05	10	12.5	12.5	12.5	12	8	5
	20	6	6	6	5.5	5	3.5
EKS-06	20	12.5	12.5	12	11	8.5	6
	30	8	8	7.5	6.5	5.5	4.5
EKS-08	20	24.5	24	23.5	21.5	14.5	8.5
	40	11.5	11	10.5	8.5	7	5.5
EKS-10	25	37	35.5	33.5	28	19	9.5
	50	17	16	14.5	10.5	7.5	5

* 2G or more may also be supported in some cases. Contact CKD for details.

Table of Load Capacity by Acceleration/deceleration

[EKS Series (motor mounting on side/bottom)]

*The table below lists the max. load capacity at each acceleration/deceleration.
Refer to the model that satisfies the required operation conditions.

When installed horizontally

Unit: kg

Model	Screw lead	Acceleration/deceleration (G)					
		0.15	0.3	0.5	1	1.5	2
EKS-04	10	19	19	19	19	15.5	10.5
	16	14	14	14	14	10.5	7.5
EKS-05	10	26	26	26	22	11.5	6
	20	7.5	7.5	7.5	7.5	7.5	5
EKS-06	20	44.5	44.5	41	20.5	10	4.5
	30	19	19	19	11	7.5	5
EKS-08	20	79.5	79.5	79.5	38.5	17	6.5
	40	18	18	18	13.5	8.5	6
EKS-10	25	161.5	150	92.5	44	16.5	0.5
	50	37.5	37.5	37.5	13	6	2.5

* 2G or more may also be supported in some cases. Contact CKD for details.

When wall-mounted

Unit: kg

Model	Screw lead	Acceleration/deceleration (G)					
		0.15	0.3	0.5	1	1.5	2
EKS-04	10	11	10.5	10.5	10	10	9.5
	16	8.5	8.5	8	7.5	7	7
EKS-05	10	19.5	19	19	18	11.5	6
	20	7.5	7.5	7.5	7.5	7.5	5
EKS-06	20	21.5	21	20	18.5	10	4.5
	30	19	19	18	11	7.5	5
EKS-08	20	47.5	46.5	45	38.5	17	6.5
	40	18	18	18	13.5	8.5	6
EKS-10	25	84	79.5	76	44	16.5	0.5
	50	37.5	37.5	37.5	13	6	2.5

* 2G or more may also be supported in some cases. Contact CKD for details.

When installed vertically

Unit: kg

Model	Screw lead	Acceleration/deceleration (G)					
		0.15	0.3	0.5	1	1.5	2
EKS-04	10	8.5	8.5	8.5	8.5	8.5	6.5
	16	7	7	7	6.5	6	4.5
EKS-05	10	11.5	11.5	11.5	10.5	6.5	4
	20	5.5	5.5	5	4.5	4.5	3
EKS-06	20	11	11	10.5	9	5.5	2.5
	30	7	7	6.5	5	4.5	3
EKS-08	20	22.5	21.5	20.5	18	9.5	3.5
	40	10	10	9	7	5.5	4
EKS-10	25	32.5	30.5	28	21	8.5	-
	50	14.5	14	12.5	7.5	4	2

* 2G or more may also be supported in some cases. Contact CKD for details.

Origin sensor, limit sensor (motorless option)

[Specifications]

Item		Specifications
Manufacturer	Manufacturer	OMRON Corporation
	Model	EE-SX674
Hysteresis		0.025 mm or less
Light source (peak emission wavelength)		GaAs infrared LED (940 nm)
Indicator lamp		ON when receiving light (red)
Power supply voltage		5 to 24 VDC $\pm 10\%$ ripple (P-P) 10% or less
Current consumption		12 mA or less (with L terminal open)
Control output	Type	NPN (NPN open collector)
	Output	5 to 24 VDC 100mA or less
	Current when OFF	0.5 mA or less
	Residual voltage	0.8 V or less (with 100 mA load current) 0.4 V or less (with 40 mA load current)
Operating ambient illumination		Light-receiving surface luminance Fluorescent light: 1,000 lx or less
Ambient temperature range	Operating	-25 to +55°C, no condensation or freezing
	In storage	-30 to +80°C, no condensation or freezing
Ambient humidity range	Operating	5 to 85% RH, no condensation or freezing
	In storage	5 to 95% RH, no condensation or freezing
Degree of protection		IP50 IEC 60529 Standards
Connection		Connector type (can be directly soldered)

*For connectors, see "Photomicrosensor accessories" in the OMRON EE-SX47 catalog.

Output circuit

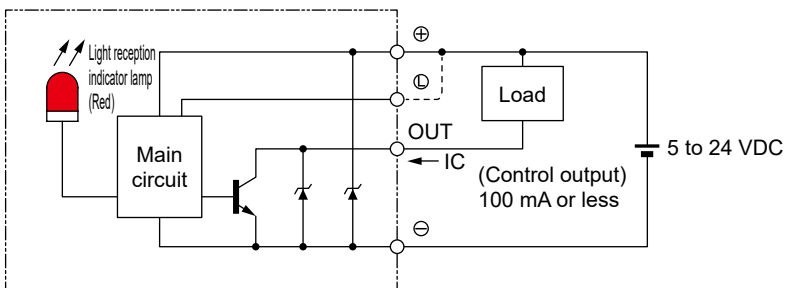

Wiring diagram

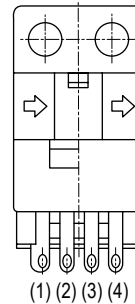

Terminal layout

(1)	⊕	Vcc
(2)	L	L
(3)	OUT	OUTPUT
(4)	⊖	GND (0 V)

List of attachments

For straight motor mounting

Accessories: Intermediate flange, coupling, motor mounting bolts

List of attachments

Model No.	Mounted motor specification	Motor capacity	Included parts			
			Intermediate flange mounting bolt		Motor mounting bolt	
			Size	Quantity	Size	Quantity
EKS-04	M	50 W 100 W	M3	2	M4	4
	Y				M4	
	P				M3	
EKS-05	M	100 W	M3	2	M4	4
	Y				M4	
	P				M3	
EKS-06	M	200 W	M4	4	M5	4
	Y				M5	
	P				M4	
EKS-08	M	400 W	M4	4	M5	4
	Y				M5	
	P				M4	
EKS-10	M	750 W	M5	4	M6	4
	Y				M6	
	P				M5	

For motor mounting on side/bottom

Accessories: Motor mounting plate, pulley, timing belt, belt tension adjustment jig, motor mounting bolts

List of attachments

Model No.	Mounted motor specification	Motor capacity	Included parts			
			Motor mounting plate mounting bolt		Motor mounting bolt	
			Size	Quantity	Size	Quantity
EKS-04	M	50 W 100 W	M3	4	M4	4
	Y				M4	
	P				M3	
EKS-05	M	100 W	M3	4	M4	4
	Y				M4	
	P				M3	
EKS-06	M	200 W	M4	4	M5	4
	Y				M5	
	P				M4	
EKS-08	M	400 W	M4	4	M5	4
	Y				M5	
	P				M4	
EKS-10	M	750 W	M5	4	M6	4
	Y				M6	
	P				M5	