

INSTRUCTION MANUAL

MICRO alescer
{MICRO-naught type
(for oil removal)}

1219

- Please read this instruction manual carefully before using this product, particularly the section describing safety.
- Retain this instruction manual with the product for further consultation whenever necessary.

For Safety Use

To use this product safely, basic knowledge of pneumatic equipment, including materials, piping, electrical system and mechanism, is required (to the level pursuant to JIS B 8370 Pneumatic System Rules).

We do not bear any responsibility for accidents caused by any person without such knowledge or arising from improper operation.

Our customers use this product for a very wide range of applications, and we cannot keep track of all of them. Depending on operating conditions, the product may fail to operate to maximum performance, or cause an accident. Thus, before placing an order, examine whether the product meets your application, requirements, and how to use it.

This product incorporates many functions and mechanisms to ensure safety. However, improper operation could result in an accident. To prevent such accidents, read this instruction manual carefully for proper operation.

Observe the cautions on handling described in this manual, as well as the following instructions:

Precautions

- The filter and the lubricator use a plastic bowl. Do not use them with an organic solvent. The bowl will be damaged. With an organic solvent, use a filter and a lubricator containing a metal bowl.

INDEX

1219

MICRO alescser

Manual No. SM-197975-A

1. CAUTION	1
2. INSTALLATION	2
3. OPERATION	3
4. MAINTENANCE	
4.1 Regular check	4
4.2 Troubles and corrective measures	4
5. CONSUMABLES AND REPAIR KITS	5
6. BOWL REMOVAL AND FITTING	6
7. MANTLE REPLACEMENT	6

NOTE: Letters & figures enclosed within Gothic style bracket
(examples such as [C2-4PP07] · [V2-503-B] etc.) are editorial
symbols being unrelated with contents of the book.

1. CAUTION

- 1) Refer to the catalog for the product specifications and model markings.
- 2) Do not use the alescra in a place exposed to the direct sun.
- 3) Be sure that the pressure of the compressed air is no more than 1.0 MPa.
- 4) Do not use the product in a place where the ambient temperature is 54 °C or more.
- 5) The presence of the following gases in the compressed air corrodes the mantle or causes it to swell. Avoid the use of the alescra in a place where such gases may enter the compressed air.
 - Sulfur dioxide
 - Chlorine gas
 - High-density ozone
 - Aromatic hydrocarbon compound (ex. benzene, toluene, phenol, cyclohexane, etc.)
 - Chlorine hydrogen compound (ex. trichloroethylene, chloroform, etc.)
 - Ketone (ex. acetone, etc.)
 - Aldehyde (ex. formaldehyde, acetaldehyde, etc.)
 - Amines (ex. ethylamine, methylamine, etc.)
- 6) As the polycarbonate resin is used, never use it in an atmosphere of organic solvent. The product's chemical resistance changes depending on the material of the bowl. Refer to the catalog for the details.

2. INSTALLATION

- 1) Install the alescra as close to the air pressure equipment as possible.
- 2) Be sure to set a pre-filter, either air filter (5 μ m) or sub-micron type (0.3 μ m), before the MICRO alescra.
- 3) Be sure that the air flows in the direction indicated on the product.
- 4) Set the alescra in a way that its bowl faces downward.
- 5) Sealing tape or a sealing agent is used for piping. Be sure to leave two threads from the end of the screw as shown in the drawings so as to prevent fragments of the tape or the agent from entering the pipe or the equipment.

● Sealing tape

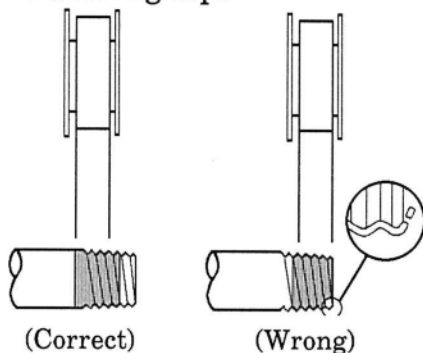

● Solid sealing agent

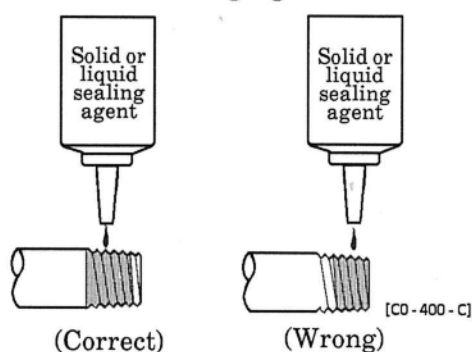

- 6) Be sure to remove the cutting oil or rust-proof oil for the piping.

- 7) When installing the optional bracket, use the screws (self-tapping screws) that come with the bracket.

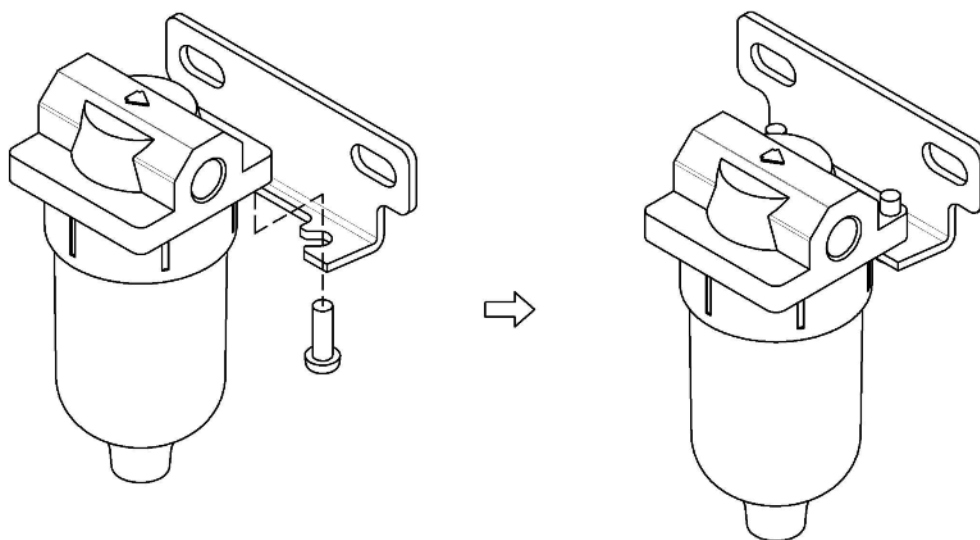

- 8) For operation and maintenance purpose, keep open space below bowl of 50mm or more.

3. OPERATION

1) Draining

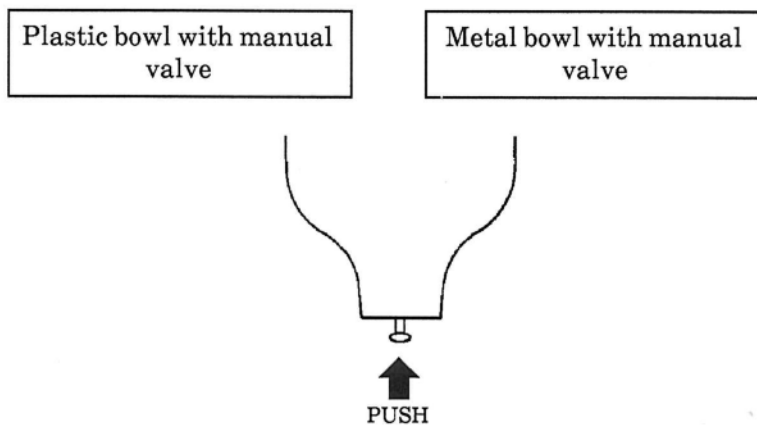

Push up the valve (in the direction indicated by the arrow) to drain the bowl, and release it to stop draining.

4. MAINTENANCE

Be sure that no pressure remains inside the product by stopping the compressed air and releasing the remaining pressure by manually operating the cock or through other means. With this done, then take out the bowl.

4.1 Regular check

- 1) Drain the bowl regularly so that the collected fluid does not exceed the drain limit.

Refer to the previous page for the method of draining.

- 2) Replace the mantle regularly so as to prevent pressure loss.

- Mantle (MICRO-naught type for oil removal)

The mantle is at the end of its operation life when the differential pressure becomes 0.07 MPa. Replace it with a new one.

(Mantle model: 1219-MANTLE-ASSY)

4.2 Troubles and corrective measures

Troubles	Causes	Measures
Draining immediately after MICRO alescra (MICRO-naught)	Collected fluid level exceeds the limit	Drain the fluid (see the procedures on Page 3)
Inadequate flow, large pressure drop	Clogged mantle	Stop the compressed air, remove the bowl and replace the mantle with a new one.
No draining with the drain valve open	Clogged path to the discharge port	Stop the compressed air, disassemble the bowl unit and clean or replace the unit.
Air leak from the bowl joint	Scratched O-ring or impurities attaching to it.	Stop the compressed air, take out the bowl and clean or replace the O-ring.
	Damaged bowl	Stop the compressed air, take out the bowl and replace it.

5. CONSUMABLES AND REPAIR KITS

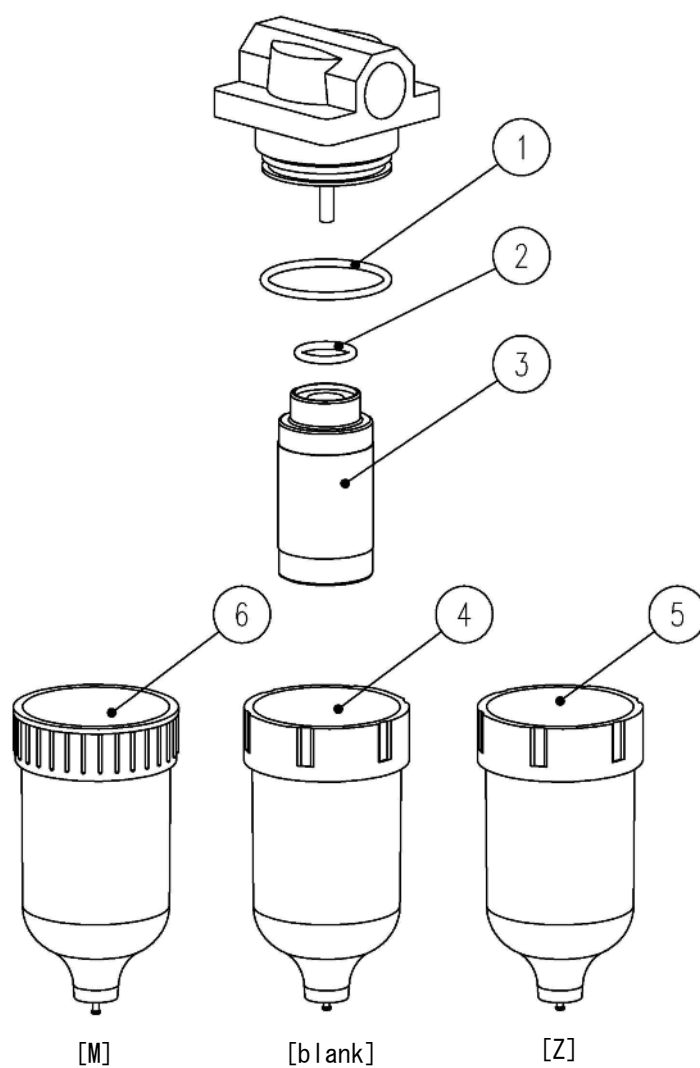

Part name	Part model No.	No.	Quantity
Consumable parts kit	1219-KIT	①、②、③	1 each
Mantle assembly	1219-MANTLE-ASSY	②、③	1 each
Bowl assembly (blank)	A1019-BOWL	①、④	1 each
Bowl assembly (Z)	A1019-BOWL-Z	①、⑤	1 each
Bowl assembly (M)	A1019-BOWL-M	①、⑥	1 each
O-ring* 5 pieces are included in one set.	A1019-ORING	①	5

6. BOWL REMOVAL AND FITTING

Stop the compressed air and use the manual cock or other means to release the remaining pressure. Be sure that there is no pressure left inside the product before taking out the bowl.

- 1) Turn the bowl counterclockwise until the screw part is completely detached.
- 2) Pull it down to detach the bowl.
- 3) When reattaching the bowl, reverse the above procedures.
- 4) Before letting in the compressed air, check that the bowl is completely screwed in (no space between the body and the bowl).

7. MANTLE REPLACEMENT

- 1) Take out the bowl by the procedures described in 6. above.
- 2) Turn the mantle counterclockwise (to the left) to remove it.
 - Note 1 : To remove or set the mantle, use the hexagonal hole or the side of the bottom end plate.
 - 2 : When removing or setting the mantle, never touch the plastic foam layer (spongelike part) of the mantle. Any contact with the layer will negatively affect the system's performance.
- 3) Set the new mantle.
- 4) Reverse the above procedures to put back the mantle and bowl.
- 5) Be sure to carry out the procedure (6. 4) above before letting in the compressed air.