

Discontinue

CSM - 0055-A

SM- 6062

INSTRUCTION MANUAL
FOR
RELIEF VALVE
MODEL NO. 6062

Please read this operation manual carefully before using this product, particularly the section describing safety.

Retain this operation manual with the product for further consultation whenever necessary.

For Safety Use

To use this product safely, basic knowledge of pneumatic equipment, including materials, piping, electrical system and mechanism, is required (to the level pursuant to JIS B 8370 Pneumatic System Rules).

We do not bear any responsibility for accidents caused by any person without such knowledge or arising from improper operation.

Our customers use this product for a very wide range of applications, and we cannot keep track of all of them. Depending on operating conditions, the product may fail to operate to maximum performance, or cause an accident. Thus, before placing an order, examine whether the product meets your application, requirements, and how to use it.

This product incorporates many functions and mechanisms to ensure safety. However, improper operation could result in an accident. To prevent such accidents, read this operation manual carefully for proper operation.

Model Number:

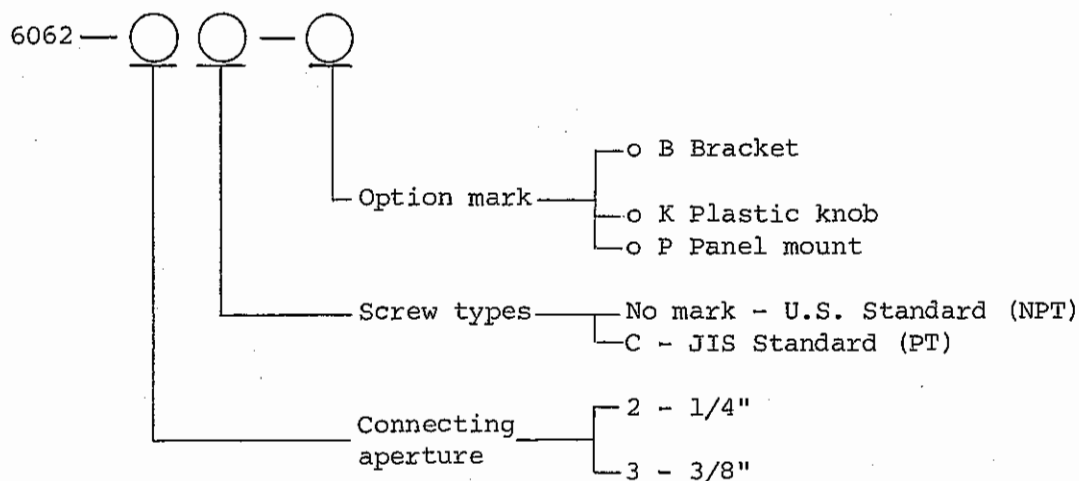

Thank you very much for using CKD products.

CKD products are all produced under strict quality control to ensure safety.

For effective use of your CKD relief valve, carefully read through the items of cautions for installation and maintenance listed below.

1. Cautions for Installation

- 1-1 See to it, at the time of installation, that the air flows in the direction of arrow mark on the air inlet.
- 1-2 Use the same connecting pipe size with the pipe size as much as possible.
- 1-3 Keep the space over 50 mm to enable removal of parts for overhaul.
- 1-4 Attach the pressure gauge to an easily visible place, and close the hole on the opposite side with a plug.
- 1-5 The set pressure increases by turning the adjusting screw clockwise and decreases by turning it counter-clockwise.
- 1-6 Do not use the relief valve at a place with the ambient temperature exceeding 65°C.

- 1-7 To mount on the panel, drill holes of 17 mm diameter.
- 1-8 Tightening the nut attached to the adjusting screw to the direction of a cover will lock the nut itself.
So the adjusting screw will not rotate.
- 1-9 As to pressure setting, set the pressure a little higher than the necessary pressure at first, and then lower by relieving (by turning counter-clockwise) the pressure.
- 1-10 This relief valve can be mounted to any desired direction.
2. Cautions for maintenance
- Under ordinary using condition, no maintenance is required, to disassemble, follow the procedures given below;
- 2-1) Disassembly procedures
- a) Stop supplying air to the relief valve
 - b) Loosen the adjusting screw (1) completely by turning counter-clockwise all the way.
 - c) Unscrew 4 pieces of screw (3) to remove the cover (4).
 - d) Disassemble the spring disk (6), spring (7) and the diaphragm ass'y (9).
 - e) Remove the bottom plug (15) after loosening.
 - f) Remove O ring (11), (14), spring (13) and the valve seat (12).

The screw (3) should be tightened to 2 to 2.5 N·m torque with a torque wrench, when reassembling.

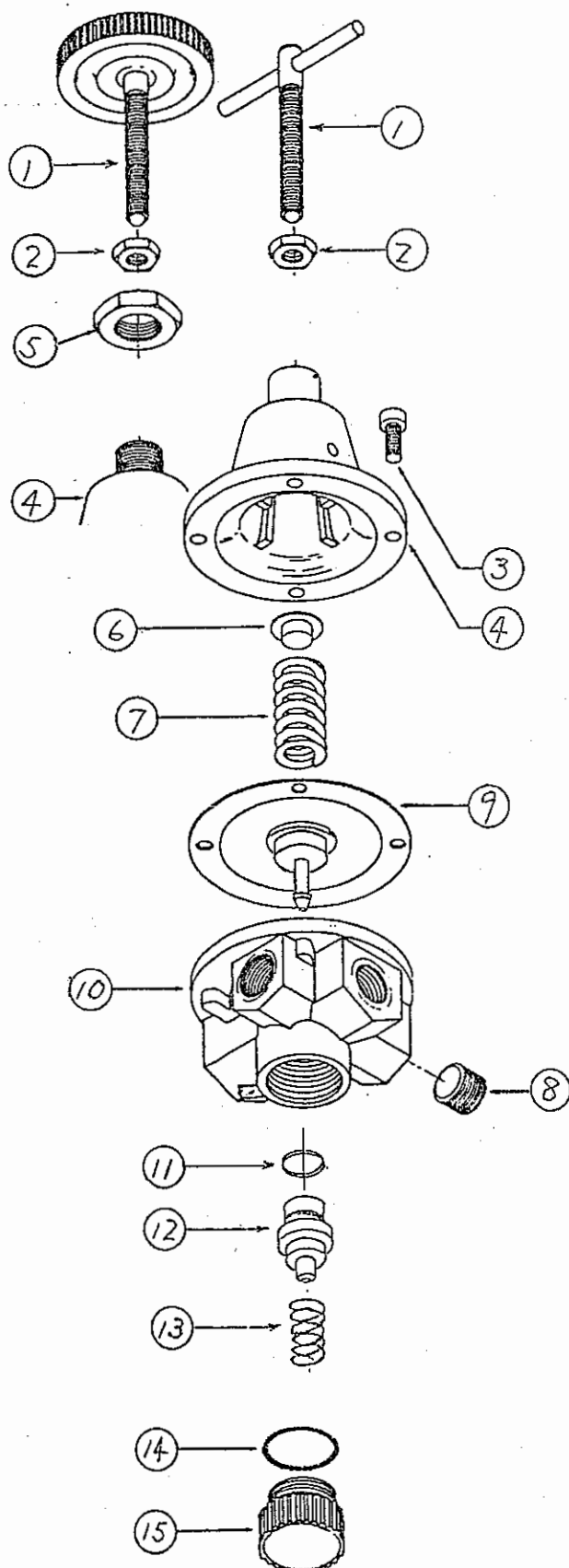

No.	Part name	Part No.	Q'ty	Remarks
1	Adjusting screw	15-5462	1	
1	Plastic knob ass'y	15-5464	1	For plastic knob
2	Nut	41-5033	1	
3	Screw	45-086	4	
4	Cover	06-5140	1	
4	Cover	06-5142	1	For panel mount
5	Nut	30-5788	1	For panel mount
6	Spring disk	30-5429	1	
7	Spring	70-5020	1	
8	Pipe plug	43-002-1	2	Attendant
9	Diaphragm ass'y	15-5369	1	Expendable part
10	Body ass'y	15-5370	1	
11	O ring	78-5054	1	Expendable part
12	Valve seat	30-5431	1	
13	Spring	70-013	1	
14	O ring	78-069	1	Expendable part
15	Bottom plug	16-104	1	