

Components for integrated gas supply system

Air operated valve for IAGD5

(Size 1.125")

Made-to-order product

■ MAGD Series is back with a new eco-friendly design!

Specifications



Item	MAGD5-R-0	MAGD5-R-1
Working fluid	Inert gas/process gas	
Working pressure Pa (abs) to MPa (G)	1.3×10 ⁻⁶ to 0.99	1.3×10 ⁻⁶ to 0.7
Fluid temperature °C	-10 to 80	
Ambient temperature °C	-10 to 80	
Valve seat leakage Pa·m ³ /s.He	1.3×10 ⁻⁹ or less	1.0×10 ⁻¹⁰ or less
External leakage Pa·m ³ /s.He	2.8 x 10 ⁻¹² or less	
Cv (23°C, under pressurization)	0.1	0.26
Connection	1.125", W seal (nominal 6.35)	
Operating pressure MPa	NC	0.4 to 0.6
	NO	0.4 to 0.5
Operating port	M5	
Material	Body	SUS316L
	Diaphragm	Ni-Co alloy
	Seat	PCTFE

How to order

MAGD5 - R - 02A - W - 1 2

A Series

B Valve shape

C Seal shape

D Actuation (V1)

E Actuation (V2)

Code	Description
A Series	
MAGD5	Air operated valve for IAGD5
B Valve shape	
01D	1-station block D valve (2-port)
01X	1-station block X valve (3-port)
01Y	1-station block Y valve (3-port)
02A	2-station block A valve (3-port)
11D	1-station block D valve (2-port)
12A	2-station block A valve (3-port)
C Seal shape	
W	1.125", W seal (nominal 6.35)
D Actuation (V1)	
1	NC
2	NO
3	NC (with proximity sensor (Normally Closed valve))
4	NO (with proximity sensor (Normally Open valve))
5	NC (with proximity sensor (Normally Open valve))
6	NO (with proximity sensor (Normally Closed valve))
E Actuation (V2)	
1	NC
2	NO
3	NC (with proximity sensor (Normally Closed valve))
4	NO (with proximity sensor (Normally Open valve))
5	NC (with proximity sensor (Normally Open valve))
6	NO (with proximity sensor (Normally Closed valve))

[Example of model No.]

MAGD5-R-02A-W-12

- A Series : Air operated valve for IAGD5
- B Valve shape : 2-station block A valve (3-port)
- C Seal shape : 1.125", W seal (nominal 6.35)
- D Actuation (V1) : NC
- E Actuation (V2) : NO

*1: Mounting bolt, gasket and air fitting for actuator drive are not attached with the product and must be purchased separately.

*2: Contact CKD for products with mounting bolts.

Dimensions

1-station block

●MAGD5-R-01D

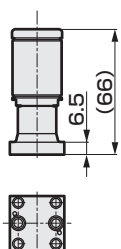
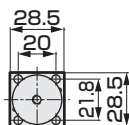

(with proximity sensor)

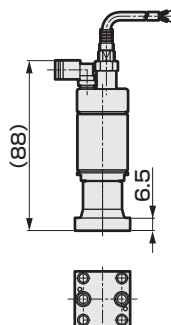
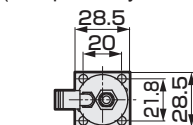

●MAGD5-R-01X

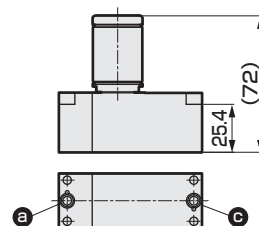
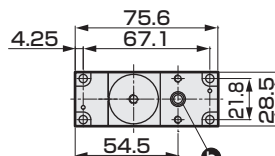

(with proximity sensor)

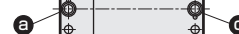
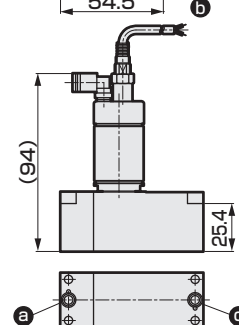
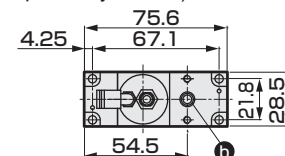

●MAGD5-R-01Y

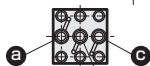
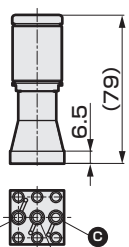
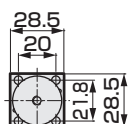

(with proximity sensor)

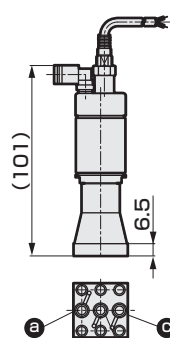
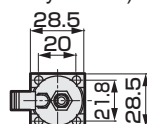

●MAGD5-R-11D

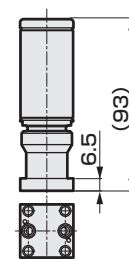
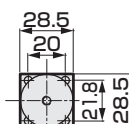

(with proximity sensor)

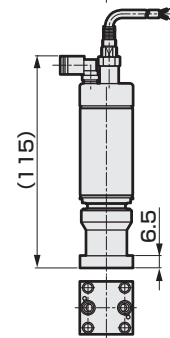
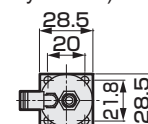

2-station block

●MAGD5-R-02A

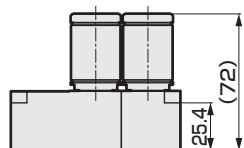
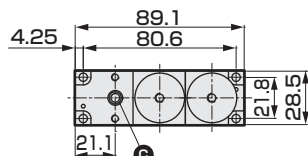

(with proximity sensor)

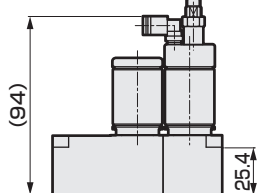
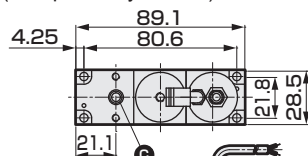

●MAGD5-R-12A

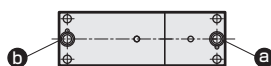
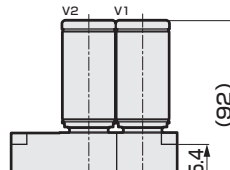
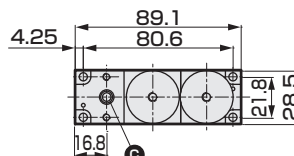

(with proximity sensor)

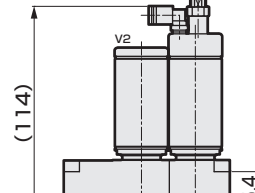
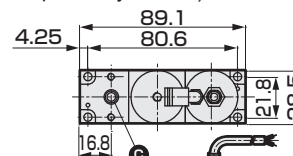

Components for integrated gas supply system

Manual valve for IAGD5

(Size 1.125")

Made-to-order product



Specifications

Item	MMGD5-R
Working fluid	Inert gas/process gas
Working pressure Pa(abs)-MPa(G)	1.3×10^{-6} to 0.99
Fluid temperature °C	5 to 80
Ambient temperature °C	5 to 80
Valve seat leakage Pa·m ³ /s (He)	1.0×10^{-10} or less
External leakage Pa·m ³ /s (He)	2.8×10^{-12} or less
Cv	0.26
Connection	1.125", W seal (nominal 6.35)
Material	Body
	SUS316L
	Diaphragm
	Ni-Co alloy
	Seat
	PCTFE

How to order

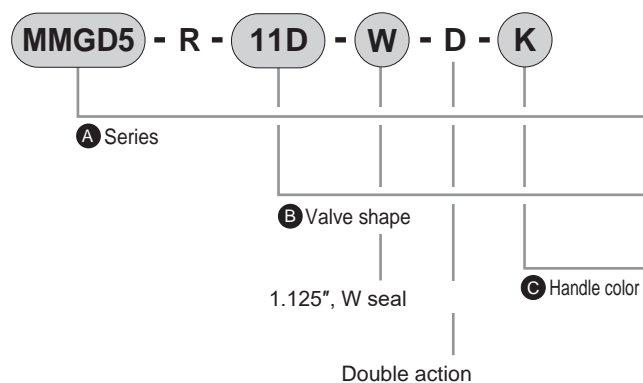

Code	Description	
A Series		Cv
MMGD5	Manual valve for IAGD5	0.26
B Valve shape		
11D	1-station block D valve (2-port)	
C Handle color		
K	Handle color: Black	
R	Handle color: Red	
B	Handle color: Blue	
Y	Handle color: Yellow	
GR	Handle color: Gray	
W	Handle color: White	
O	Handle color: Orange	
YG	Handle color: Yellow-green	

[Example of model No.]

MMGD5-R-11D-W-D-K

- A** Series : Manual valve for IAGD5
B Valve shape : 1-station block D valve (2-port)
C Handle color : Black

Components for integrated gas supply system

Flow rate adjusting valve for IAGD5

(Size 1.125")

Made-to-order product



Specifications

Item	MFGD5-11D-W-1	MFGD5-11D-W-4
Working fluid	Inert gas/process gas	
Working pressure Pa(abs)-MPa(G)	1.3 × 10 ⁻⁶ to 0.7	
Fluid temperature °C	-10 to 80	
Ambient temperature °C	-10 to 80	
Valve seat leakage	1/100 or less of max. Cv	
External leakage Pa·m ³ /s (He)	2.8 × 10 ⁻¹² or less	
Cv (adjusting range)	0.003 to 0.03	0.02 to 0.2
Connection	1.125", W seal (nominal 6.35)	
Material	Body	SUS316L
	Diaphragm	Ni-Co alloy

* Cover is included with the product.

How to order

MFGD5 - 11D - W - 1

A Series

B Valve shape

C Seal shape

D Cv
(adjusting range)

Code	Description
A Series	
MFGD5	Flow rate adjusting valve for IAGD5
B Valve shape	
11D	1-station block D valve (2-port)
C Seal shape	
W	1.125", W seal (nominal 6.35)
D Cv (adjusting range)	
1	Cv (adjusting range) 0.003 to 0.03
4	Cv (adjusting range) 0.02 to 0.2

*1: Mounting bolt and gasket are not attached with the product and must be purchased separately.

*2: Contact CKD for products with mounting bolts.

[Example of model No.]

MFGD5-11D-W-1

A Series : Flow rate adjusting valve for IAGD5

B Valve shape : 1-station block D valve (2-port)

C Seal shape: 1.125", W seal (nominal 6.35)

D Other : Cv (adjusting range) 0.003 to 0.03

Dimensions

● MFGD5

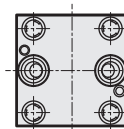
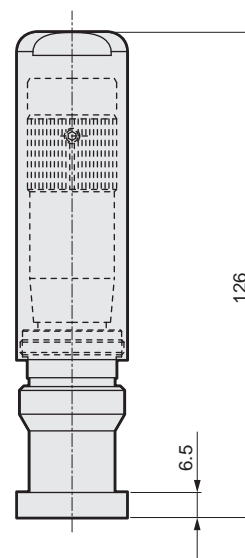
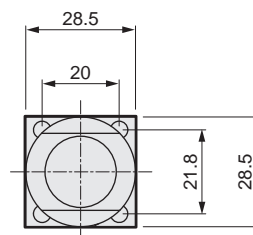



Specifications

Descriptions	MCNP5-01D	MCNP5-F
Working fluid	Inert gas/process gas	
Working pressure Pa(abs)-MPa(G)	1.3×10^{-6} to 0.7	
Fluid temperature °C	-10 to 80	
Ambient temperature °C	-10 to 80	
Valve seat leakage Pa·m ³ /s (He)	4.7×10^{-8} or less	
External leakage Pa·m ³ /s (He)	2.8×10^{-12} or less	
Cv (max.)	0.25	
Connection	1.125", W seal (nominal 6.35)	
Material	Body	SUS316L
	Seat	Kalrez®
	Spring	SUS316

How to order

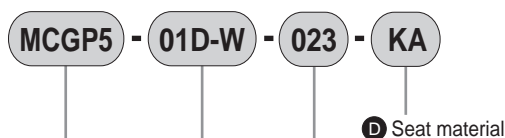

Code	Description
A Series	
MCNP5	Check valve for IAGD5
B Shape	
01D-W	1-station block D valve (2-port) 1.125", W seal (nominal 6.35)
F1	Flow direction From JXR fitting side to W seal side
F2	Flow direction From W seal side to JXR fitting side
C Cracking pressure	
023	Cracking pressure 2.3kPa
D Seat material	
KA	Seat material Kalrez®

Dimensions

● MCNP5-01D

● MCNP5-F*

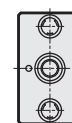
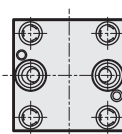
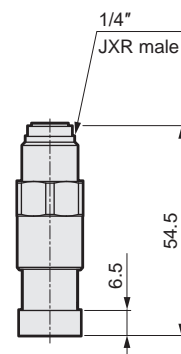
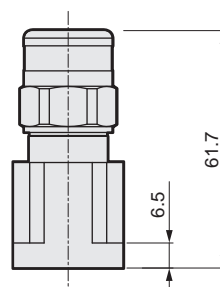
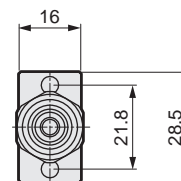
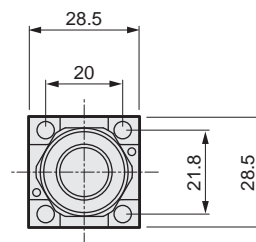

*1: Mounting bolt and gasket are not attached with the product and must be purchased separately.

*2: Contact CKD for products with mounting bolts.

[Example of model No.]

MCNP5-01D-W-023-KA

- A Series : Check valve for IAGD5
- B Shape : 1-station block D valve (2-port)
: 1.125", W seal (nominal 6.35)
- C Cracking pressure : 2.3kPa
- D Seat material : Kalrez®

Gasket

Name	Model No.
1.125", W seal gasket (nominal 6.35)	IAGD5-UGC-6.35GR



1.125", Mounting bolt for W seal



Name	Model No.	Applicable parts
1.125", Hexagon socket head cap screw for W seal (M5 x 4, 10, 1 pcs)	IAGD5-BOLT-M4×10	MAGD5-R-01D MAGD5-R-01Y MAGD5-R-11D MMGD5-1DV2-D MCGP5-01D MCGP5-F* MFGD5-11D IAGD5-BYPASS Bypass piping block IAGD5-BLIND-SW
1.125", Hexagon socket head cap screw for W seal (M5 x 4, 30, 1 pcs)	IAGD5-BOLT-M4×30	MAGD5-R-01X MAGD5-R-02A FC-PA785CT-BW-TC (MFC manufactured by Hitachi Metals) FC-PA786CT-BW-TC (MFC manufactured by Hitachi Metals) DN780*-BW (MFC manufactured by Hitachi Metals) SEC-Z5* (MFC manufactured by Horiba Estek)

Contact CKD for details of applicable parts.

Maintenance tools (Torque screwdriver, bit for torque screwdriver, T handball point wrench, tweezers (gasket installation tool), scissors, storage box 1 each)

Name	Model No.
Maintenance tool set	IAGD5-MAINTENANCE3

Refer to the instruction manual for details of use.



Top mount block

- IAGD5-BYPASS
(for 20 mm pitch between)

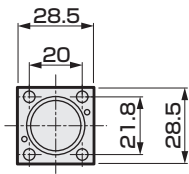

- Bypass piping block
(for 79.8 mm pitch between MFC)

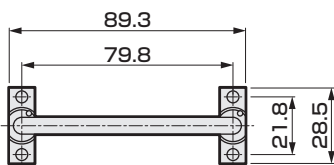

- IAGD5-BLIND-SW

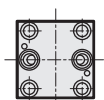
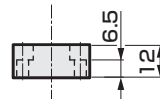
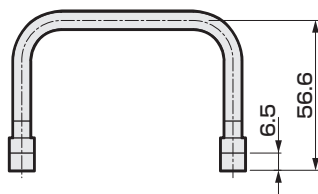
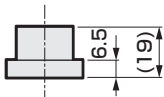
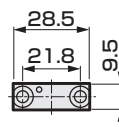

Base block

- IAGD5-BF-V10-SW
(10 mm between)

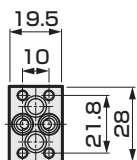

- IAGD5-BF-V14-SW
(14.0 mm between)

