

INSTRUCTION MANUAL

FOR

RESIDUAL PRESSURE EXHAUST VALVE

V3000

Please read this operation manual carefully before using this product, particularly the section describing safety.

Retain this operation manual with the product for further consultation whenever necessary.



CKD Corporation

For Safety Use

To use this product safely, basic knowledge of pneumatic equipment, including materials, piping, electrical system and mechanism, is required (to the level pursuant to JIS B 8370 Pneumatic System Rules).

We do not bear any responsibility for accidents caused by any person without such knowledge or arising from improper operation.

Our customers use this product for a very wide range of applications, and we cannot keep track of all of them. Depending on operating conditions, the product may fail to operate to maximum performance, or cause an accident. Thus, before placing an order, examine whether the product meets your application, requirements, and how to use it.

This product incorporates many functions and mechanisms to ensure safety. However, improper operation could result in an accident. To prevent such accidents, read this operation manual carefully for proper operation.

CONTENTS

1. How to Read the Model No.	1
2. Cautions for Installation	1
3. Cautions for Maintenance	2
4. Expendable Parts List	3

Thank you very much for using CKD products.
CKD products are all produced under strict quality control to ensure safety.

For effective use of your CKD residual pressure exhaust valve, carefully read through the items of cautions for installation and maintenance listed below.

1. How to Read the Model No.

Model Number:

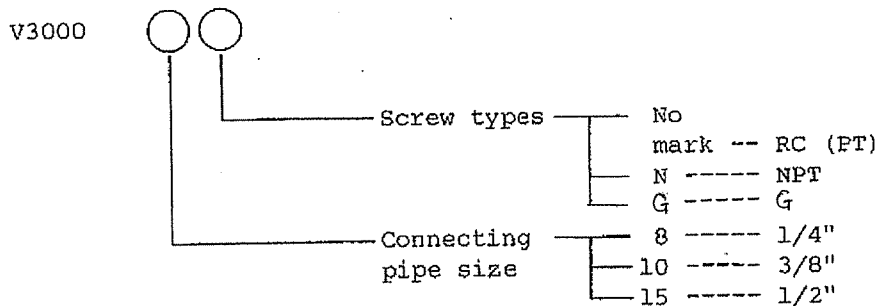

2. Cautions for Installation

- 2-1 See to it, at the time of installation, that the air flows in the direction of arrow mark on the plate cover (5) of the residual pressure exhaust valve.
- 2-2 Refrain from using the residual pressure exhaust valve connecting pipe with aperture (size) smaller than that of the air pipe.
- 2-3 Do not use the residual pressure exhaust valve at a place with the ambient temperature exceeding 60°C.
- 2-4 See to it that the operating pressure does not exceed 1.0 MPa .
- 2-5 Keep the space over 60 mm from under side of bottom plug (15) to enable removal of parts for overhaul.
- 2-6 Consult us separately in case of use under the atmosphere that spattering is produced.
- 2-7 Avoid use exposed to direct sun's ray.

3. Cautions for Maintenance

- 3-1 Air flows to the outlet side from the inlet side by positioning the knob (1) setting parallel to the air flow and the air at the outlet side flows out from the exhaust side by positioning the knob (1) setting right angle to the air flow.
- 3-2 The exhaust port is threaded with taper screw (RC3/8) for silencer mounting tube. This is only for silencer mounting use.
- 3-3 Do not apply more than 50 kg-cm torque to the exhaust port.
- 3-4 Should large amount of air leak, check the soft packings (9) and (10), mini Y packing (7) and O-ring (14) for damage. If they are scratched, replace them with new ones.
- 3-5 Disassembling procedure
 - a) Stop air supply to the residual pressure exhaust valve.
 - b) Remove the bottom plug (15) and then O-ring (14).
 - c) Remove the rod (2) to remove the knob (1) and cam (3). Then pull out the spool (8) from the bottom.

4. Expendable Parts List

NO	Part name	Drawing No.	Q'ty	Remarks
⑦	Spool ass'y	V3000-Spool	1	
⑧				
⑨				
⑩				

CSM-1004

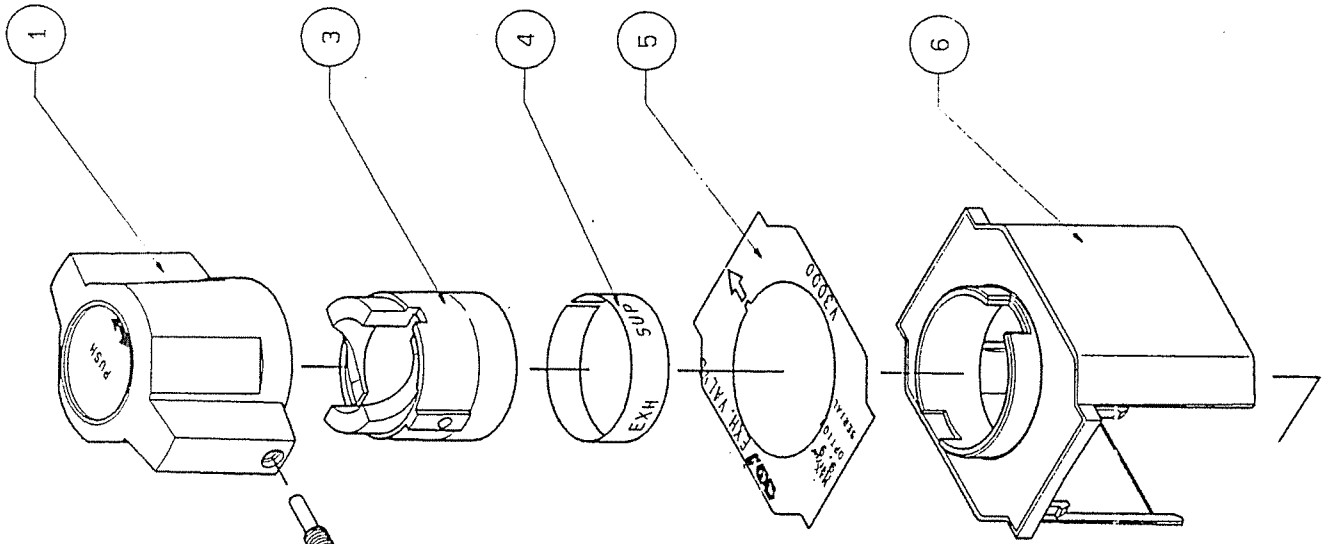

V3000

