

# Separated

- F.R.L.
- F.R.
- F (Filtr)
- R (Reg)
- L (Lub)
- Drain Separ
- Mech Press SW
- Res press exh valve
- SlowStart
- Anti-bac/Bac-remove Filt
- Film Resist FR
- Oil-ProhR
- Med Press FR
- No Cu/PTFE FRL
- Outdrs FRL
- Adapter Joiner Press Gauge
- CompFRL
- LgFRL
- PrecsR
- VacF/R
- Clean FR
- ElecPneuR
- AirBoost
- Speed Ctrl
- Silncr
- CheckV/other
- Fit/Tube
- Nozzle
- Air Unit
- PrecsCompn
- Electro Press SW
- ContactSW
- AirSens
- PresSW Cool
- Air Flo Sens/Ctrl
- WaterRtSens
- TotAirSys (Total Air)
- TotAirSys (Gamma)
- Gas generator
- RefrDry
- DesicDry
- HiPolymDry
- MainFiltr
- Dischrg etc
- Ending

## For air filter

Many options are available for the CKD air filter.  
When selecting the model No. of the air filter, carefully consider the environment in which the air filter is to be used.

If an option is required, order with an option code added at the end of the model No.  
(Example) If a metal bowl is installed onto the A1019-2C, specify A1019-2C-M.

## Bowl options table

Compatible model No.		A1019	1219
Option code	Blank	○	○
	D	○	
	Z	○	○
	DZ	○	
	M	○	○
	DM	○	

## How to order bowl assembly

**A1019 - BOWL - DM**

(A set of bowl assembly and O-ring for sealing)

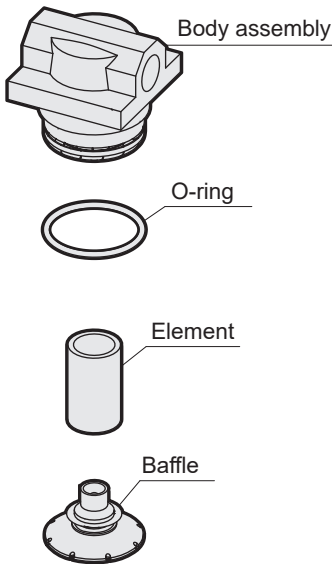

### Polycarbonate bowl

Do not use this product where the ambient temperature is high, or where organic solvents such as thinner or trichlene or chemicals are present in the atmosphere. A manual or auto-drain discharger is available for use according to the working conditions.

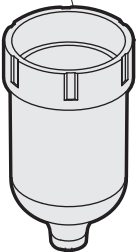

Blank  
Z  
Manual drain cock

### Metal bowl

Use a metal bowl where the ambient temperature is high, or where organic solvents such as thinner or trichlene or chemicals are present in the atmosphere.

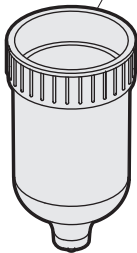

M  
Manual drain cock

### Nylon bowl

A nylon resin transparent green bowl can be used with some solvents or synthetic oils.  
A manual or auto-drain discharger is available for use according to the working conditions.

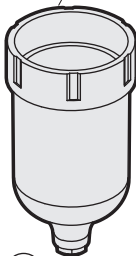

D  
DZ  
Piston drain type

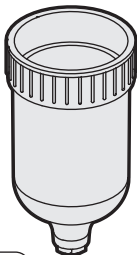

DM  
Piston drain type

## Regulator

Many options are available for CKD regulator.  
When selecting the regulator model No., select the product according to the working conditions of the regulator.

If an option is required, order with an option code added at the end of the model No.  
(Example) If a panel mount is installed onto the B2019-2C, specify 2001-2C-P.

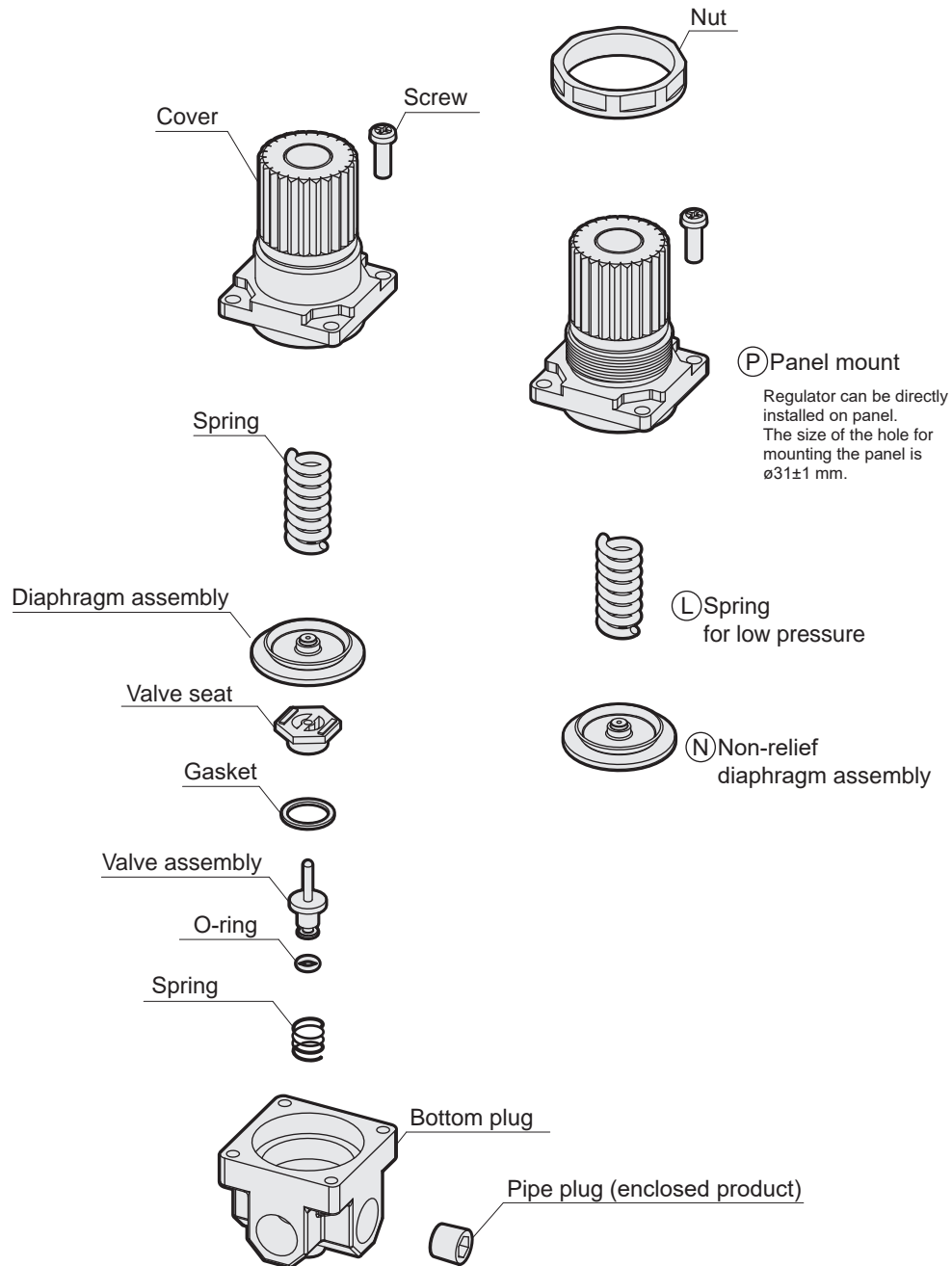

## Specifications

Model	Model No.	Pressure adjusting range
Regulator for low pressure	B2019-1/2C-L	0.02 to 0.34 MPa
	2419-1/2C-L	
Relief valve for low pressure	B6061-L	0.04 to 0.35 MPa

## Attached pressure gauge

Model	Attached pressure gauge	
	G	LG
B7019 2419	B2019 B6061	G49D-6-P10
		G49D-6-P04

F.R.L.
F.R.
F (Filtr)
R (Reg)
L (Lub)
Drain Separ
Mech Press SW
Res press exh valve
SlowStart
Anti-bac/Bac-remove Filt
Film Resist FR
Oil-ProhR
Med Press FR
No Cu/PTFE FRL
Outdrs FRL
Adapter Joiner Press Gauge
CompFRL
LgFRL
PrecsR
VacF/R
Clean FR
ElecPneuR
AirBoost
Speed Ctrl
Silncr
CheckV/other
Fit/Tube
Nozzle
Air Unit
PrecsCompn
Electro Press SW
ContactSW
AirSens
PresSW Cool
Air Flo Sens/Ctrl
WaterRISens
TotAirSys (Total Air)
TotAirSys (Gamma)
Gas generator
RefrDry
DesicDry
HiPolymDry
MainFiltr
Dischrg etc
Ending

# Separated

## F.R.L. For lubricator

**F.R.** Many options are available for CKD lubricator.  
**F (Filtr)** When selecting the model No. of lubricator, carefully consider the  
**R (Reg)** type of lubricant and working environment.

If an option is required, order with an option code added at the end of the model No.  
(Example) If a metal bowl is installed onto the A3019-2C, specify A3019-2C-M.

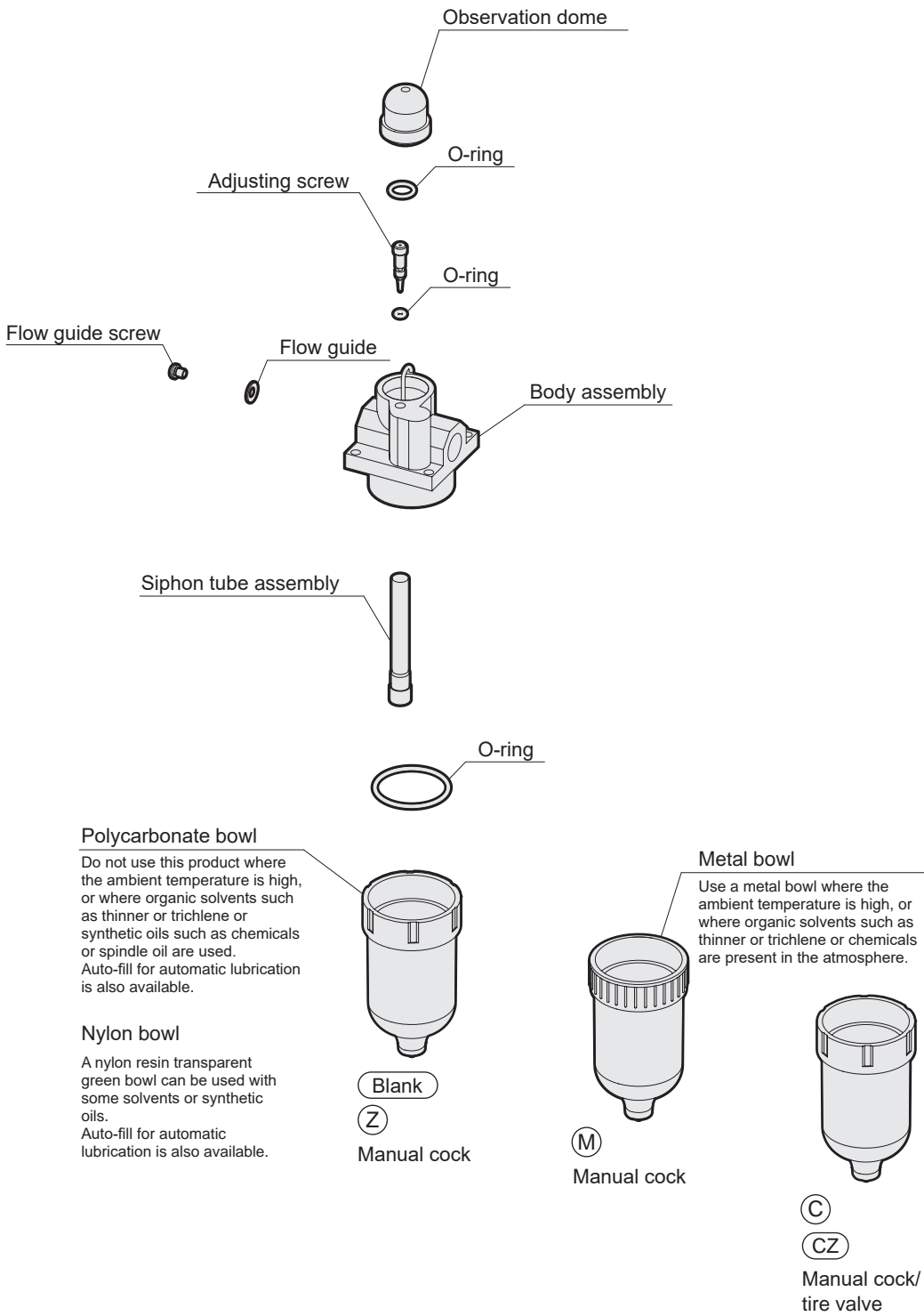

Bowl assembly and model No. table (set of bowl assembly and O-ring for sealing)

Compatible model	Polycarbonate resin bowl		Transparent nylon resin bowl		Metal bowl
	Blank	Manual cock	Blank	Manual cock	Manual cock
A3019	A3019-BOWL	A1019-BOWL	A3019-BOWL-Z	A1019-BOWL-Z	A1019-BOWL-M